

TUSCALOOSA COUNTY COMMISSION

MEETING

JUNE 3, 2009

TUSCALOOSA COUNTY §

STATE OF ALABAMA §

This being the date and hour to which the Tuscaloosa County Commission adjourned, the County Commission met pursuant to such adjournment with Probate Judge W. Hardy McCollum presiding as Chairman. The following members were present:

Don Wallace
Gary Youngblood
Bobby Miller
Reginald Murray

Commissioner Bobby Miller moved, seconded by Commissioner Don Wallace, the County Commission voted unanimously to authorize payment of \$31,896.00 to Burk-Kleinpeter, Inc. for design services on the Patriot Parkway Extension Project.

Exhibit 6-1, Page

Commissioner Reginald Murray moved, seconded by Commissioner Bobby Miller, the County Commission voted unanimously to award the following bids that were opened on May 20, 2009:

SPEED TABLE COMPONENTS
Traffic Logix

Exhibit 6-2, Page

STEEL PILING
Skyline Steel

Exhibit 6-3, Page **378**

Commissioner Bobby Miller moved, seconded by Commissioner Don Wallace, the County Commission voted unanimously to award the bid for Reinforcing Steel to O'Ferrell Rebar, Inc. The bids were opened May 6, 2009.

Commissioner Bobby Miller moved, seconded by Commissioner Don Wallace, the County Commission voted unanimously to refer the single bid received from Joe Money Machinery Co., Inc., for a Rubber Tire Roller, to the Engineering Department for evaluation and negotiation.

Exhibit 6-4, Page **379-382**

Commissioner Gary Youngblood moved, seconded by Commissioner Bobby Miller, the County Commission voted unanimously to authorize proposed Change Order No. 4, submitted by project engineer, McGiffert and Associates, LLC, involving a 45-calendar day extension for contractor, Tomlin Construction, LLC, on the Progress Drive Industrial Access Road Extension Project.

Exhibit 6-5, Page **383**

Commissioner Bobby Miller moved, seconded by Commissioner Reginald Murray, the County Commission voted unanimously to authorize the Amendment of the Professional Services Contract for project engineer, McGiffert and Associates, LLC, to increase the contract fees in the amount of \$40,827.00 on the Progress Drive Industrial Access Road Extension Project.

Exhibit 6-6, Page **384**

Commissioner Reginald Murray moved, seconded by Commissioner Bobby Miller, the County Commission voted unanimously to adopt a resolution accepting offer of settlement on Performance Bond obligations for Timber Lane Road and Timber Lane Road Phase II and Phase III.

Exhibit 6-7, Page **385-386**

Probate Judge W. Hardy McCollum read into the record and presented to a representative from the Tuscaloosa County Park and Recreation Authority, a proclamation to proclaim the month of June 2009 as "PARK AND RECREATION MONTH."

Commissioner Don Wallace moved, seconded by Commissioner Gary Youngblood, the County Commission voted unanimously to refer the bid for Outdoor Warning Sirens from Federal Signal, a single-source bidder, to EMA Director, David Hartin, for evaluation.

Exhibit 6-8, Page **387-392**

Commissioner Don Wallace moved, seconded by Commissioner Bobby Miller, the County Commission voted unanimously to authorize a request for waiver from Tuscaloosa County Subdivision Regulations for private access easement length for Gurganus - Lease Parcels Subdivision Plat.

Exhibit 6-9, Page **394-396**

Commissioner Bobby Miller moved, seconded by Commissioner Reginald Murray, the County Commission voted unanimously to authorize a request from GFC Construction Co., Inc., for a 42-calendar day extension of the contract time for the Southeast Middle School Access Road Project.

Exhibit 6-10, Page **397-398**

Commissioner Don Wallace moved, seconded by Commissioner Gary Youngblood, the County Commission voted unanimously to authorize a request from Tuscaloosa's One Place for driveway repair at 16212 Old Lock 15 Road.

Exhibit 6-11, Page 399-400

Commissioner Don Wallace presented a letter from a resident of Carolwood Subdivision regarding junk cars on property.

Exhibit 6-12, Page 401

Commissioner Gary Youngblood moved, seconded by Commissioner Don Wallace, the County Commission voted unanimously to post Hannah Creek Road "NO TRUCKS," Jim Walter Mines #7 to Milldale Road.

Commissioner Gary Youngblood moved, seconded by Commissioner Bobby Miller, the County Commission voted unanimously to post the following:

Hagler Coaling Road "35 MPH" from Police Jurisdiction (South) to Hagler Drive and "25 MPH" from Hagler Drive through the Town of Coaling.

Middle Coaling Road "NO TRUCKS" from U.S. 11 to Lower Coaling Road.

Lower Coaling Road "NO TRUCKS" from U.S. 11 to Hagler Coaling Road.

There being no further business to come before the Tuscaloosa County Commission, the meeting adjourned to Wednesday, June 17, 2009.

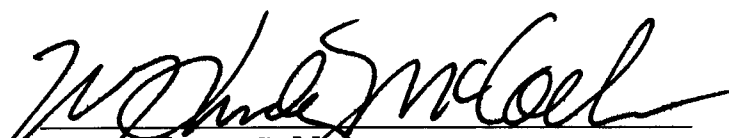

W. Hardy McCollum
Judge of Probate and Chairman
Tuscaloosa County Commission



Don Wallace
Commissioner - District I



Gary Youngblood
Commissioner - District II



Bobby Miller
Commissioner - District III

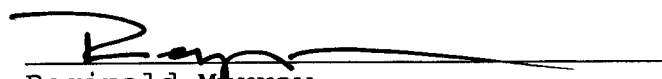

Reginald Murray
Commissioner - District IV

EX 6-1

CHAIRMAN OF THE BOARD
WM. R. "BIFF" BURK, III, PE

ASSOCIATE
BRUCE HIGGINBOTHAM, PE

WILLIAM R. BURK, JR., 1912-1986

BURK-KLEINPETER, INC.

ENGINEERS, ARCHITECTS, PLANNERS, ENVIRONMENTAL SCIENTISTS

600 LURLEEN WALLACE BOULEVARD, SUITE 180
TUSCALOOSA, AL 35401
TELEPHONE (205) 759-3221 FAX (205) 759-9166
WWW.BKIUSA.COM

PRESIDENT
GEORGE C. KLEINPETER, JR., PE

VICE PRESIDENT
O. JEFFREY WOOD, PE



OVER 95 YEARS OF SERVICE

April 30, 2009

Mr. Bobby Hagler
Tuscaloosa County Engineering Office
2810 35th Street
Tuscaloosa, Alabama 35401

Re: Patriot Parkway Extension
Invoice #14
BKI Job No. 3196

For professional services rendered on the referenced project through the month of April 2009.

PAYMENT REQUEST NO. 14

MAX FEE \$ 206,500.00

	<u>TOTAL AMOUNT</u>	<u>% COMPLETE</u>	<u>AMOUNT COMPLETE</u>	<u>CURRENT AMOUNT DUE</u>
DESIGN SERVICES	\$ 142,480.00	100%	\$142,480.00	\$ -
SURVEY	\$ 64,020.00	100%	63,624.00	-
TOTALS:			\$206,104.00	\$ -
ADDITIONAL SERVICES:	TOTAL AMOUNT	% COMPLETE	AMOUNT COMPLETE	CURRENT AMOUNT DUE
DESIGN:				
DESIGN	\$ 69,500.00	91%	\$62,996.00	\$ 31,896.00
SURVEY	\$ 40,315.00	0%	\$ -	\$ -
GEOTECHNICAL	\$ 42,350.00	0%	\$ -	\$ -
CONSTRUCTION ENGINEERING & INSPECTION:				
INSPECTION	\$ 153,000.00	0%	\$ -	\$ -
SURVEY	\$ 27,500.00	0%	\$ -	\$ -
ADMINISTRATION	\$ 15,500.00	0%	\$ -	\$ -
TESTING	\$ 55,000.00	0%	\$ -	\$ -
		TOTAL	\$62,996.00	\$ 31,896.00
		TOTALS:	\$269,100.00	
		LESS PREVIOUSLY INVOICED:	(237,204.00)	
		AMOUNT DUE THIS INVOICE:	\$ 31,896.00	

BKI Invoice: 46433
jc

5-18-09

EX 6-1

BID REMISSION SHEET**Speed Table Components****BIDS TO BE OPENED May 20, 2009 AT 9:00 AM**

COMPANY: Traffic Logix
 BY: Craig Timothy
 ADDRESS: 3 Harriet Lane
Spring Valley, NY 10977
 PHONE: 1-801-712-9000

Item	Number of Pieces	Bid per Piece	Cost
MSH 03	2,200	<u>68.37</u>	<u>\$150,414</u>
LSH 03	150	<u>131.27</u>	<u>19,691.15</u>
RSH 03	150	<u>131.27</u>	<u>\$19,691.15</u>
Total Bid			<u>\$189,796.29</u>

DELIVERY DATE: 30 days From approval.

BID REMISSION SHEET

12 and 14 INCH STEEL PILING BID

BIDS TO BE OPENED MAY 20, 2009 AT 9:00 AM

COMPANY: Skyline Steel LLC
BY: Greg Cashio
ADDRESS: 4908 Cahaba River Rd
Suite 200
Birmingham, AL 35243
PHONE: (205) 262-9909

BID PRICE: 37⁵⁰ CWT

DELIVERY DATE: June 9th 2009

**MINIMUM SPECIFICATIONS
PULL TYPE RUBBER TIRE ROLLER**

GENERAL:

The item described herein shall be completely assembled and adjusted and all equipment, standard and or optional, shall be installed and ready for use upon delivery. The item shall be completely and wholly fabricated and assembled and shall be of the manufacturer's latest model design. It is the intent of these specifications to set forth the minimum specifications, in accordance with manufacturer's standard published specifications for one (1) new pull type rubber tire roller. Any additions, deletions or variations from the following specifications must be stated and set forth in full. Tuscaloosa County reserves the right to reject any or all bids based on the best overall benefit to the County.

SERVICE AND WARRANTY:

The vendor shall furnish a standard manufacturer's service and warranty policy and shall pay any costs of inspection and adjustments that may be necessary in accordance with the warranty. It is essential that repair parts and service be adequate and available.

PARTS AND SERVICE MANUALS:

The vendor shall furnish parts books and service manuals with units on delivery.

MECHANICAL SPECIFICATIONS:

Overall Width	7' - 3" Minimum	88"
Overall Length	15' - 3" Minimum	170"
Overall Height	4'-0" Minimum	51"
Rolling Width - Front	6'-0" Minimum	} 88" TOTAL
Rolling Width - Rear	7'-0" Minimum	
Number Of Tires - Front	6	} 13 TOTAL
Number Of Tires - Rear	7	
Shipping Weight	3,700 lbs. Minimum	3,750 LBS
Maximum Gross Load	13 tons	29,750 LBS
Body Volume	114 cu. ft.	185 CU FT
Rolling Pressure per Inch Width Of Tire	355 lbs.	320 LBS
Towing Eye Diameter	3"	3"

*** NOTE: ALL SPECS ARE WITH 6 PLY TIRES.

**BID SUBMISSION SHEET FOR PULL TYPE ROLLER
READ CAREFULLY**

BIDS MADE OUT IN PENCIL WILL NOT BE ACCEPTED. Brand names, catalog numbers, etc. are used to indicate levels quality. If you are unable to furnish an item as specified and desire to offer a substitute, give full description of the item, including descriptive literature and/or manufacturer's specifications, along with any supplemental additional information necessary to compare the item bid with the requirements set forth in the bid form, or your bid may be rejected. Any attachment hereto is made and becomes a part of this inquiry and must be signed by bidder. No errors will be corrected after bids are opened. No prices shall include State or Federal Excise Taxes. Tax exemption certificates furnished upon request. County reserves the right to accept or reject all bids or any portion thereof to accommodate the best interest of the County

We agree to furnish the above at the prices shown and guarantee that each item offered will meet or exceed all specifications, conditions and requirements listed for same. I/We can make delivery within 90 day(s) if awarded the bid.

If you cannot furnish the item listed, please return this sheet ONLY marked "No Bid" and give information on reverse side for up-dating your listing in our records.

This Bid Must Be Notarized Below.

I hereby affirm I have not been in any agreement or collusion among bidders or prospective bidders in restraint of freedom of competition, by agreement to bid at a fixed price or to refrain from bidding, or otherwise.

Sworn to and subscribed before me this 20TH day of MAY 2009.

Sarah A. Hudson
Notary Public

FIRM JOE MONEY MACHINERY CO INC
Name

BY [Signature]
Signature Acceptable in Ink Only

MAILING ADDRESS PO BOX 997

CITY & STATE BIRMINGHAM AL 35201

PHONE NO 205-841-7000 / 800-292-3492

TERMS NET

DATE MAY 19, 2009

BID PRICE: \$34,955.00 - FERGUSON RT1300

Erguson

ROTOR TIRE ROLLERS

SPECIFICATIONS

	RT-900 9-WHEEL		RT-1100 11-WHEEL		RT-1300 13-WHEEL	
Overall Width	68"		83"		88"	
Overall Length with Tongue	170"		174"		170"	
Length without Tongue	128"		132"		128"	
Rolling Width	68"		83"		88"	
Overall Height	51"		51"		51"	
Wheelbase	98"		96"		98"	
Ballast Capacity, Level, Cu. Ft.	104		119		132	
Ballast Capacity, Heaped, Cu. Ft.	130		170		185	
Ballasted Weight Level, Lbs.	16,983		19,096		21,560	
Maximum Recommended Gross Wt., Lbs.	20,700		23,300		29,750	
Weight, Empty	2,950		3,630		3,750	
Tire Overlap	1/2"		1/2"		1/2"	
Number Tires in Front	4		5		6	
Number Tires in Rear	5		6		7	
Size of Tires	7.50 x 15		7.50 x 15		7.50 x 15	
	4-Ply	6-Ply	4-Ply	6-Ply	4-Ply	6-Ply
Tire Pressure, Maximum	36	55	36	55	36	55
Tire Capacity, Rated	2860	3740	2860	3740	2860	3740
Load per Tire, Level	1887	1887	1736	1736	1698	1658
Load per Tire, Heaped	2300	2300	2300	2300	2203	2203
Pressure P.S.I. — Tire Width Level	260	295	245	280	235	265
Pressure P.S.I. — Tire Width Heaped	310	335	310	335	300	320
Contact Area, Sq. In. Level	44.4	36.3	41.8	34.0	40.7	33.1
Contact Area, Sq. In. Heaped	51.7	41.8	51.7	41.8	50.5	41.2
Ground Pressure, P.S.I. Level	42.5	52.0	41.5	51.0	41.0	50.0
Ground Pressure, P.S.I. Heaped	44.5	55.0	44.5	55.0	43.5	53.5
Draw Bar Pull — Pounds:						
Level Ground — No Fill	360		440		520	
Add for each 1" of Fill	90		110		130	
Add for each 1% of Grade	180		225		270	
Tractor Size — H.P.	25-30		30-40		35-40	

Optional: 10, 12, and 14 Ply Tires with heavy duty wheels available. Tire data calculated from data supplied by tire manufacturers.

DISTRIBUTED BY

EX 6-4

EX 6-4

189 5300 ©

WARRANTY FERGUSON MANUFACTURING AND EQUIPMENT CO., INC.

Ferguson Manufacturing and Equipment Co., Inc., hereinafter referred to as "Ferguson," subject to the terms and conditions hereinafter stated, warrants each piece of new equipment manufactured by Ferguson and all parts manufactured by Ferguson and contained in that equipment for 12 months from the date first placed in service or for 1,000 hours of service, whichever shall occur first, but limited to 24 months from the date of shipment from Ferguson's factory. This warranty extends only to the original user purchaser of the new equipment.

During the term of the warranty as defined above, Ferguson will replace, f.o.b. its factory at no charge, any part manufactured by Ferguson having defects in materials or workmanship including installation costs and transportation expense of those involved in the installation of such parts. Ferguson will make no allowance for repairs or alterations to such equipment or such parts or for parts purchased from others unless authorized in writing by Ferguson.

This warranty shall cease to exist upon (1) the making of unauthorized repairs or alterations, the non-use or removal of safety devices provided with the equipment or the use of parts purchased from others, (2) improper operation, (3) operation in a manner exceeding operating limitations or capabilities, (4) abuse, misuse, negligence or accident, and in any event, (5) upon the expiration of 12 months or 1,000 hours of service, whichever shall occur first, from the date first placed in service or upon expiration of 24 months from the date of shipment from Ferguson's factory.

Ferguson warrants any engines, pumps, motors, parts, accessories or subassemblies not manufactured by Ferguson but furnished with or constituting a part of the new equipment sold by Ferguson only to the extent of the original manufacturer's applicable warranty.

Except for the warranties expressly and specifically made herein, Ferguson makes no other warranties, express or implied, and disclaims all other implied warranties of merchantability or of fitness for a particular purpose. Further, Ferguson disclaims any liability for loss of profits, incidental or consequential damages or contingent liabilities arising out of failure of any piece of equipment or parts to operate properly.

No person is authorized to change the terms, scope, limitations or disclaimers of this instrument or to assume any additional obligation on Ferguson's behalf unless made in writing and signed by an officer of Ferguson.

**FERGUSON MANUFACTURING
AND EQUIPMENT CO., INC.**
Dallas, Texas

CHANGE ORDER

No. 4

PROJECT: Tuscaloosa County Commission Progress Drive Phase II Roadway Construction Project Project No. IAR-063-000-020	DATE OF ISSUANCE: 5-28-09
OWNER: Tuscaloosa County Commission 2501 7 th Street, Suite 300 Tuscaloosa, AL 35401	
CONTRACTOR: Tomlin Construction, LLC 641 Lum Fife Road Gordo, AL 35466	ENGINEER: MCGIFFERT AND ASSOCIATES, LLC P.O. BOX 20559 TUSCALOOSA, AL 35402

You are directed to make the following changes in the Contract Documents.

See Page 2 of 2.

CHANGE IN CONTRACT PRICE:	CHANGE IN CONTRACT TIME:
Original Contract Price \$ <u>2,465,759.38</u>	Original Contract Time <u>210 Consecutive Calendar</u> days
Previous Change Orders No. to No. <u>1</u> to No. <u>3</u> \$ <u>(154,624.02)</u>	Net change from previous Change Orders <u>None</u>
Contract Price prior to this Change Order \$ <u>2,311,135.36</u>	Contract Time Prior to this Change Order <u>272 Consecutive Calendar</u> days
Net Increase (decrease) of this Change Order \$ <u>-0-</u>	Net Increase (decrease) of this Change Order <u>45 Consecutive Calendar</u> days
Contract Price with all approved Change Orders \$ <u>2,311,135.36</u>	Contract Time with all approved Change Orders <u>317 Consecutive Calendar</u> days

RECOMMENDED:
MCGIFFERT AND ASSOCIATES, LLC

APPROVED:
TUSCALOOSA COUNTY COMMISSION

APPROVED:
Tomlin Construction, LLC

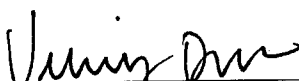
by 
Engineer

by 
Owner

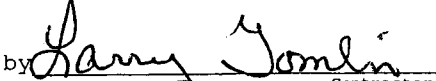
by 
Contractor

APPROVED:
AL DEPARTMENT OF TRANSPORTATION

Contract time has been increased by 45 consecutive calendar days as a result of lost time due to rain and wet conditions. The resulting total contract time is 317 consecutive calendar days. The date of completion of all work is therefore July 1, 2009.

EX 6-5



Site Design

May 28, 2009

Utility Design

Tuscaloosa County Commission
 Attn: Mr. Farrington Snipes
 2501 7th Street, Suite 300
 Tuscaloosa, AL 35401

Re: Progress Drive Phase II
 Roadway Construction Project

Transportation

Dear Farrington:

Please find attached herewith Change Order Request Number Four which requests an additional forty-five (45) calendar days to the construction contract with Tomlin Construction, Inc.

Environmental

In addition, per our recent phone conversation, we respectfully request that our professional services contract be amended to include additional fees for Construction Observation, Construction Layout, and ADEM Stormwater Permit Monitoring in association with the construction contract extensions with the project. Please note that to date, the construction contract has been extended a total of 62 days, for which we have not requested additional fees for our services. At this time the contractor is requesting and additional 45 calendar days to complete the project, which equates to a total of 107 additional days. As you are aware, the contract extensions have been necessary to offset delays caused by inclement weather, weather recovery days, and the like. Please find tabulated below a summary of our projected amended fee amounts.

Surveying

Construction Contract Administration

<u>Construction Observation (Article C.2.03.A.1.a)</u>		
Construction Technician II (Reg), 350 hours @ \$72.00		\$ 25,200.00
Construction Technician II (OT), 60 hours @ \$88.00		\$ 5,280.00
		<u>\$ 30,480.00</u>

<u>Construction Layout (Article C.2.03.A.1.b)</u>		
Field Survey Crew, 55 hours @ \$147.00		\$ 8,085.00

<u>ADEM Stormwater Permit Monitoring (Article C.2.09.A.1.e)</u>		
Project Manager/Principal Engineer III, 7 hours @ \$110.00		\$ 770.00
Engineer Technician II, 20 hours @ \$65.00		\$ 1,300.00
Clerical, 4 hours @ \$48.00		<u>\$ 192.00</u>
		\$ 2,262.00

2814 Stillman Boulevard
 Tuscaloosa, AL 35401

 Post Office Box 20559
 Tuscaloosa, AL 35402

 Telephone 205.759.1521
 Fax 205.759.1524

 www.mcgiffert.com

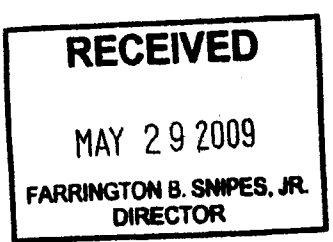

If there is additional information I can provide, please advise.

Yours truly,
 McGIFFERT AND ASSOCIATES, LLC

Jimmy Duncan
 Jimmy Duncan, PE, PLS, LEED AP

EX 6-6

TUSCALOOSA COUNTY COMMISSION
TUSCALOOSA COUNTY, ALABAMA

**RESOLUTION ACCEPTING OFFER OF SETTLEMENT ON PERFORMANCE BOND
OBLIGATIONS, RELEASING PRINCIPAL AND SURETY ON THE SAME, AND
ADOPTING THE SUBDIVISIONS AND PUBLIC STREETS THEREIN FOR
MAINTENANCE**

WHEREAS, the Tuscaloosa County Commission requires that all developers of proposed subdivisions file and post a reasonable surety bond ("Performance Bond") to guarantee the actual construction and installation of public improvements comply with the approved plans therefor, (§ 11-24-2, Code of Alabama) and

WHEREAS, Performance Bonds were posted by the developer of those proposed subdivisions known as Timber Lane Road, and Timber Lane Road Phase II and Phase III to guarantee that said developments would comply with all applicable requirements, those bonds being in the amounts of Thirty Thousand Dollars (\$30,000) and Thirty Four Thousand Six Hundred and Twenty-Five Dollars (\$34,625) respectively, and

WHEREAS, the developer, Terry Beverly, has since filed for bankruptcy protection and has given the County Engineer advance-notice that it will not be able to complete the subdivision improvements as required by law, therefore making it doubtful that the developer will complete the required performance or be able to reimburse the County therefor, and

WHEREAS, the County Engineer, The Cincinnati Insurance Company (as Surety), and attorneys for both have negotiated a reasonable settlement opportunity whereby Tuscaloosa County would accept payment in full of both bonds, for a total of Sixty Four Thousand Six Hundred and Twenty-Five Dollars (\$64,625), and in exchange would fully release both Surety and Principal from any and all further obligations associated with the named subdivisions,

NOW, THEREFORE, BE IT RESOLVED BY THE TUSCALOOSA COUNTY COMMISSION as follows:

That pursuant to § 11-3-11(a)(9), Code of Alabama, the County Commission hereby agrees to settle the above-stated claims or rights that it has against the Principal and Surety for performance of the obligations under bond, and assents to the full release of both in exchange for payment of the full amount posted under the bond, and that the Attorney for the Tuscaloosa County Commission has the express authority to execute any and all documents or instruments necessary to achieve the same.

That in light of the instant circumstances, and in furtherance of the County's desire to provide public improvements of a certain quality to residents of subdivisions located in the County, the County Commission hereby adopts the public streets and other public improvements located in the above-named subdivisions for the necessary completion and future maintenance.

BE IT FURTHER RESOLVED that the Chairman of the County Commission be, and he hereby is, authorized to file a copy of this resolution, duly certified as correct by the County Clerk of Tuscaloosa County, the officer in charge of the records of said County, in the Probate Court of Tuscaloosa County, Alabama.

This the 3rd day of June, 2009.

ATTEST:



W. Hardy McCollum, Chairman
Tuscaloosa County Commission

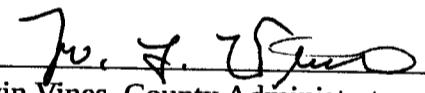

Melvin Vines, County Administrator

Bidder's Company Name, Address and contact information

Federal Signal Corp.

P. O. Box 619

Woodstock, GA 30188

Siren Manufacturer's Name & Address

Federal Signal Corp.

2645 Federal Signal Dr.

University Park, IL 60466-3195

Required Bid items

Electro-mechanical 130 dBC Tone-Only Siren per bid Specifications	\$13,927.40
Installation of Siren, per Manufacturer's Specifications	\$ 6,160.00

Submitted by:

Signed

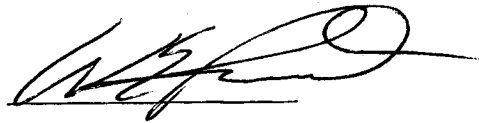

Printed/typed Name

W. E. (Bill) Plant

Title

Manufacturer's Representative

Date

June 1, 2009

EX 6-8



FEDERAL SIGNAL CORPORATION

Federal Warning Systems

June 1, 2009

W. M. Lamb, Chief financial Officer
County Commission
Tuscaloosa County Alabama
P.O. Box 20113
714 Greensboro AV.
Tuscaloosa, AL 35402-0113

RE: Sealed Bid "Outdoor Warning Siren"

Dear Mr. Lamb:

Federal Signal Corp. and EDNSystems appreciate the opportunity to submit this bid to Tuscaloosa County, AL. for new Tornado Warning Sirens.

Federal Signal Corporation (FSC) is the oldest and largest worldwide supplier of emergency warning systems. FSC has been manufacturing outdoor warning devices since 1915 and **Federal Signal has been certified as an ISO 9001 Quality System manufacturer since 2000.** FSC has supplied over 70% of all sirens currently operating in the United States.

After reviewing your specifications, it has been determined that this enclosed Bid Response meets or exceeds the intent of Tuscaloosa County's required specifications. Review of the Bid Specification indicates the County's intent to purchased one (1) or more AC/Battery operated, Rotating Sirens producing 130dB(C) @ 100 Ft. with a minimum two (2) year warranty controlled by a Two-way activation decoder.

We have **exceeded the County's minimum specification** by offering a siren that produces a certified **130dBc @ 100 Ft.** and offers a **full five (5) year warranty** on the siren and rotator motor.

We also noticed that the bid calls for a radio activated system utilizing Two-Tone, DTMF and FSK encoding with Federal Signal's two-way radio communication that includes remote status reporting. We have quoted a two-way radio control utilizing Federal Signal Digital control format. This is the system that Tuscaloosa County currently uses and will not require any additional Master Control equipment to be installed at the base station to receive and interpret status reporting information. This will also eliminate the operator from having to active the sirens from two separate control points, all activations will still be originated from a single control point. All of our controllers can decode two-tone sequential, DTMF and Federal Signal Digital Formats simultaneously.

Federal Signal's proposed siren will also operate from a combination of 208-220-240VAC and 48VDC battery back-up. The proposed siren will operate from a 48VDC battery system. **Do not confuse electronic BATTERY OPERATED sirens with a true battery backed-up siren system.** The 2001 siren can also operate from an optional Solar Power source only.

Enclosed you will find the Original bid Document, and equipment specifications sheets

We look forward to working with Tuscaloosa County on this worthwhile project. If you have any further questions or need additional discussion on this matter please feel free to contact me on 770-924-1266.

Sincerely,
EDNSystems

W. E. (Bill) Plant
Manufacturer's Representative
Federal Signal Corp.



RAPIDREACH

W. E. (Bill) Plant

Manufacturer's Representative

From the First Alert To Disaster To Recovery

Emergency Dispatch Notification Systems

P. O. Box 619 ♦ Woodstock, GA 30188

♦ Phone 770-924-1266 ♦ Fax 770-926-3788

E-mail billplant@ednsystems.com ♦ www.ednsystems.com

EDNSystems • P. O. Box 619 • Woodstock, Ga. 30188 • Phone 779-924-1266 • Fax 770-926-3788

• e-mail billplant@endystems.com • www.ednsystems.com

2001 SIREN

The 2001-130 Siren is a high power, rotating, uni-directional siren that offers an anechoic certified signal strength of 130 dB(C) +/- 1 dB(C) at 100 feet. The high decibel output provides maximum coverage with minimum installation cost. Radio activation can further minimize installation costs by eliminating the need for leased dedicated control lines.

The siren's projector produces a 60 degree projection of sound which rotates at 3 RPM and can produce three signals options: Steady, Wail, and Fast Wail. The 2001-130 Siren will supply a minimum of 15 minutes of full power output from its batteries after AC power loss. The siren controls are available with battery operation, AC operation, and AC operation with battery back-up; One-way and Two-way radio control or landline.

Ideally suited to provide warning for hazardous weather conditions, fires, floods, chemical spills, and other types of emergencies, the 2001 Siren is a perfect choice to protect any community.

130 dB(C) OUTPUT

**DIRECTIONAL, ROTATING SIREN
FOR MAXIMUM COVERAGE**

**THREE DISTINCT WARNING
SIGNALS**

**FULL BATTERY OPERATION OR
BATTERY BACK-UP**

**MAINTENANCE-FREE SEALED
BEARING MOTORS**

WEATHER RESISTANT COATING

5 YEAR LIMITED WARRANTY

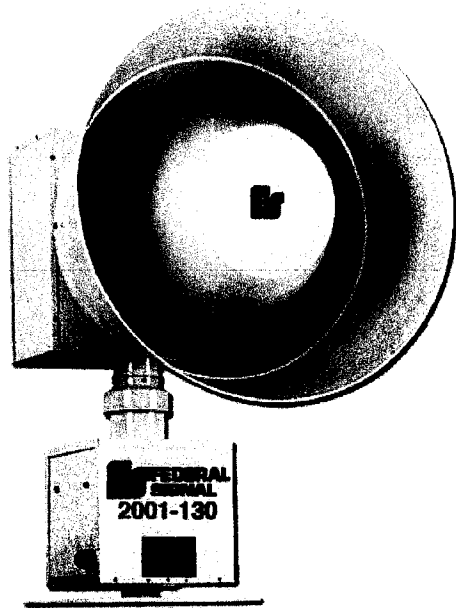

 **FEDERAL SIGNAL CORPORATION**
Federal Warning Systems

“ARE YOU PREPARED?”

EX 6-8

DCFCTB DC Two-Way Digital Controller for 2001 & Eclipse Siren Series

> Features

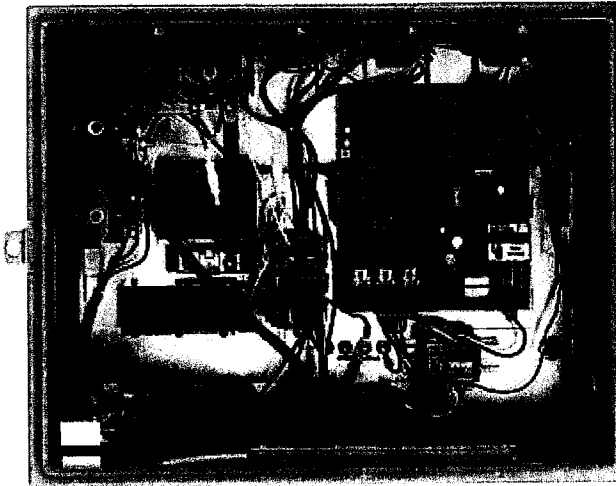

Two-way siren controller for 48VDC sirens

Two-way radio control and status monitoring

FSK two-way signaling format

Simultaneous single tone, two-tone sequential, DTMF decoding and optional EAS

Push buttons for local activation

UL Listed for general signaling

The Federal Signal DCFCTB is a two-way, battery-operated status monitoring siren controller for use with the Federal Signal 2001-130 siren and Eclipse siren series. The controller interfaces with an off-the-shelf two-way radio transceiver and communicates to the base control via FSK signaling. In addition to FSK, the controllers will simultaneously decode any combination of single-tone, two-tone sequential, DTMF or optional EAS formats for activation. This makes the two-way controller compatible with virtually any existing siren control system.

All DCFCTB models come equipped with two (2) independent relay outputs that can be programmed to activate with various codes. There are four (4) landline inputs and four (4) local push buttons for activation, plus cancel. Activation codes, relay timing, and optional warning sounds are programmed into the unit through a standard RS232 serial port or over-the-air from the central control point.

The DCFCTB offers six (6) user programmable functions in addition to the five pre-set functions: arm, disarm, report, growl test and master reset. The controller includes the necessary sensors and wiring to supply information on the following areas of operation: AC power status, communications status, low battery status, intrusion, siren activation current and siren rotation.



2001 SPECIFICATIONS

POWER REQUIREMENTS*

Siren Motor: 48V (DC or full wave rectified AC) 110 amps. (nom.)
 Rotator Motor: 48V (DC or full wave rectified AC) 1 amps. (nom.)

WIRING

Siren Motor: 2 AWG
 Rotator Motor: 12 AWG

MOTOR TYPE

Siren: Series Wound DC 6 Hp
 Rotator: Permanent Magnet DC 1/8 Hp

SIGNAL INFORMATION

Signal	Frequency Range	Sweep Rate
STEADY	795 Hz	N.A.
WAIL	470-705 Hz	10 sec.
FAST WAIL	600-705 Hz	3.5 sec.

Signal Duration: 3min. std. (programmable)
 Signal Output (SPL): 130 dB(C) +/- 1 dB(C) at 100' (30.5 m)
 Effective Range at 70dB(C): 6200ft
 Rotation: 3 RPM

DIMENSIONS

Height x Width x Depth: 55" x 37" x 41"
 140cm x 94cm x 10cm

WEIGHT

Shipping Weight: 450 lbs. (205 kg)

OPERATING TEMPERATURE

-30°C to +60°C**

* Power requirements refer to the power supplied by the batteries or optional AC operation through 2001TRB

** The siren can operate throughout this temperature range provided that battery temperature is maintained at -18°C or higher.

ORDER INFORMATION*

2001-130 Rotating Electro-mechanical Siren
 130 dB(C) +/- 1dB(C), 48v DC, Pole Mount

Included

2001AC¹ AC operated motor control, 208 or 220/240v AC (specify voltage)
 NEMA 3R control cabinet, two 48v DC contactors and transformer/rectifier, 182 lbs. 53 kg

2001DC^{1,2} 120v AC motor control, NEMA4 control cabinet, four chargers, two 48v DC contactors and NEMA 3R battery cabinet. 224 lbs. 102 kg

*2001-130 Siren requires a Federal Controller such as FC or DFCEB (See Controller Product Literature)

¹For use with Electro-mechanical sirens. Antenna and cable are not included with any radio activation control and must be purchased separately. (See your FWS Representative).

²Batteries not included. Four Delco Voyager Model M24MF required.

Landline Option

2001HR Rotator Holding Relay for use with external timer

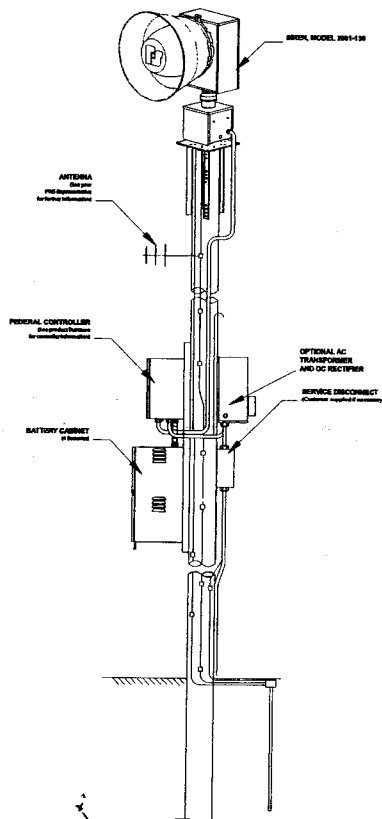

FEDERAL SIGNAL CORPORATION
 Federal Warning Systems
 2645 Federal Signal Drive, University Park, IL 60466-3195
 Sales: 800/548-7229 • Fax: 708/534-4855
 Visit us at www.federalwarningsystems.com



> Specifications

Electrical	
AC supply voltage	120 VAC @ 4.0 amps
Current Draw	+/- 10%, 50/60 Hz, maximum standby current
Power Supply	6A @ 13.3v DC
Battery Backup	48v DC (Four model #M24MF Delco Voyagers required)
Current Draw	< .2 amps in standby
Serial Ports	
Serial Port Protocol	RS232C 1200, N, 8, 1
Transceiver	
Programmable Frequency	Power Out and Private Line options. For further details consult the Motorola product Manual.
Signaling Format	
FSK	1200 baud, MSK modem type Useable decode sensitivity: 12dB SINAD (min.)
DTMF	3-12 standard DTMF characters
Two-Tone Sequential	
Frequency Range	282 Hz - 3000 Hz (non-CTCSS) 400 Hz - 3000 Hz (CTCSS)
Tone Timing	.5 sec - .25 sec min., 8 sec max
Intertone Gap	400ms (maximum)
Tone Accuracy	+/- 1.5%
Tone Spacing	5.0% preferred, 3% min.
Single Tone	
Frequency Range	282 Hz - 3000 Hz
Tone Timing	0.5 sec - 8 sec maximum
Tone Accuracy	+/- 1.5%
Tone Spacing	5.0% preferred, 3% min.
Relay Outputs	
4 relay outputs	SPST
Contact Rating	(2 relays standard, 4 relays Max.) 5A @ 28v DC 5A @ 240v AC
Audio Output	
Output Voltage	>2V Peak to Peak
Maximum Load	8 Ohms
Total Harmonic Distortion	<10% @ 1kHz Sinewave
Environmental	
Operating Temperature	-30°C to 65°C

Controller Dimensions	
HxWxD	62.5" x 23.5" x 16.94" 1588mm x 597mm x 430mm NEMA 4X Rated
Battery Cabinet Dimensions	
HxWxD	18" x 28" x 15.19" 457mm x 711mm x 386mm Vented NEMA 4X Rated
Shipping Weight	
Approx. Shipping Weight	300 lbs. (136.36 kg)
Actual Weight	234 lbs. (106.3 kg)
2001TR: AC Primary Operation	
Operating Voltage	208/220/240 VAC single phase
Current Requirements	30 Amps. (approx.)
Dimensions	23" x 11" x 10" (584mm x 279mm x 254mm)
Weight	150 lbs. (68.2 kg)
Order information	
DCFCTB(D) ^{1,2}	Two-way Federal Controller
DCFCTB(D)H ^{1,2}	Two-way Federal Controller, high band 136-174 MHz
DCFCTB(D)U ^{1,2}	Two-way Federal Controller, UHF band 450-470 MHz
DCFCTB(D)-IP ^{1,3}	IP-enabled two-way electro-mechanical controller
Options	
FSPWARE	Federal Programming Software (Non-Digital Applications)
SFCDWARE	Federal Commander Digital Software (See literature for details)
Q-DC-IP ^{1,3}	Retrofit kit to upgrade existing controller to IP
EAS	Origination, activation and location codes

(D) Indicates digital Federal Controller two-way

¹ For use with 2001-130 and Eclipse siren series.

² Antenna and cable are not included with radio activation control and must be ordered separately.

³ Broadband radio and Codespear software sold separately.

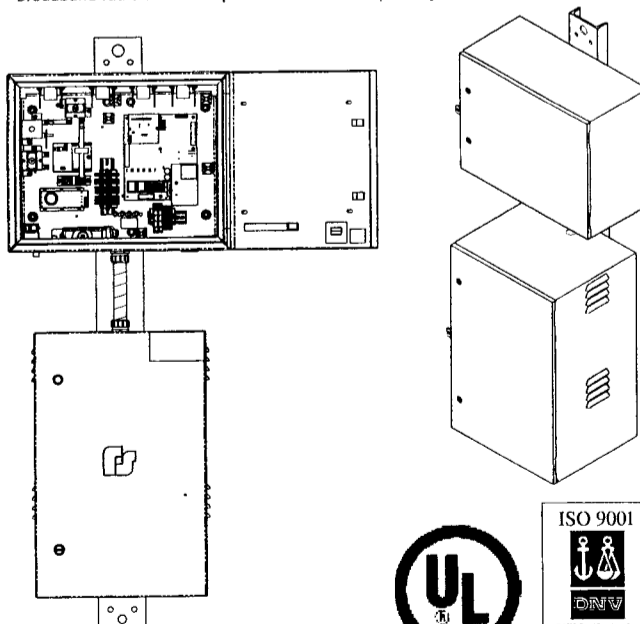

FEDERAL SIGNAL
Public Safety Systems

2645 Federal Signal Drive, University Park, IL 60466-3195
800.548.7229 • federalwarningsystems.com
For more public safety information, visit federalsignal.com/publicsafety



TUSCALOOSA COUNTY PUBLIC WORKS DEPARTMENT
2810 35th Street
Tuscaloosa, Alabama 35401
(205) 345-6600
FAX (205) 345-6600



Bobby C. Hagler
County Engineer



Allan D. Springer, Sr.
Assistant County Engineer

Subdivision Waiver Request
Tuscaloosa County Commission
(for June 3, 2009)

Gurganus – Lease Parcels Subdivision Plat

Commission District: 1

Developer: James Milton Gurganus and Robbie Sue Gurganus

Engineer: Herndon, Hicks and Associates, Inc

Waiver Requested: Requesting a waiver for the private access easement length (1306.24')

Rule 5-4-12(b)(2) states in regard to Private Access Easements, “... **that such easement shall not be greater than twelve hundred (1200) feet in length.**”

Date Plat(s) Recorded: Not recorded

Comments:

Because of the length of the proposed easement is only a 106.24' longer than the allowable distance, there is no adverse affect to the adjacent properties or traffic issues, therefore, the recommendation is that this waiver request be approved.

EX 6-9

EX 6-9



HERNDON, HICKS AND ASSOCIATES, INC.

2728 Lurleen Wallace Blvd.
P.O. Box 508
Northport, Alabama 35476
205/333-0003 • FAX 205/333-0178

205 East Washington Street
P.O. Box 447
Demopolis, Alabama 36732
334/289-3020

May 15, 2009

Tuscaloosa County Commission
Tuscaloosa, Alabama 35401

RE: Gurganus – Lease Parcels Easement

To Whom It May Concern:

We would like to request a waiver of length of easement on the above referenced plat. The length of the private easement is 1306.29 feet. This property is also located in the planning jurisdiction of the City of Tuscaloosa. Area requirement is not more than 2,000 feet. Please place us on the next available meeting date.

Sincerely,

Martin M. Montgomery, PLS

cc: Bobby Hagler, Tuscaloosa County Engineer

Professional Surveyors

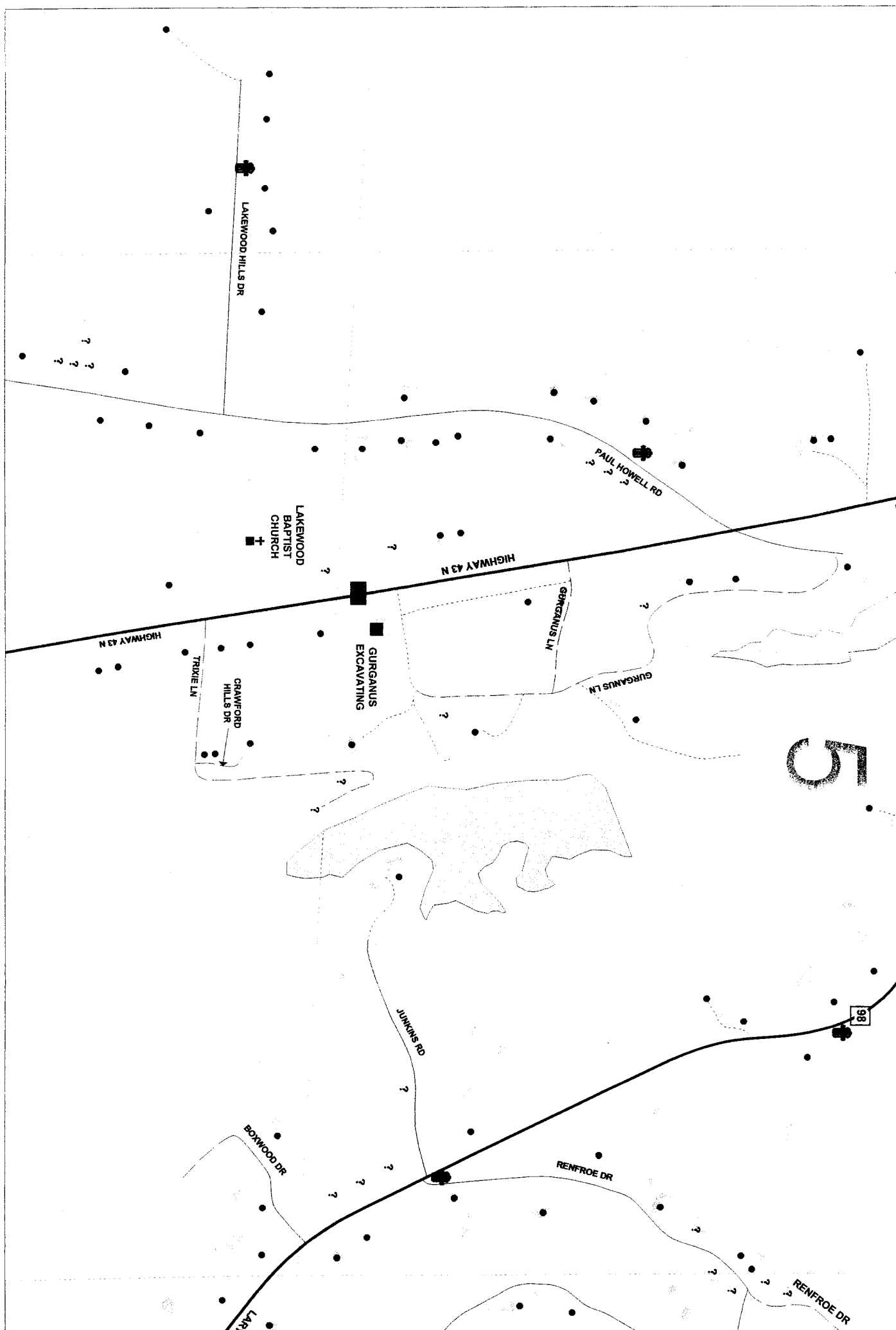



Almon Associates, Inc.
P.O. Drawer 2729
Tuscaloosa, AL 35403

May 26, 2009

2008 12th Street
Tuscaloosa, AL 35401

Mr. Bobby Hagler
County Engineer
Tuscaloosa County, Alabama
2810 35th Street
Tuscaloosa, Alabama 35402

phone: 205.349.2100
fax: 205.349.2107
web: www.almonassociates.com

Attn: Mr. Allan Springer

RE: Southeast Middle School Access Road and Realignment of Bear Creek Road

Dear Mr. Hagler,

Please find attached a letter from GFC Construction requesting additional contract time for the above referenced project. As you know, the contract time officially expired on May 25th, 2009. Their letter references a number of proposed reasons for an overall project delay. The following is a summary of their reasons, requested time, and our comments.

- 1) Utility conflict delays at the beginning of the project:
GFC had an intermediate deadline of August 1st to complete work on Bear Creek Road, and provide access to the newly constructed school. This deadline was met despite the referenced delays.
- 2) Delayed Alabama Department of Transportation ROW permit:
The US-82 ROW permit was approved later than expected. The contract documents special provision number 1.5 stated that the approval would not take longer than 180 days from the date of the notice to proceed. The notice to proceed was issued on April 30th, 2008. The permit was approved on November 12th, 2008. The time actually required to obtain approval was 196 Calendar Days. The difference is only 16 calendar days, not 2 ½ months as cited in the letter.
- 3) Inclement weather:
The months of February, March and May of 2009 have all had rainfall amounts in excess of 150% of the respective month's average. Mr. Burkhalter has counted 57 days that they were unable to work due to rain. This time does not include weekends or holidays, but is actual days of work that were missed.

GFC Construction has requested a minimum time extension of 42 calendar days. I have discussed this with Mr. Burkhalter and he has expressed to me that they are committed to completing the project within a 42 calendar day extension. After reviewing the letter and giving due consideration to all of the items listed, we recommend a one-time 42 calendar day extension. If this extension is granted by Tuscaloosa County, then the revised contract time will end on July 6th, 2009. It is understood that GFC Construction will complete the project by this date, and that no further extension will be requested. If you have any questions or need additional information, please let me know.

Sincerely,
Almon Associates, Inc.

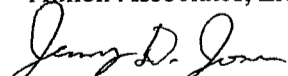
Jeremy D. Jones, P.E.
Associate

CIVIL ENGINEERING
ENVIRONMENTAL
STRUCTURAL DESIGN
SURVEYING & MAPPING
TRANSPORTATION
WATER RESOURCES

Cc: Mr. Johnny Free (GFC Construction)

F:\Job Files\2006\06168.21 SE Middle School Road\Correspondance\let_bobby_hagler_time_extension.docx

EX 6-10

EX 6-10

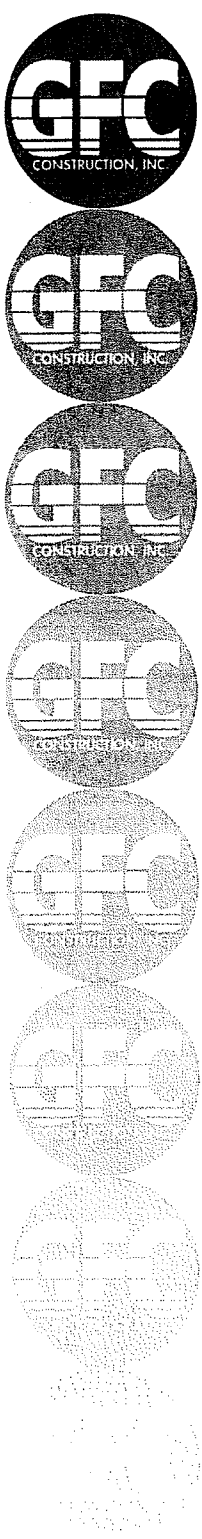

May 21, 2009

Mr. Jeremy D. Jones, PE
Almon Associates, Inc.
2008 12th Street
Tuscaloosa, Alabama 35401

Dear Jeremy,

With this letter we are requesting additional days for the completion of the Southeast Middle School Access Road we encountered 57 that it was raining or too wet to work. We also lost 12 days of good weather during the initial reconstruction of Bear Creek Road due to AT&T lines not being relocated to a location that would have allowed us to complete the initial phase of the project ahead of schedule as we originally planned. This has impacted the project from the initial stages to date. We also had to relocate the Waterlines along Bear Creek Road during this period of construction and this also impacted our overall schedule in a negative way. We also lost a significant period of time during the completion of the project due to the inability to obtain an ALDOT Permit to work on the Right-of-Way of Highway 82. We lost from Mid September 2008 to Mid November 2008 waiting on the permit to complete any work on Highway 82.

We are requesting at least 42 days to complete the project. We have completed most of the work except for the turn lane on Highway 82, Permanent Striping and Permanent Signage.

Please contact me with any questions or comments.

Respectfully,

Paul Burkhalter, PE & LS
Project Manager

MAY-20-2009 13:32 From:

To: 205 758 0247

P.2/2

*Teresa Costanzo
Executive Director*

*Bob McKinney
Assistant Director*

tuscaloosa's One place

A FAMILY RESOURCE CENTER

870 Redmont Drive Post Office Box 40764 Tuscaloosa, AL 35404
Phone 205-462-1000 Fax 205-462-1001 www.etfrc.org

*Board of Directors
Kim Thoma-Bailey, Chair*

Tonya Adams-Nelson

Carla Bailey

Avanti Baker

Elizabeth Beemer

Steven Case

Mary Bath Cavert

Leslie Guy

Robert Hall, Jr.

Rick Herbert

Helena Hibbard

Pamela Hisey

Tom Ledbetter

Debra Nelson-Gardall

Sandra Ray

Mike Russell

Tammy Yager

*Ex-Officio Member:
Judy Young*

May 20, 2009

To: Judge Hardy McCollum
Bobby Miller, County Commissioner

Subject: Inaccessible/Hazardous County Road Access to a Client's Home

Client: Cora Turner
16212 Old Lock 15 Road
Tuscaloosa, AL 35406

Dear Mr. Miller:

Tuscaloosa's One Place received a letter from Dr. Scott Fulgham from Internal Medicine on behalf of his patient, Cora Turner. Ms. Turner has multiple health problems, including significant heart disease.

Ms. Turner has been experiencing some issues with her driveway. The patient and her family have been concerned about access for vehicles as well as ambulance transport in an emergency situation. I visited her home, and the driveway was deplorable. I was not able to access her driveway and had to walk in the mud to get to her house.

The indigent client receives \$700.00 per month. She is unable financially to repair her driveway. Please take this into consideration for issuing some help and/or repairs to her driveway.

Respectfully,

Shirley Mims, BSW
Shirley Mims, BSW
Family Support Specialist

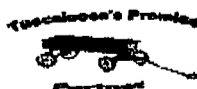

EX 6-11

EV 6-1

GEORGE P. MILLER, M.D., F.A.C.P.
JOHN P. SUMMERFORD, M.D., F.A.C.P.
ROSS B. VAUGHN, M.D., F.A.C.P.
LEONARD W. JONES, III, M.D.
SCOTT R. FULGHAM, M.D.
JOHN F. BURNUM, M.D. M.A.C.P. (1922-2005)
MAXWELL MOODY, JR., M.D., EMERITUS
OMER A. BAKER, M.D., EMERITUS

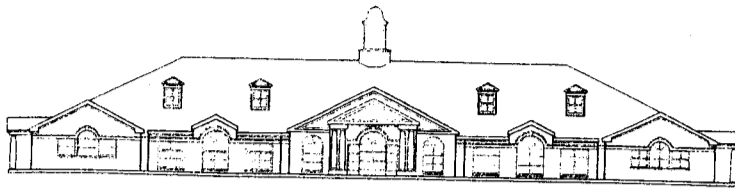

TUSKALOOSA INTERNAL MEDICINE, LLC

1100 RUBY TYLER PARKWAY
TUSCALOOSA, AL 35404
205-759-2582
FAX 205-759-2985
OR 205-759-1404

April 08, 2009

Ms. Cora L. Turner
16212 Old Lock 15 Road
Tuscaloosa, Alabama 35406

Dear Mr. Road Commissioner:

This letter is on behalf of Cora Turner who has been my patient for many years here at Tuskaloosa Internal Medicine. She has been having some issues with her driveway. The patient and family have been concerned about access to vehicles and ambulance transport vehicles in an emergency situation. She has multiple medical problems including significant heart disease. She has been admitted fairly emergently several times over the past five to six years. Please take this into consideration for issuing some help and or repair of her driveway, which apparently is in disrepair according to the family.

I appreciate your concern in this matter and please do not hesitate to call me if I can provide any further information.

Sincerely,

A handwritten signature in black ink, appearing to read 'SRF' with a stylized flourish.

Scott R. Fulgham, M.D.
SRF/rhb

COL Thomas Newsome
13601 Date Street
Northport, AL. 35475
(205) 394-3915

23 April 2009

SUBJECT: OLD JUNK CARS ON PROPERTY

Tuscaloosa County District Representative:

The Residents of the Carroll wood Subdivision has great concerns with the property at **13571 Date Street**. The property owner has **old junk cars** on auto stanchion, which has been in place for over **four years**. His property is littered with **old junk tires** and other clutter.

I left the owner a note on 4 April 2009 about addressing the issues due to all the children in the neighborhood out playing. There is a **great RISK** of someone becoming injured.

We as residents of the Date Street would encourage you to drive by and review the property. The property location is off HWY 43N on Mitt Larry Rd the first entrance on the left and the second house on the right.

The residents of Date Street would greatly appreciate any assistance you maybe able to provide.

V/r
COL Thomas Newsome
E-mail newsomet@rocketmail.com

EX 6-12