

TUSCALOOSA COUNTY COMMISSION
MEETING
MARCH 19, 2014

TUSCALOOSA COUNTY §
STATE OF ALABAMA §

This being the date and hour to which the Tuscaloosa County Commission adjourned, the County Commission met pursuant to such adjournment with Probate Judge W. Hardy McCollum presiding as Chairman. The following members were present:

Stan Acker
Jerry Tingle
Bobby Miller
Reginald Murray

Commissioner Jerry Tingle moved, seconded by Commissioner Bobby Miller, the County Commission voted unanimously to authorize payment to the City of Tuscaloosa in the amount of \$12,322.67 for costs associated with the waterline relocation on the Crescent Ridge Road resurfacing project.

Commissioner Bobby Miller moved, seconded by Commissioner Reginald Murray, the County Commission voted unanimously to authorize payment of invoices to:

Almon Associates:
 Malone Creek Road Bridge over Malone Mill Creek
 bridge replacement project \$7,400.00
 Traweek Road over Binion Creek bridge replacement
 project \$6,440.00
Burk-Kleinpeter, Inc.:
 Watermelon Road/Union Chapel Road intersection
 upgrade project \$23,000.00
McGiffert and Associates, LLC:
 Dry Creek Road waterline relocation/drainage
 project \$9,706.50

Sentell Engineering, Inc.:
Fosters Ferry Road widening project \$24,318.00
Sand Road milling and resurfacing project \$1,950.00
Exhibit 3-1, Pages

Commissioner Jerry Tingle moved, seconded by Commissioner Stan Acker, the County Commission voted unanimously to authorize amendments to the engineering contracts with Almon Associates. These amendments are required as a result of project revisions by ALDOT.

Traweek Road over Binion Creek bridge replacement
- Addition of \$18,600.00
Malone Creek Road over Malone Mill Creek
- Addition of \$13,200.00
Dobbs Road over Thornton Creek bridge replacement
- Addition of \$33,300.00
Exhibit 3-2, Pages

Commissioner Stan Acker moved, seconded by Commissioner Bobby Miller, the County Commission voted unanimously to accept the bid for Herbicide application from Edko, LLC, in the amount of \$248,048.08, pending review and recommendation from the Engineering Department.

Exhibit 3-3, Pages

Commissioner Bobby Miller moved, seconded by Commissioner Reginald Murray, the County Commission voted unanimously to accept the recommendation by the County Engineer to award the bid for one (1) Dozer that was opened on March 17, 2014, as follows:

Warrior Tractor and Equipment Company
Exhibit 3-4, Pages

Commissioner Bobby Miller moved, seconded by Commissioner Jerry Tingle, the County Commission voted unanimously to reject and rebid the bids submitted on Motor Graders that were opened on February 26, 2014. The lowest bidder, Thompson Tractor, did not fully met specifications as set by the Engineering Department.

Exhibit 3-5, Pages

Commissioner Bobby Miller moved, seconded by Commissioner Jerry Tingle, the County Commission voted unanimously to adopt a resolution approving and accepting a preliminary plat submission for Riverbend Woods Subdivision.

Exhibit 3-6, Page

Commissioner Reginald Murray moved, seconded by Commissioner Bobby Miller, the County Commission voted unanimously to adopt a resolution approving and accepting a preliminary plat submission for GSI Properties Subdivision, Resurvey of Lots 9-11.

Exhibit 3-7, Page

Commissioner Stan Acker moved, seconded by Commissioner Jerry Tingle, the County Commission voted unanimously to adopt a resolution approving and accepting a preliminary plat submission for Pinion Estates, Phase 2.

Exhibit 3-8, Page

Commissioner Reginald Murray moved, seconded by Commissioner Bobby Miller, the County Commission voted unanimously to authorize Planning Director Farrington Snipes to submit an application for the Transportation Alternative Program 80/20 Grant through ALDOT and authorize McGiffert and Associates, LLC, to perform the engineering work on the Palmore Park, Fosters Ferry Road, Joe Mallisham Parkway, U.S. Highway 11, Oakdale School project. The grant maximum is \$400,000 with minimum of 20% matching funds plus the design for the project and the application preparation.

Commissioner Reginald Murray moved, seconded by Commissioner Bobby Miller, the County Commission voted unanimously to approve the 60th Avenue Drainage Study contract fee proposal from Almon Associates in the amount of \$14,600.00.

Commissioner Bobby Miller moved, seconded by Commissioner Jerry Tingle, the County Commission voted unanimously to approve the contract for design and preparation of construction documents on the 2013 Transportation Alternatives Program Grant

Professional Services Contract for the Tuscaloosa County Hazard Mitigation Plan and award the contract to LEHE Planning, LLC, for an amount not to exceed \$29,000.00 which will be paid through a grant from the State EMA.

Commissioner Stan Acker moved, seconded by Commissioner Reginald Murray, the County Commission voted unanimously to approve funding for the Smithsonian Travel Exhibit presented at the Northport Heritage Museum in the amount of \$5,000.00 and the funds be administered through the City of Northport.

Commissioner Stan Acker moved, seconded by Commissioner Bobby Miller, the County Commission voted unanimously to authorize the Engineering Department to post stop signs at the intersection of Stonehedge Road and Freeman's Bend Road creating an "All Way Stop."

Commissioner Jerry Tingle moved, seconded by Commissioner Stan Acker, the County Commission voted unanimously for the funds left over from the \$12,000.00 approved by the Commission for concrete and site work for the storm shelter for the Town of Coaling be used for handicap access and electrical work.

Commissioner Jerry Tingle moved, seconded by Commissioner Stan Acker, the County Commission voted unanimously to authorize \$200,000 from the \$1.5 million approved for purchase of land in districts 2 and 4 to be used for purchasing Bama Rock Garden Property (59.04 acres). The purchase of this property is subject to a survey and examination to ensure the original Bama Rock Garden property lies within the boundaries of the survey.

Commissioner Jerry Tingle moved, seconded by Commissioner Bobby Miller, to add Hidden Springs Drive, Gulf Drive, and Lake Retreat Drive to County Road Maintenance. After discussion, Commissioner Tingle withdrew the motion, until the following Commission meeting, pending review of the drives by the Engineering Department.

Commissioner Jerry Tingle moved, seconded by Commissioner Reginald Murray, the County Commission voted to enter into a

50/50 Participation Project with the City of Tuscaloosa to complete the drive, a parking lot, lighting and restrooms for Hurricane Creek Park. Total funding from the County General Fund will be \$200,000.00.

Commissioner Bobby Miller moved, seconded by Commissioner Jerry Tingle, to add Delta Drive to County Road Maintenance. After discussion, Commissioner Miller withdrew the motion, until the following Commission meeting, pending review of the drive by the Engineering Department.

The Commission retired into Executive Session.

Following Executive Session, Chairman W. Hardy McCollum called the Commission back to order.

Upon request by County Attorney, Robert Spence, and upon motion by Commissioner Stan Acker, seconded by Commissioner Jerry Tingle, the County Commission voted unanimously for County Engineer, Bobby Hagler, to accept payment in the amount of \$18,000 from the bonding company for Oak Creek Subdivision Phase I and apply the funds to road repairs.

Commissioner Jerry Tingle moved, seconded by Commissioner Stan Acker, the County Commission voted unanimously to appoint Tim Davis to the Community Corrections Board, at the request of the University of Alabama, due to the resignation of Dr. Tim Hebson.

Exhibit 3-12, Page

Upon request by County Attorney, Robert Spence, and upon motion by Commissioner Stan Acker, seconded by Commissioner Jerry Tingle, the County Commission voted unanimously to waive all fines associated with Morgans Landing subdivision and the violation of Subdivision Regulations for advertising lots for sale before approval of the plat. The developer removed all advertisements associated with the subdivision.

There being no further business to come before the Tuscaloosa County Commission, the meeting adjourned to Wednesday, April 2, 2014.

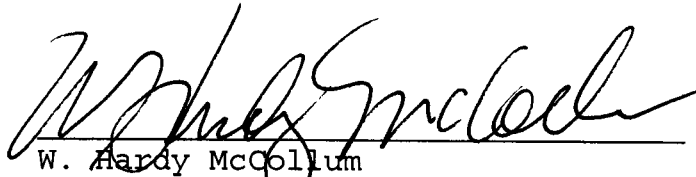

W. Hardy McCollum
Judge of Probate and Chairman
Tuscaloosa County Commission



Stan Acker
Commissioner - District I

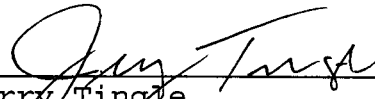

Jerry Tingle
Commissioner - District II

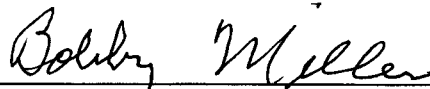

Bobby Miller
Commissioner - District III



Reginald Murray
Commissioner - District IV



PO Drawer 2729
 Tuscaloosa, AL 35403
 205-349-2100

Tuscaloosa County Department of Public Works
 2810 35th St.
 Tuscaloosa, AL 35401

Invoice number 00008
 Date 02/28/2014

Project 2012131 TUSCALOOSA COUNTY
 MALONE CREEK ROAD BRIDGE OVER
 MALONE MILL CREEK

Professional Services provided from February 1, 2014 through February 28, 2014

Invoice Summary

Description	Contract Amount	Prior Billed	Total Billed	Current Billed
Survey				
Deign Topographic Survey	5,200.00	5,200.00	5,200.00	0.00
Property Survey, Tract Sketches and Legal Descriptions	2,850.00	285.00	285.00	0.00
Additional Topographic Survey, if roadway realignment is required	1,850.00	0.00	0.00	0.00
Subtotal	9,900.00	5,485.00	5,485.00	0.00
Structural				
Bridge Structural Design	37,000.00	7,400.00	14,800.00	7,400.00
Transportation				
Roadway Geometry and Approach Plans	18,500.00	13,690.00	13,690.00	0.00
Categorical Exclusion Preparation Services	3,500.00	0.00	0.00	0.00
Utility Coordination Services	1,200.00	0.00	0.00	0.00
Geotechnical Engineering	21,300.00	0.00	0.00	0.00
Additional Geotech, if 3 span brige is required	3,700.00	0.00	0.00	0.00
Subtotal	48,200.00	13,690.00	13,690.00	0.00
Total	95,100.00	26,575.00	33,975.00	7,400.00

RECEIVED

FEB 28 2014

TUSCALOOSA COUNTY
 PUBLIC WORKS DEPARTMENT

Tuscaloosa County Department of Public Works
Project 2012131 TUSCALOOSA COUNTY MALONE CREEK ROAD BRIDGE OVER MALONE MILL CREEK

Invoice number 00008
Date 02/28/2014

Invoice total 7,400.00

Aging Summary

Invoice Number	Invoice Date	Outstanding	Current	Over 30	Over 60	Over 90	Over 120
00008	02/28/2014	7,400.00	7,400.00				
	Total	7,400.00	7,400.00	0.00	0.00	0.00	0.00

Approved by:

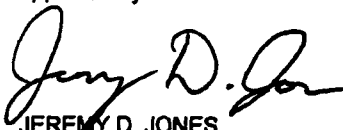

JEREMY D. JONES

Associate

ACCOUNTS ARE DUE AND PAYABLE UPON RECEIPT OF INVOICE. ACCOUNTS NOT PAID IN FULL WILL BE ASSESSED A FINANCE CHARGE OF 1 ½ PERCENT PER MONTH BEGINNING 30 DAYS FROM DATE OF INVOICE, UNLESS STATED OTHERWISE IN OUR CONTRACT.



PO Drawer 2729
 Tuscaloosa, AL 35403
 205-349-2100

Tuscaloosa County Department of Public Works
 2810 35th St.
 Tuscaloosa, AL 35401

Invoice number 00008
 Date 02/28/2014

Project 2012309 TUSCALOOSA COUNTY
 TRAWEEK ROAD BRIDGE OVER BINION
 CREEK REPLACEMENT

Professional Services provided from February 1, 2014 through February 28, 2014

Invoice Summary

Description	Contract Amount	Prior Billed	Total Billed	Current Billed
Survey				
Deign Topographic Survey	4,200.00	4,200.00	4,200.00	0.00
Property Survey, Tract Sketches and Legal Descriptions	2,850.00	285.00	285.00	0.00
Subtotal	7,050.00	4,485.00	4,485.00	0.00
Structural				
Bridge Structural Design	37,000.00	3,700.00	9,250.00	5,550.00
Transportation				
Roadway Geometry and Approach Plans	17,800.00	13,350.00	14,240.00	890.00
Categorical Exclusion Preparation Services (Removed by Ammendment 1)	0.00	0.00	0.00	0.00
Utility Coordination Services	1,900.00	0.00	0.00	0.00
Subtotal	19,700.00	13,350.00	14,240.00	890.00
Geotechnical Engineering				
Original Contract - Single Span Bridge	18,400.00	0.00	0.00	0.00
Original Contract - additional for 3 span brige	3,700.00	0.00	0.00	0.00
Approach Borings (Added by Ammendment 1)	2,860.00	0.00	0.00	0.00
Subtotal	24,960.00	0.00	0.00	0.00
Total	88,710.00	21,535.00	27,975.00	6,440.00

Tuscaloosa County Department of Public Works

Project 2012308 TUSCALOOSA COUNTY TRAWEEK ROAD BRIDGE OVER BINON CREEK REPLACEMENT

Invoice number 00008
Date 02/28/2014

Invoice total 6,440.00

Aging Summary

Invoice Number	Invoice Date	Outstanding	Current	Over 30	Over 60	Over 90	Over 120
00008	02/28/2014	6,440.00	6,440.00				
	Total	6,440.00	6,440.00	0.00	0.00	0.00	0.00

Approved by:

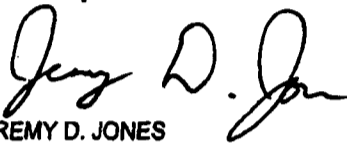

JEREMY D. JONES
Associate

ACCOUNTS ARE DUE AND PAYABLE UPON RECEIPT OF INVOICE. ACCOUNTS NOT PAID IN FULL WILL BE ASSESSED A FINANCE CHARGE OF 1 ½ PERCENT PER MONTH BEGINNING 30 DAYS FROM DATE OF INVOICE, UNLESS STATED OTHERWISE IN OUR CONTRACT.

BURK-KLEINPETER, INC.
ENGINEERS, ARCHITECTS, PLANNERS, ENVIRONMENTAL SCIENTISTS

CHAIRMAN OF THE BOARD
WM. R. "BIFF" BURK, III, PE

ASSOCIATES
DAVID S. HARGROVE, PE
CRAIG P. WILLIAMS, PE

WILLIAM R. BURK, JR., 1912-1986

600 LURLEEN WALLACE BLVD, SUITE 180
TUSCALOOSA, AL 35401-9166
TELEPHONE (205) 759-3221 FAX (205) 759-9166
WWW.BKIUSA.COM



OVER 100 YEARS OF SERVICE

PRESIDENT
GEORGE C. KLEINPETER, JR., PE

REGIONAL VICE PRESIDENT - AL
O. JEFFREY WOOD, PE

VICE PRESIDENT
BRUCE L. HIGGINBOTHAM, PE

January 31, 2014

Bobby Hagler
Tuscaloosa County Engineer
2810 35th Street
Tuscaloosa, AL 35401

RE: Watermelon Rd/Union Chapel Intersection
Client Number 252
Invoice # 1
BKI Job No. Tu.14.001

For professional services rendered on the referenced project through the month of January 2014.

PAYMENT REQUEST NO.1

	<u>TOTAL AMOUNT</u>	<u>% COMPLETE</u>	<u>AMOUNT COMPLETE</u>	<u>CURRENT AMOUNT DUE</u>
ENVIRONMENTAL IMPACT ANALYSIS	\$12,500.00	28%	\$ 3,500.00	\$ 3,500.00
DESIGN SERVICES	\$61,295.00	8%	\$ 5,000.00	\$ 5,000.00
SURVEY SERVICES	\$20,000.00	73%	\$ 14,500.00	\$ 14,500.00
GEOTECHNICAL SERVICES	\$ 6,300.00	0%	\$ -	\$ -
	<u>\$100,095.00</u>		<u>\$23,000.00</u>	<u>\$23,000.00</u>

PREVIOUSLY INVOICED: \$ -
AMOUNT DUE: \$ 23,000.00

RECEIVED

BKI INVOICE: 54008
ks

TUSCALOOSA COUNTY
PUBLIC WORKS DEPARTMENT



BATON ROUGE • NEW ORLEANS • SHREVEPORT • MOBILE

TUSCALOOSA • BIRMINGHAM • OCEAN SPRINGS • JACKSON



NUMBER	DATE	PROJECT NUMBER	APPROVED
4	3/10/2014	123025	DAT
			WAC

REMIT PAYMENT TO:
McGiffert AND ASSOCIATES LLC
P.O. BOX 20559
TUSCALOOSA, AL 35402-0559

Work Completed 1/27/14 Thru 3/2/14

Tuscaloosa County Commission
714 Greensboro Avenue
Tuscaloosa, AL 35401

Attn: Mr. Allan Springer

Re: Dry Creek Road Water Main Relocation

Description	Hours	Rate	Amount
• Resident Observation Services			
Construction Technician	88.50	\$ 94.00	\$ 8,319.00
• Construction Contract Management			
Senior Project Manager/Principal	9.25	\$ 150.00	\$ 1,387.50
Total Amount Due \$			9,706.50

K:\wpdata\Bills\201402- February 2014\TCC-Dry Creek Rd.xls

ACCOUNTS ARE DUE AND PAYABLE ON RECEIPT OF STATEMENT. ACCOUNTS NOT PAID IN FULL WILL BE ASSESSED A FINANCE CHARGE OF 1 1/2% PER MONTH BEGINNING 30 DAYS FROM DATE OF STATEMENT.

Sentell Engineering

Sentell Engineering Inc
P O Box 1246
Tuscaloosa, AL 35403

(205)752-5564
ssentell@sentell.net

Date	Invoice No.
03/13/2014	13-130
Terms	Due Date
Due on receipt	03/13/2014

Bill To
Tuscaloosa County Commission c/o Katherine Cross 2810 35th Street Tuscaloosa, AL 35401

Activity	Amount
• RE: Foster's Ferry Road Widening • TCP Project: TCP-63-16-13 • Surveying Services (50% Complete)	24,318.00
Total	\$24,318.00

Accounts Not Paid in Full are Subject to a Finance Charge of 1.5%/Month or 18% Annual Fee

Sentell Engineering, Inc.

Sentell Engineering Inc
P O Box 1246
Tuscaloosa, AL 35403

(205)752-5564
ssentell@sentell.net

Date	Invoice No.
03/13/2014	13-132
Terms	Due Date
Due on receipt	03/13/2014

Bill To
Tuscaloosa County Commission c/o Katherine Cross 2810 35th Street Tuscaloosa, AL 35401

Activity	Amount
• Sand Road Milling & Resurfacing • TCP Project: TCP-63-17-13 • Surveying Services (75% Complete)	1,950.00
Total	\$1,950.00

Accounts Not Paid in Full are Subject to a Finance Charge of 1.5%/Month or 18% Annual Fee



Almon Associates, Inc.
P.O. Drawer 2729
Tuscaloosa, AL 35403

2008 12th Street
Tuscaloosa, AL 35401

phone: 205.349.2100
fax: 205.349.2107

web: www.almonassociates.com

March 6, 2014

Mr. Bobby Hagler, P.E.
Tuscaloosa County Public Works
2810 35th St.
Tuscaloosa, Al 35401

Re: Contract amendment for: Almon Contract 2012-309,
TCP 63-11-12, Traweek Road Bridge over Binion Creek

Dear Mr. Hagler,

We are writing to request adjustments to our engineering contract to correspond with changes required by the Alabama Department of Transportation (ALDOT) on the above referenced bridge project. The Hydraulic Analysis performed by ALDOT shows that the bridge geometry required is significantly higher and longer than is currently provided for by our current scope of services. The additional height and length of the bridge necessitates that the roadway shift horizontally in order to avoid filling the wetlands and the stream channel adjacent to the roadway approach. I have attached a small drawing showing the creek layout as well as the proposed roadway approach layout that avoids said channel. In addition, the re-alignment requires a superelevation transition in the bridge in order to meet a 35MPH design speed. We reviewed this alignment as well as other alternatives with the Tuscaloosa County Engineering Staff and determined this alignment and design speed is the most desirable of the alternatives evaluated. With the additional length of the bridge, the additional complexity of the super elevation transition in the bridge, and the required realignment of the roadway, we respectfully ask that you consider the following additions to the scope and corresponding fees for our contract.

Additional Geotechnical Engineering:

Our current contract scope is based on a three span bridge replacing the existing bridge in approximately the same location as the existing bridge. The increase to a six span bridge may require additional soil borings. It is our understanding that the ALDOT materials section typically requires a soil boring at each bent; however, they will allow a reduction from that number if uniform soil conditions are present. Based on our discussions with TTL, Inc., we assume that the soil conditions at this location will be uniform. If the soil borings confirm this assumption, we will be able to drill the same number of locations that was originally included in our contract. If, however, the soil boring data refutes our assumption, we will be required to collect the additional borings. TTL, Inc. will be providing this service for us. We therefore request that our contract scope of services be amended to incorporate the attached Proposal from TTL, Inc. dated February 14, 2014, and to add an optional Lump Sum contract fee amount of \$7,000 for additional soil borings, in the event of non-uniform conditions. We will not proceed with the additional borings without prior approval of the county engineer.

CIVIL ENGINEERING

SITE DESIGN • ENVIRONMENTAL • STRUCTURAL DESIGN • SURVEYING • MAPPING • TRANSPORTATION • WATER RESOURCES

Additional Roadway Approach Engineering:

Our current contract does not include roadway realignment design. We request to amend our scope of services to include evaluation of alternate roadway alignments for an additional fee of \$4,600.00.

Additional Bridge Structural Engineering:

Our current contract scope of services under the bridge structural engineering is for a three span AASHTO Girder Bridge in a tangent section with a constant elevation. The required realignment still provides for a tangent section across the bridge, but the proximity of the curve requires that the superelevation transition extend onto the bridge. We request to add to the scope of services to increase the bridge to six spans, and to add detailed design for the superelevation transition as shown on the attached drawing. We request an additional compensation of \$7,000.00 under bridge structural engineering to correspond with the increased complexity in the scope.

In summary, the contract fee adjustments are as follows:

Lump Sum Fees:

	<u>Current Contract</u>	<u>Additional Fee</u>	<u>Total</u>
1) Design Topographic Survey	\$ 4,200.00	\$ 0.00	\$ 4,200.00
2) Property Survey, Tract Sketches and Legal Descriptions	\$ 2,850.00	\$ 0.00	\$ 2,850.00
3) Geotechnical Engineering			
a. Foundation Report	\$ 24,960.00	\$ 0.00	\$ 24,960.00
b. Additional Boring, if non- uniform soil conditions exist	\$ 0.00	\$ 7,000.00	\$ 7,000.00
4) Engineering Design and Construction Plans			
a. Roadway Geometry and Approach Plans	\$ 17,800.00	\$ 4,600.00	\$ 22,400.00
b. Bridge Structural	\$ 37,000.00	\$ 7,000.00	\$ 44,000.00
	<u>\$ 86,810.00</u>	<u>\$ 18,600.00</u>	<u>\$ 105,410.00</u>

Hourly Rate Fees:

Utility Coordination Services	\$ 1,900.00	\$ 0.00	\$ 1,900.00
-------------------------------	-------------	---------	-------------

Please let us know if you have any questions or need additional information.

Sincerely;
Almon Associates, Inc.

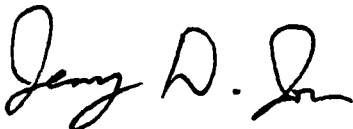

Jeremy D. Jones, P.E.
Associate

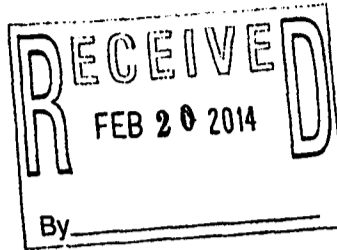

TTL
3516 Greensboro Avenue
Tuscaloosa, AL 35401
205.345.0816
www.ttlusa.com

February 14, 2014

Mr. Jeremy Jones, P.E.
Almon Associates, Inc.
2008 12th Street
Tuscaloosa, AL 35401

**RE: Proposal for Bridge Foundation Report
Bridge Replacement on Traweek Road over Binlon Creek
Tuscaloosa County, Alabama
Tuscaloosa County Project No. TCP 63-11-12
TTL Proposal No. P01114018**

Dear Mr. Jones:

TTL, Inc. (TTL) is pleased to submit this proposal for a bridge foundation report on the above-referenced project. The work performed under this proposal will be in accordance with the following documents.

- ALDOT Procedure 390
- ALDOT Procedure 398
- Checklist and Guidelines for Review of Geotechnical Reports prepared by the Federal Highway Administration (FHWA)

PROJECT INFORMATION

The project consists of replacing the existing bridge over Binlon Creek on Traweek Road in northern Tuscaloosa County. Our previous proposal dated November 19, 2012, and included as Attachment D in Contract for Professional Services between Almon Associates, Inc. and Tuscaloosa County dated November 27, 2012, was based on a bridge replacement project in the preliminary design phase.

Since the time of our proposal and addendum, the project design has been revised. TTL has been provided with an updated layout and profile for the replacement bridge and approaches. We understand the replacement bridge will be a two-lane, six-span AASHTO girder bridge with individual span lengths of 40 feet based on the hydraulic review. It is our understanding that this project will be partially funded through the Alabama Transportation Rehabilitation and Improvement Program (ATRIP). Since the bridge is an AASHTO girder bridge, our work for the replacement bridge will be performed in general accordance with ALDOT-398 Procedure for Conducting Subsurface Investigation and Foundation Reports and our conversations with the ALDOT State Geotechnical Engineer. Revisions to the design of the approaches include realignment of the bridge approaches on both the east and west ends of the bridge. Our work for the bridge approaches will be performed in general accordance with ALDOT-390 Procedure for Conducting Soil Surveys and Preparing Materials Reports.

T:\Projects\2014\Proposals GEO\P01114018 Bridge on Traweek Road over Binlon Creek\P01114018 Proposal.docx

PROPOSED SCOPE OF SERVICES

- Perform a site visit and field stake planned boring locations measured from the in-place bridge structure.
- Obtain the services of a subcontractor to provide access to proposed boring locations.
- Obtain utility clearances for the planned boring locations.
- Perform soil borings in general accordance with ALDOT-398 and our conversations with the ALDOT State Geotechnical Engineer. We will perform one boring at each abutment and two borings representing the interior bents for a total of four borings. We have based our number of borings on the soil stratum and rock stratum being relatively uniform between boring locations. If conditions are encountered which differ significantly from boring to boring, additional borings (up to 1 boring per bent) may be necessary to comply with ALDOT 398. Any additional borings will be billed at TTL's current ALDOT approved rates. We will drill to auger refusal and rock core approximately 20 feet at each location to estimate the quality of the rock. The borings will be performed in general accordance with AASHTO T-206 and T-225. For estimating quantities, we have assumed maximum overburden depths of 40 feet at the abutments and interior bents.
- Split-spoon sampling will be conducted at approximately 5-foot intervals to auger refusal.
- We will perform a total of four additional borings for the realigned bridge approaches. Due to the unequal length of the approaches, one boring will be performed to a depth of 11 feet below the ground surface at the eastern approach and three borings will be performed to between 6 and 21 feet below the ground surface on the western approach in general accordance with AASHTO T-206. A log of each boring will be provided to Tuscaloosa County. Our understanding is Tuscaloosa County will prepare a Materials Report for the approaches.
- Since the drilling for several of the soil survey borings will have to be performed in the existing single-lane roadway, we anticipate closing the road for a few minutes and assume that the road can be closed during daylight hours for our drilling.
- Perform laboratory classification testing of selected split-spoon samples to provide general characteristics of the subsurface soils.
- Perform corrosion analysis on water and soil samples.
- Perform hydrometer analysis of soil overburden to determine D50 values for use by ALDOT Bridge Bureau for performing a scour analysis.
- Analyze the data and prepare a Bridge Foundation Report.

COMPENSATION

We recommend a budget of \$23,000.00 for the bridge foundation report with four borings and assisting Tuscaloosa County in the preparation of a materials report for the relocated approaches. If differing conditions are encountered which require additional borings (up to 1 boring per bent), we recommend increasing the overall project geotechnical budget by \$6,400.00 to cover the additional drilling costs. The additional drilling will not be performed unless specifically authorized by Tuscaloosa County prior to performing the work.

We appreciate the opportunity to present this proposal and we look forward to working with you to execute this project. Please call if you have any questions.

Sincerely,
TTL, Inc.



Brian E. Wysock, E.I.
Staff Professional



Harvey F. Upchurch, Jr., P.E.
Senior Project Manager

Enclosures:

ASFE Information
Client Project Services Agreement

Important Information about This Geotechnical Engineering Proposal

Subsurface problems are a potential cause of construction delays, cost overruns, claims, and disputes.

While you cannot eliminate all such risks, you can manage them. The following set of guidelines is provided to help.

Participate in Development of the Subsurface Exploration Plan

Geotechnical engineering begins with the creation of an effective subsurface exploration plan. This proposal starts the process by presenting an initial plan. While that plan may consider the unique physical attributes of the site and the improvements you have in mind, it probably does not consider your unique goals, objectives, and risk management preferences. Subsurface exploration plans that are finalized without considering such factors presuppose that clients' needs are unimportant, or that all clients have the same needs. *Avoid the problems that can stem from such assumptions* by finalizing the plan and other scope elements directly with the geotechnical engineer you feel is best qualified for the project, along with the other project professionals whose plans are affected by the geotechnical engineer's findings and recommendations. If you have been told that this step is unnecessary; that client preferences do not influence the scope of geotechnical engineering service or that someone else can articulate your needs as well as you, you have been told wrong. No one else can discuss your geotechnical options better than an experienced geotechnical engineer, and no one else can provide the input you can. Thus, while you certainly are at liberty to accept a proposed scope "as is," recognize that it could be a unilateral scope developed without direct client/engineer discussion; that authorizing a unilateral scope will force the geotechnical engineer to accept all assumptions it contains; that assumptions create risk. *Manage your risk. Get involved.*

Expect the Unexpected

The nature of geotechnical engineering is such that planning needs to *anticipate the unexpected*. During the design phase of a project, more or deeper borings may be required, additional tests may become necessary, or someone associated with your organization may request a service that was not included in the final scope. During the construction phase, additional services may be needed to respond quickly to unanticipated conditions. In the past, geotechnical engineers commonly did

whatever was required to oblige their clients' representatives and safeguard their clients' interests, taking it on faith that their clients wanted them to do so. But some, evidently, did not, and refused to pay for legitimate extras on the ground that the engineer proceeded without proper authorization, or failed to submit notice in a timely manner, or failed to provide proper documentation. *What are your preferences? Who is permitted to authorize additional geotechnical services on your project? What type of documentation do you require? To whom should it be sent? When? How?* By addressing these and similar issues sooner rather than later, you and your geotechnical engineer will be prepared for the unexpected, to help prevent molehills from growing into mountains.

Have Realistic Expectations; Apply Appropriate Preventives

The recommendations included in a geotechnical engineering report are *not final*, because they are based on opinions that can be verified only during construction. For that reason, most geotechnical engineering proposals offer the construction observation services that permit the geotechnical engineer of record to confirm that subsurface conditions are what they were expected to be, or to modify recommendations when actual conditions were not anticipated. *An offer to provide construction observation is an offer to better manage your risk.* Clients who do not take advantage of such an offer; clients who retain a second firm to observe construction, can create a high-risk "Catch-22" situation for themselves. *The geotechnical engineer of record cannot assume responsibility or liability for a report's recommendations when another firm performs the services needed to evaluate the recommendations' adequacy.* The second firm is also likely to disavow liability for the recommendations, because of the substantial and possibly uninsurable risk of assuming responsibility for services it did not perform. Recognize, too, that no firm other than the geotechnical engineer of record can possibly have as intimate an understanding of your project's geotechnical issues. As such, reliance on a second firm to perform construction observation can elevate risk still more, because its personnel may not

have the wherewithal to recognize subtle, but sometimes critically important unanticipated conditions, or to respond to them in a manner consistent with your goals, objectives, and risk management preferences.

Realize That Geoenvironmental Issues Have Not Been Covered

The equipment, techniques, and personnel used to perform a geoenvironmental study differ significantly from those used to perform a geotechnical study. *Geoenvironmental services are not being offered in this proposal. The report that results will not relate any geoenvironmental findings, conclusions, or recommendations.* Unanticipated environmental problems have led to numerous project failures. If you have not yet obtained your own geoenvironmental information, ask your geotechnical consultant for risk management guidance. *Do not rely on an environmental report prepared for someone else.*

Obtain Professional Assistance To Deal with Mold

Diverse strategies can be applied during building design, construction, operation, and maintenance to prevent significant amounts of mold from growing on indoor surfaces. To be effective, all such strategies should be devised for the express purpose of mold prevention, integrated into a comprehensive plan, and executed with diligent oversight by a professional mold prevention consultant. Because just a small amount of water or moisture can lead to the development of severe mold infestations, a number of mold prevention strategies focus on keeping building surfaces dry. While groundwater, water infiltration, and similar issues may be addressed as part of the geotechnical engineering study described in this proposal, the geotechnical engineer who would lead this project *is not a mold prevention consultant; none of the services being offered have been designed or proposed for the purpose of mold prevention.*

Have the Geotechnical Engineer Work with Other Design Professionals and Constructors

Other design team members' misinterpretation of a geotechnical engineering report has resulted in costly problems. Manage that risk by hav-

ing your geotechnical engineer confer with appropriate members of the design team before finalizing the scope of geotechnical service (as suggested above), and, again, after submitting the report. *Also retain your geotechnical engineer to review pertinent elements of the design team members' plans and specifications.*

Reduce the risk of unanticipated conditions claims that can occur when constructors misinterpret or misunderstand the purposes of a geotechnical engineering report. Use appropriate language in your contract documents. Retain your geotechnical engineer to participate in prebid and preconstruction conferences, and to perform construction observation.

Read Responsibility Provisions Closely

Clients, design professionals, and constructors who do not recognize that geotechnical engineering is far less exact than other engineering disciplines can develop unrealistic expectations. Unrealistic expectations can lead to disappointments, claims, and disputes. To help reduce the risk of such outcomes, geotechnical engineers commonly include a variety of explanatory provisions in their proposals. Sometimes labeled "limitations," many of these provisions indicate where geotechnical engineers' responsibilities begin and end, to help others recognize their own responsibilities and risks, thus to encourage more effective scopes of service. *Read this proposal's provisions closely.* Ask questions. Your geotechnical engineer should respond fully and frankly.

Rely on Your ASFE-Member Geotechnical Engineer for Additional Assistance

Membership in ASFE/The Best People on Earth exposes geotechnical engineers to a wide array of risk management techniques that can be of genuine benefit to everyone involved with a construction project. Confer with an ASFE member geotechnical engineer for more information. Confirm a firm's membership in ASFE by contacting ASFE directly or at its website.



8811 Colesville Road/Suite G106, Silver Spring, MD 20910

Telephone: 301/565-2733 Facsimile: 301/589-2017

e-mail: info@asfe.org www.asfe.org

Copyright 2004 by ASFE, Inc. Duplication, reproduction, or copying of this document, in whole or in part, by any means whatsoever, is strictly prohibited, except with ASFE's specific written permission. Excerpting, quoting, or otherwise extracting wording from this document is permitted only with the express written permission of ASFE, and only for purposes of scholarly research or book review. Only members of ASFE may use this document as a complement to or as an element of a geotechnical engineering proposal. Any other firm, individual, or other entity that so uses this document without being an ASFE member could be committing negligent or intentional (fraudulent) misrepresentation.

IGEP06045.0M



Almon Associates, Inc.
P.O. Drawer 2729
Tuscaloosa, AL 35403

2008 12th Street
Tuscaloosa, AL 35401

phone: 205.349.2100
fax: 205.349.2107
web: www.almonassociates.com

March 6, 2014

Mr. Bobby Hagler, P.E.
Tuscaloosa County Public Works
2810 35th St.
Tuscaloosa, AL 35401

Re: Contract amendment for: Almon Contract 2012-131,
TCP 63-10-12, Malone Creek Road Bridge over Malone Mill Creek

Dear Mr. Hagler,

We are writing to request adjustments to our engineering contract to correspond with changes required by the Alabama Department of Transportation (ALDOT) on the above referenced bridge project. The Hydraulic Analysis performed by ALDOT shows that the bridge geometry required is significantly higher and longer than is currently provided for by our current scope of services. The additional height and length of the bridge necessitates that the roadway shift horizontally in order to minimize wetland fill adjacent to the roadway approach. I have attached a small drawing showing the existing contours as well as the proposed roadway approach layout that minimizes potential wetland fill. In addition, the re-alignment requires a horizontal curve in the bridge. We have reviewed this alignment, as well as other alternatives, with the Tuscaloosa County Engineering Staff and determined it to be the most desirable of the alternatives evaluated. With the additional length of the bridge, the additional complexity of the horizontal curve in the bridge, and the required realignment of the roadway, we respectfully ask that you consider the following additions to the scope and corresponding fees for our contract.

Additional Geotechnical Engineering:

Our current contract scope is based on a three span bridge replacing the existing bridge in approximately the same location as the existing bridge. The increase to a six span bridge may require additional soil borings. It is our understanding that the ALDOT materials section typically requires a soil boring at each bent; however, they will allow a reduction from that number if uniform soil conditions are present. Based on our discussions with TTL, Inc., we assume that the soil conditions at this location will be uniform. If the soil borings confirm this assumption, we will be able to drill the same number of locations that was originally included in our contract. If, however, the soil boring data refutes our assumption, we will be required to collect the additional borings. TTL, Inc. will be providing this service for us. We therefore request that our contract scope of services be amended to incorporate the attached Proposal from TTL, Inc. dated February 14, 2014, and to add an optional Lump Sum contract fee amount of \$5,800 for additional soil borings, in the event of non-uniform conditions. We will not proceed with the additional borings without prior approval of the county engineer.

Additional Roadway Approach Engineering:

Our current contract only includes minor roadway realignment design. We request to amend our scope of services to include evaluation of alternate roadway alignments for an additional fee of \$3,900.00.

CIVIL ENGINEERING

SITE DESIGN • ENVIRONMENTAL • STRUCTURAL DESIGN • SURVEYING • MAPPING • TRANSPORTATION • WATER RESOURCES

Additional Bridge Structural Engineering:

Our current contract scope of services under the bridge structural engineering is for a three span AASHTO Girder Bridge in a tangent section with a constant elevation. The required realignment still provides for a consistent cross section for the length of the bridge, but the bridge is now in a horizontal curve. We request to add to the scope of services to increase the bridge to a six spans, and to add detailed design for the horizontal curvature in the bridge. We request additional compensation of \$3,500.00 under bridge structural engineering to correspond with the increased complexity in the scope.

Elimination of Categorical Exclusion Preparation

Our current contract scope includes an hourly fee for preparing the categorical exclusion. The Tuscaloosa County Engineering staff has decided to perform this portion of the work in house. We therefore recommend eliminating this line item from our contract scope as well as the removal of the \$3,500.00 previously budgeted for this work.

In summary, the contract fee adjustments are as follows:

Lump Sum Fees:

	<u>Current Contract</u>	<u>Additional Fee</u>	<u>Total</u>
1) Design Topographic Survey	\$ 7,050.00	\$ 0.00	\$ 7,050.00
2) Property Survey, Tract Sketches and Legal Descriptions	\$ 2,850.00	\$ 0.00	\$ 2,850.00
3) Geotechnical Engineering			
a. Foundation Report	\$ 25,000.00	\$ 0.00	\$ 25,000.00
b. Additional Boring, if non- uniform soil conditions exist	\$ 0.00	\$ 5,800.00	\$ 5,800.00
4) Engineering Design and Construction Plans			
a. Roadway Geometry and Approach Plans	\$ 18,500.00	\$ 3,900.00	\$ 22,400.00
b. Bridge Structural	\$ 37,000.00	\$ 3,500.00	\$ 40,500.00
	<u>\$ 90,400.00</u>	<u>\$ 13,200.00</u>	<u>\$ 103,600.00</u>

Hourly Rate Fees:

Categorical Exclusion Preparation	\$ 3,500.00	\$ (3,500.00)	\$ 0.00
Utility Coordination Services	\$ 1,200.00	\$ 0.00	\$ 1,200.00

Please let us know if you have any questions or need additional information.

Sincerely;
Almon Associates, Inc.

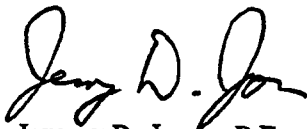

Jeremy D. Jones, P.E.
Associate



3516 Greensboro Avenue
Tuscaloosa, AL 35401
205.345.0816
www.ttlusa.com

February 14, 2014

Mr. Jeremy Jones, P.E.
Almon Associates, Inc.
2008 12th Street
Tuscaloosa, AL 35401

**RE: Proposal for Bridge Foundation Report
Bridge Replacement on Malone Creek Road over Malone Creek
Tuscaloosa County, Alabama
Tuscaloosa County Project No. TCP 63-10-12
TTL Proposal No. P01114019**

Dear Mr. Jones:

TTL, Inc. (TTL) is pleased to submit this proposal for a bridge foundation report on the above-referenced project. The work performed under this proposal will be in accordance with the following documents.

- ALDOT Procedure 390
- ALDOT Procedure 398
- ALDOT Guidelines For Operation 3-70
- Checklist and Guidelines for Review of Geotechnical Reports prepared by the Federal Highway Administration (FHWA)

PROJECT INFORMATION

The project consists of replacing the existing bridge over Malone Creek on Malone Creek Road in western Tuscaloosa County. The existing bridge over Malone Creek is a one-lane, timber bridge. We understand the replacement bridge will be a two-lane, six-span AASHTO girder bridge based on the hydraulic review. It is our understanding that this project will be partially funded through the Alabama Transportation Rehabilitation and Improvement Program (ATRIP). Since the bridge is an AASHTO girder bridge, our work for the replacement bridge will be performed in general accordance with ALDOT-398 Procedure for Conducting Subsurface Investigation and Foundation Reports and our conversations with the ALDOT State Geotechnical Engineer. Revisions to the design of the approaches include realignment of the bridge approaches on both the east and west ends of the bridge. Our work for the bridge approaches will be performed in general accordance with ALDOT-390 Procedure for Conducting Soil Surveys and Preparing Materials Reports. Based on this information, we have revised our fee estimate for performing geotechnical services on this project.

PROPOSED SCOPE OF SERVICES

- Perform a site visit and field stake planned boring locations measured from the in-place bridge structure.
- Obtain the services of a subcontractor to provide access to proposed boring locations.

T:\Projects\2014\Proposals GEO\P01114019 Bridge over Malone Creek\P01114019 Proposal.docx

- Obtain utility clearances for the planned boring locations.
- Perform soil borings in general accordance with ALDOT-398 and our conversations with the ALDOT State Geotechnical Engineer. We will perform one boring at each abutment and two borings representing the interior bents for a total of four borings. We have based our number of borings on expectation that the subsurface condition will be fairly uniform between boring locations. If conditions are encountered which differ significantly from boring to boring, additional borings may be necessary to comply with ALDOT-398. Any additional borings will be billed at TTL's current ALDOT approved rates. We expect the borings will be terminated at a maximum depth of 80 feet below the ground surface. Split-spoon sampling will be conducted at approximately 5-foot intervals in the borings.
- We will perform a total of four additional borings for the realigned bridge approaches. The borings will be performed to a depth ranging between 6 and 21 feet below the ground surface in general accordance with AASHTO T-206. A log of each boring will be provided to Tuscaloosa County. Our understanding is Tuscaloosa County will prepare a Materials Report for the approaches.
- Since the drilling for several of the borings will likely be performed in the existing roadway, we anticipate closing the road may be required during daylight hours to allow for our drilling operation. We have assumed Tuscaloosa County will assist in the road closure if required.
- Perform laboratory classification testing of selected split-spoon samples to provide general characteristics of the subsurface soils.
- Perform corrosion analysis on water and soil samples.
- Perform hydrometer analysis of soil overburden to determine D50 values for use by ALDOT Bridge Bureau for performing a scour analysis.
- Analyze the data and prepare a Bridge Foundation Report.

COMPENSATION

We recommend a budget of \$22,750.00 for the bridge foundation report with four borings and assisting Tuscaloosa County in the preparation of a materials report for the relocated approaches. If differing conditions are encountered which require additional borings (up to 1 boring per bent), we recommend increasing the overall project geotechnical budget by \$5,250.00 to cover the additional drilling costs. The additional drilling will not be performed unless specifically authorized by Tuscaloosa County prior to performing the work.

We appreciate the opportunity to present this proposal and we look forward to working with you to execute this project. Please call if you have any questions.

Sincerely,
TTL, Inc.

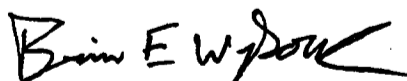

Brian E. Wysock, E.I.
Staff Professional



Harvey, F. Upchurch, Jr., P.E.
Senior Project Manager

Enclosures: ASFE Information
Client Project Services Agreement

Important Information about This Geotechnical Engineering Proposal

Substantial problems can result from poor or incomplete data, and various claims and disputes.

While you cannot eliminate all risks, you can control them. The following information is provided to help you.

Participate in Development of the Subsurface Exploration Plan

Geotechnical engineering begins with the creation of an effective subsurface exploration plan. This proposal starts the process by presenting an initial plan. While that plan may consider the unique physical attributes of the site and the improvements you have in mind, it probably does not consider your unique goals, objectives, and risk management preferences. Subsurface exploration plans that are finalized without considering such factors presuppose that clients' needs are unimportant, or that all clients have the same needs. *Avoid the problems that can stem from such assumptions* by finalizing the plan and other scope elements directly with the geotechnical engineer you feel is best qualified for the project, along with the other project professionals whose plans are affected by the geotechnical engineer's findings and recommendations. If you have been told that this step is unnecessary; that client preferences do not influence the scope of geotechnical engineering service or that someone else can articulate your needs as well as you, you have been told wrong. No one else can discuss your geotechnical options better than an experienced geotechnical engineer, and no one else can provide the input you can. Thus, while you certainly are at liberty to accept a proposed scope "as is," recognize that it could be a unilateral scope developed without direct client/engineer discussion; that authorizing a unilateral scope will force the geotechnical engineer to accept all assumptions it contains; that assumptions create risk. *Manage your risk. Get involved.*

Expect the Unexpected

The nature of geotechnical engineering is such that planning needs to *anticipate the unexpected*. During the design phase of a project, more or deeper borings may be required, additional tests may become necessary, or someone associated with your organization may request a service that was not included in the final scope. During the construction phase, additional services may be needed to respond quickly to unanticipated conditions. In the past, geotechnical engineers commonly did

whatever was required to oblige their clients' representatives and safeguard their clients' interests, taking it on faith that their clients wanted them to do so. But some, evidently, did not, and refused to pay for legitimate extras on the ground that the engineer proceeded without proper authorization, or failed to submit notice in a timely manner, or failed to provide proper documentation. *What are your preferences? Who is permitted to authorize additional geotechnical services on your project? What type of documentation do you require? To whom should it be sent? When? How?* By addressing these and similar issues sooner rather than later, you and your geotechnical engineer will be prepared for the unexpected, to help prevent molehills from growing into mountains.

Have Realistic Expectations; Apply Appropriate Preventives

The recommendations included in a geotechnical engineering report are *not final*, because they are based on opinions that can be verified only during construction. For that reason, most geotechnical engineering proposals offer the construction observation services that permit the geotechnical engineer of record to confirm that subsurface conditions are what they were expected to be, or to modify recommendations when actual conditions were not anticipated. *An offer to provide construction observation is an offer to better manage your risk.* Clients who do not take advantage of such an offer; clients who retain a second firm to observe construction, can create a high-risk "Catch-22" situation for themselves. *The geotechnical engineer of record cannot assume responsibility or liability for a report's recommendations when another firm performs the services needed to evaluate the recommendations' adequacy.* The second firm is also likely to disavow liability for the recommendations, because of the substantial and possibly uninsurable risk of assuming responsibility for services it did not perform. Recognize, too, that no firm other than the geotechnical engineer of record can possibly have as intimate an understanding of your project's geotechnical issues. As such, reliance on a second firm to perform construction observation can elevate risk still more, because its personnel may not

have the wherewithal to recognize subtle, but sometimes critically important unanticipated conditions, or to respond to them in a manner consistent with your goals, objectives, and risk management preferences.

Realize That Geoenvironmental Issues Have Not Been Covered

The equipment, techniques, and personnel used to perform a geoenvironmental study differ significantly from those used to perform a geotechnical study. *Geoenvironmental services are not being offered in this proposal. The report that results will not relate any geoenvironmental findings, conclusions, or recommendations.* Unanticipated environmental problems have led to numerous project failures. If you have not yet obtained your own geoenvironmental information, ask your geotechnical consultant for risk management guidance. *Do not rely on an environmental report prepared for someone else.*

Obtain Professional Assistance To Deal with Mold

Diverse strategies can be applied during building design, construction, operation, and maintenance to prevent significant amounts of mold from growing on indoor surfaces. To be effective, all such strategies should be devised for the express purpose of mold prevention, integrated into a comprehensive plan, and executed with diligent oversight by a professional mold prevention consultant. Because just a small amount of water or moisture can lead to the development of severe mold infestations, a number of mold prevention strategies focus on keeping building surfaces dry. While groundwater, water infiltration, and similar issues may be addressed as part of the geotechnical engineering study described in this proposal, the geotechnical engineer who would lead this project *is not* a mold prevention consultant; *none of the services being offered have been designed or proposed for the purpose of mold prevention.*

Have the Geotechnical Engineer Work with Other Design Professionals and Constructors

Other design team members' misinterpretation of a geotechnical engineering report has resulted in costly problems. Manage that risk by hav-

ing your geotechnical engineer confer with appropriate members of the design team before finalizing the scope of geotechnical service (as suggested above), and, again, after submitting the report. *Also retain your geotechnical engineer to review pertinent elements of the design team members' plans and specifications.*

Reduce the risk of unanticipated conditions claims that can occur when constructors misinterpret or misunderstand the purposes of a geotechnical engineering report. Use appropriate language in your contract documents. Retain your geotechnical engineer to participate in prebid and preconstruction conferences, and to perform construction observation.

Read Responsibility Provisions Closely

Clients, design professionals, and constructors who do not recognize that geotechnical engineering is far less exact than other engineering disciplines can develop unrealistic expectations. Unrealistic expectations can lead to disappointments, claims, and disputes. To help reduce the risk of such outcomes, geotechnical engineers commonly include a variety of explanatory provisions in their proposals. Sometimes labeled "limitations," many of these provisions indicate where geotechnical engineers' responsibilities begin and end, to help others recognize their own responsibilities and risks, thus to encourage more effective scopes of service. *Read this proposal's provisions closely. Ask questions.* Your geotechnical engineer should respond fully and frankly.

Rely on Your ASFE-Member Geotechnical Engineer for Additional Assistance

Membership in ASFE/The Best People on Earth exposes geotechnical engineers to a wide array of risk management techniques that can be of genuine benefit to everyone involved with a construction project. Confer with an ASFE member geotechnical engineer for more information. Confirm a firm's membership in ASFE by contacting ASFE directly or at its website.



8811 Colesville Road/Suite G106, Silver Spring, MD 20910
Telephone: 301/565-2733 Facsimile: 301/589-2017
e-mail: info@asfe.org www.asfe.org

Copyright 2004 by ASFE, Inc. Duplication, reproduction, or copying of this document, in whole or in part, by any means whatsoever, is strictly prohibited, except with ASFE's specific written permission. Excerpting, quoting, or otherwise extracting wording from this document is permitted only with the express written permission of ASFE, and only for purposes of scholarly research or book review. Only members of ASFE may use this document as a complement to or as an element of a geotechnical engineering proposal. Any other firm, individual, or other entity that so uses this document without being an ASFE member could be committing negligent or intentional (fraudulent) misrepresentation.



Almon Associates, Inc.
P.O. Drawer 2729
Tuscaloosa, AL 35403

2008 12th Street
Tuscaloosa, AL 35401

phone: 205.349.2100
fax: 205.349.2107
web: www.almonassociates.com

March 13, 2014

Mr. Bobby Hagler, P.E.
Tuscaloosa County Public Works
2810 35th St.
Tuscaloosa, Al 35401

Re: Contract amendment for: TCP 63-02-12, Dobbs Road Bridge Replacement Project

Dear Mr. Hagler,

We are writing to request fee adjustments corresponding to required scope changes on the above referenced project. The Alabama Department of Transportation (ALDOT) is requiring the County to change the design from a culvert to a precast bridge due to soft soils present at the creek crossing. We have evaluated several alternate alignments and design speeds in conjunction with the County Engineering Staff and have determined the most desirable alternate is one that meets a 35 MPH design speed and significantly raises the elevation of the existing bridge. This revised profile, coupled with the change from a culvert to a bridge will require changes to every plan sheet, as well as adjustment to the ROW required. Geotechnical Engineering will also have to be re-done, including new soil borings at the required bent location.

In order to revise the plans and include the required bridge layout sheet, we request an additional fee in the amount of \$19,500.

We have negotiated a fee with TTL to provide the additional drilling as well as revising the foundation report for the required bridge. The proposed fee for these additional services is estimated to be \$13,800. Please find attached the proposal by TTL for the additional Geotechnical Engineering work.

With both scope changes listed above, the total additional costs to the county will be approximately \$33,300.

Please let us know if you have any questions or need additional information.

Sincerely,
Almon Associates, Inc.

A handwritten signature in black ink that reads "Jeremy D. Jones".

Jeremy D. Jones, P.E.
Associate

CIVIL ENGINEERING

SITE DESIGN • ENVIRONMENTAL • STRUCTURAL DESIGN • SURVEYING • MAPPING • TRANSPORTATION • WATER RESOURCES



3516 Greensboro Avenue
Tuscaloosa, AL 35401
205.345.0816
www.ttiusa.com

March 11, 2014

Mr. Jeremy Jones, P.E.
Almon Associates, Inc.
2008 12th Street
Tuscaloosa, AL 35401

**RE: Proposal for Bridge Foundation Report
Bridge Replacement on CR 144 (Dobbs Road) Over Thornton Creek
Tuscaloosa County, Alabama
Project No. ACRZ-58497-ATRP(001)
TTL Proposal No. P01114027**

Dear Mr. Jones:

TTL, Inc. (TTL) is pleased to submit this proposal for a bridge foundation report on the above-referenced project. The work performed under this proposal will be in accordance with the following documents.

- ALDOT Procedure 398
- ALDOT Guidelines for Operation 3-70
- Checklist and Guidelines for Review of Geotechnical Reports prepared by the Federal Highway Administration (FHWA)

PROJECT INFORMATION

The project consists of replacing the existing bridge (BIN 012418) over Thornton Creek on CR 144 (Dobbs Road) in northwestern Tuscaloosa County with a new bridge. TTL previously issued a Bridge Culvert Foundation Report dated May 7, 2013, and a data report dated March 29, 2013, for a Soil Survey report to be completed by Tuscaloosa County. Due to the soft material encountered and the anticipated settlement of the planned bridge culvert, a new bridge has been selected as the replacement for the existing bridge. The borings performed previously for the proposed culvert were not extended to a sufficient depth to provide recommendations for a replacement bridge. Project plan and profile provided to TTL indicates the replacement bridge will be precast concrete and consist of two 34-foot spans. The existing bridge over Thornton Creek is a two-lane, timber and concrete bridge with a length of about 30 feet.

PROPOSED SCOPE OF SERVICES

- Perform a site visit and field stake planned boring locations based on the in-place bridge location.
- Obtain utility clearances for the planned boring locations.

T:\Projects\2014\Proposals GEO\P01114027 Bridge Replacement on Dobbs Rd over Thornton Creek\027 Letter.docx

- Perform soil borings in general accordance with ALDOT Procedure 398 and Guidelines for Operation 3-70. We will perform a boring at one abutment and one boring for the interior bent (total of 2 borings). We anticipate one of the borings will have to be drilled through the bridge deck. We have assumed that Tuscaloosa County will perform the necessary repairs to the bridge deck upon completion of the borings. The borings will be performed to a depth of 80 feet below the ground surface in general accordance with AASHTO T-206.
- Split-spoon sampling will be conducted at approximately 5-foot intervals. The existing bridge is two lanes wide; therefore, we do not anticipate closing the bridge to perform our borings. TTL will provide the necessary traffic control needed to perform the boring through the existing bridge deck.
- Perform laboratory classification testing of selected split-spoon samples to provide general characteristics of the subsurface soils.
- Perform grain size analysis with hydrometer to obtain D-50 values for use by others in determining scour analysis.
- Perform corrosion analysis on water and soil samples.
- Analyze the data and prepare a bridge foundation report.

COMPENSATION

The attached Table I shows our estimates of the unit quantities, the unit rates for performing this work, and the estimated cost for each work task. We recommend a budget of \$13,800.00 for the bridge foundation report.

We appreciate the opportunity to present this proposal and we look forward to working with you to execute this project. Please call if you have any questions.

Sincerely,

TTL, Inc.



Brian E. Wysock, E.I.
Staff Professional

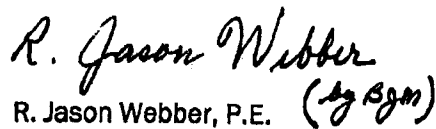

R. Jason Webber, P.E. (by sign)
Project Manager

Enclosures:

Table I - Cost Estimate
ASFE Information
Client Project Services Agreement



3516 Greensboro Avenue
 Tuscaloosa, AL 35401
 205.345.0816
 www.ttiusa.com 3/11/2014

Table I - Cost Estimate
Bridge Foundation Report
2-Span Precast Bridge Replacement
on CR 144 (Dobbs Road) Over Thornton Creek
Tuscaloosa County
ACBRZ-58497-ATRP(001)
TTL Proposal No. P01114027
Page 1 of 1

Task	Item	Unit	Rate	Quantity	Item Cost	Task Subtotal
Project Planning and Coordination						
	Staff Professional 4	hour	\$ 132.31	4	\$ 529.24	
	Mileage	mile	\$ 0.55	80	\$ 44.00	
						\$ 573.24
Drilling						
	Mobilization/Demobilization	mile	\$ 5.00	80	\$ 400.00	
	Concrete Coring (6" Dia./Inch Depth)	inch	\$ 12.00	6	\$ 72.00	
	Soil Boring per AASHTO T-208 w/SPT	feet	\$ 14.25	160	\$ 2,280.00	
	Split Spoon Samples (Additional)	feet	\$ 10.50	4	\$ 42.00	
	Set Temporary NW Casing for Coring	feet	\$ 6.40	25	\$ 160.00	
	Staff Professional 2	hour	\$ 93.38	28	\$ 2,614.84	
	Staff Professional 4	hour	\$ 132.31	4	\$ 529.24	
	Mileage	mile	\$ 0.55	80	\$ 44.00	
	Staff Technician 2	hour	\$ 51.38	20	\$ 1,027.20	
						\$ 7,169.08
Laboratory Testing						
	Atterberg Limits	each	\$ 75.00	2	\$ 150.00	
	Sieve Analysis	each	\$ 65.00	2	\$ 130.00	
	Moisture Content	each	\$ 10.00	2	\$ 20.00	
	Soil Classification with Hydrometer	each	\$ 240.00	4	\$ 960.00	
	pH	each	\$ 14.50	2	\$ 29.00	
	Sulfate	each	\$ 45.00	2	\$ 90.00	
	Resistivity	each	\$ 90.00	2	\$ 180.00	
	Chloride	each	\$ 45.00	2	\$ 90.00	
						\$ 1,849.00
Analysis and Report Preparation						
	Staff Professional 2	hour	\$ 93.38	18	\$ 1,680.84	
	Staff Professional 4	hour	\$ 132.31	6	\$ 793.86	
	Staff Professional 6	hour	\$ 176.96	5	\$ 884.80	
	Administrative Assistant	hour	\$ 55.23	3	\$ 165.89	
	Draftsman-CADD	hour	\$ 86.04	10	\$ 860.40	
	Mylar Copies of Drill Logs	page	\$ 11.75	2	\$ 23.50	
						\$ 4,409.09
						Total Project Estimate \$ 13,800.41

Tuscaloosa County Bid Data Sheet

BID NUMBER: 20140224001

CATEGORY: HERBICIDE

BID DATE: 2/24/2014

DATE SPECIFICATIONS RECEIVED: 2/24/2014

BID ITEM(S): herbicide application services on county roads, bridges, and other specified locations

Bid authorized by County Commission: YES NO

Date Authorized: 2/24/2014

Commission Book

Page:

Vendors Allowed 23 days

From 2/24/2014 to 3/19/2014

Specifications compiled by: County Engineer Bobby Hagler (205) 345-6600

Problems with specifications YES NO

If yes, explain:

Number of bidders notified: 16

Number that responded: 0

Bid opened in public meeting: YES NO

If no, explain:

Bid awarded to:

Bid Amount: 0.00

Date awarded: 1/1/2000

To low bidder: YES NO

Commission Book:

Page:

If not awarded to low bidder, was 3% applied? YES NO

if no, explain:

Bid rejected: YES NO

If yes, explain:

Comments, problems and/or recommendations:

Bidders responding to bid invitation:

Bid Submission Sheet

Herbicide Application on Tuscaloosa County Roads

Description	Quantity	Unit	Unit Price	Bid Amount
Paved Road Application	1	Lump Sum	<u>\$89,704.29</u>	<u>\$179,408.58</u>
Additional Paved Roads	10	Mile	<u>\$ 100.36</u>	<u>\$ 1,003.60</u>
Gravel Road Application	1	Lump Sum	<u>\$36,029.44</u>	<u>\$ 36,029.44</u>
Additional Gravel Roads	10	Mile	<u>\$ 99.20</u>	<u>\$ 992.00</u>
Curb & Gutter Application	63	Mile	<u>\$ 287.05</u>	<u>\$ 17,940.63</u>
Additional Curb & Gutter	2	Mile	<u>\$ 287.05</u>	<u>\$ 574.10</u>
Bridge Sites	189	Each	<u>\$ 37.98</u>	<u>\$ 7,161.21</u>
Special County Sites	1	Lump Sum	<u>\$ 2,469.26</u>	<u>\$ 4,938.52</u>
Total Bid				<u>\$248,048.08</u>

Company Name Edko, LLC

Mailing Address P. O. Box 1577 - Tuscaloosa, AL 35403

Telephone 205-507-0724

Email ted.kapera@edkollc.com

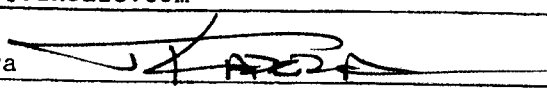
Bid Submitted By Ted Kapera 

Title Regional Sales Manager

Date March 19, 2014

Alabama State Custom Pesticide Applicator's License No. 2013058505

Alabama State Board of Contractors License No. 46682

Note: Attach bid bond, copies of licenses, and other documents as noted as being required in this document.

COUNTY SHOP AND BRIDGE YARD
PERIMETER FENCE

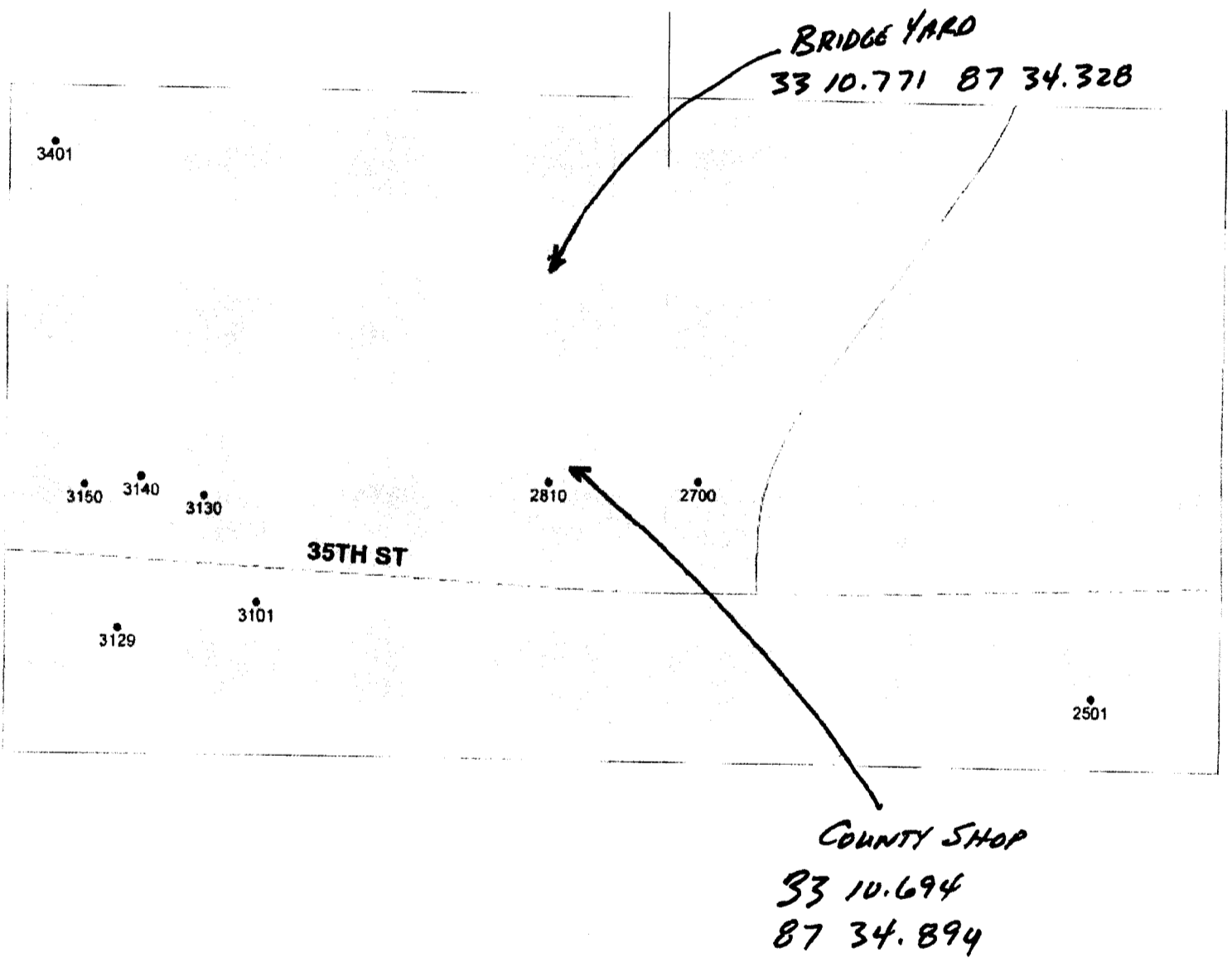

CAMP COKER
PERIMETER FENCE
33 14.375 87 39.373

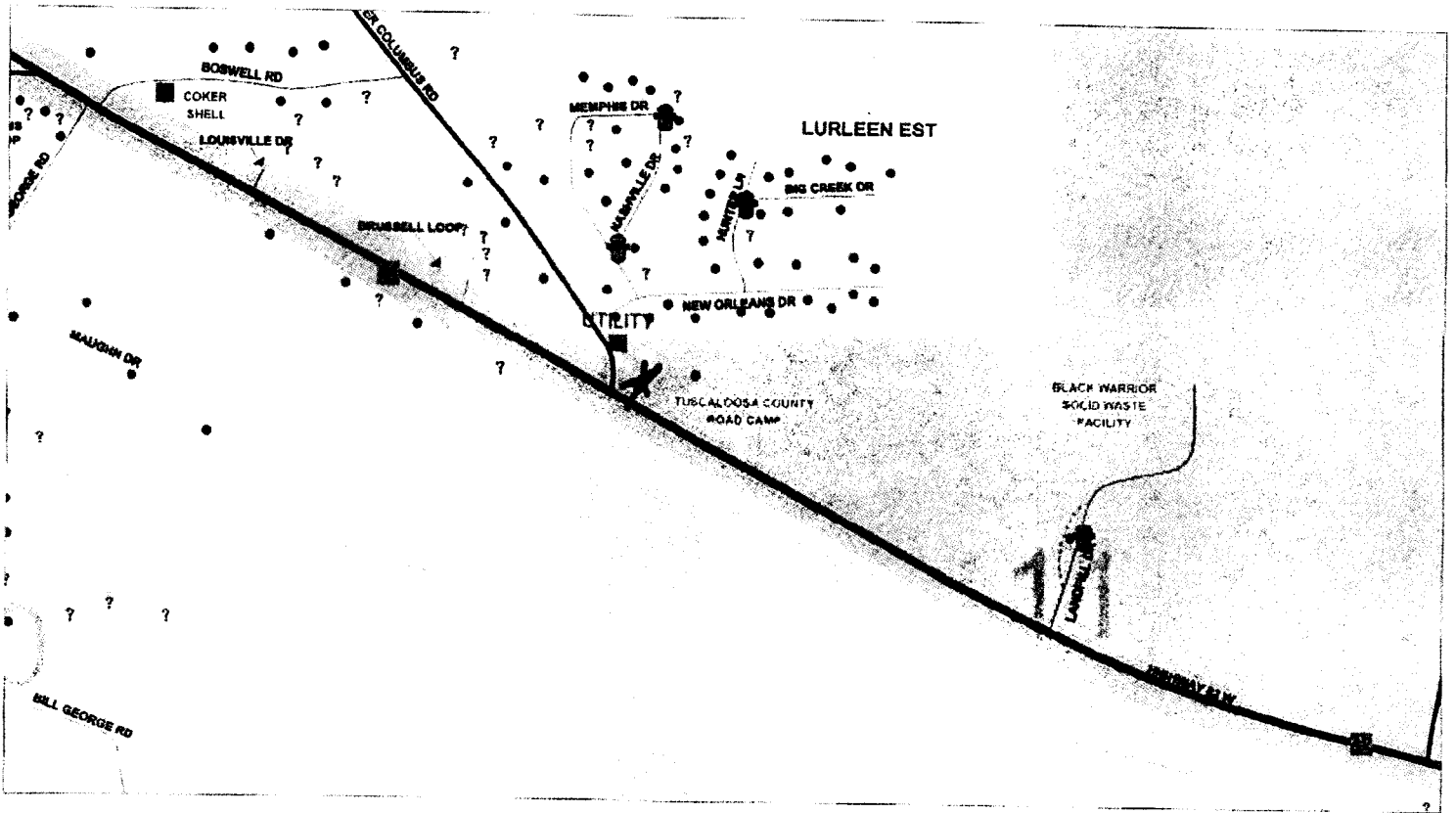

CAMP SAMANTHA
PERIMETER FENCE

33 25.229
87 36.194

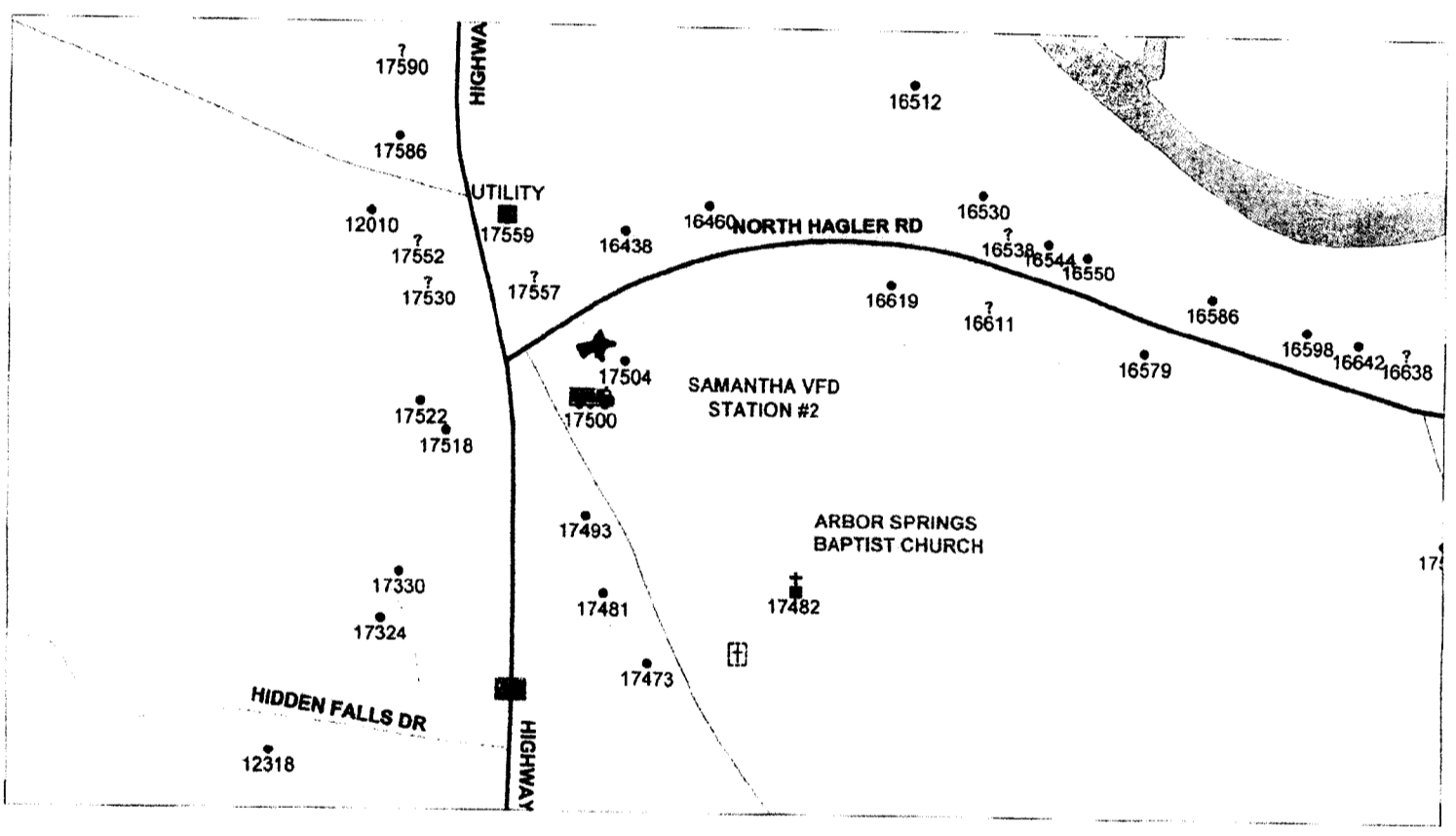

SHERIFF'S DEPARTMENT HANGAR

PERIMETER FENCE/PARKING LOT/APRON

N 33 13.247

W 087 36.752

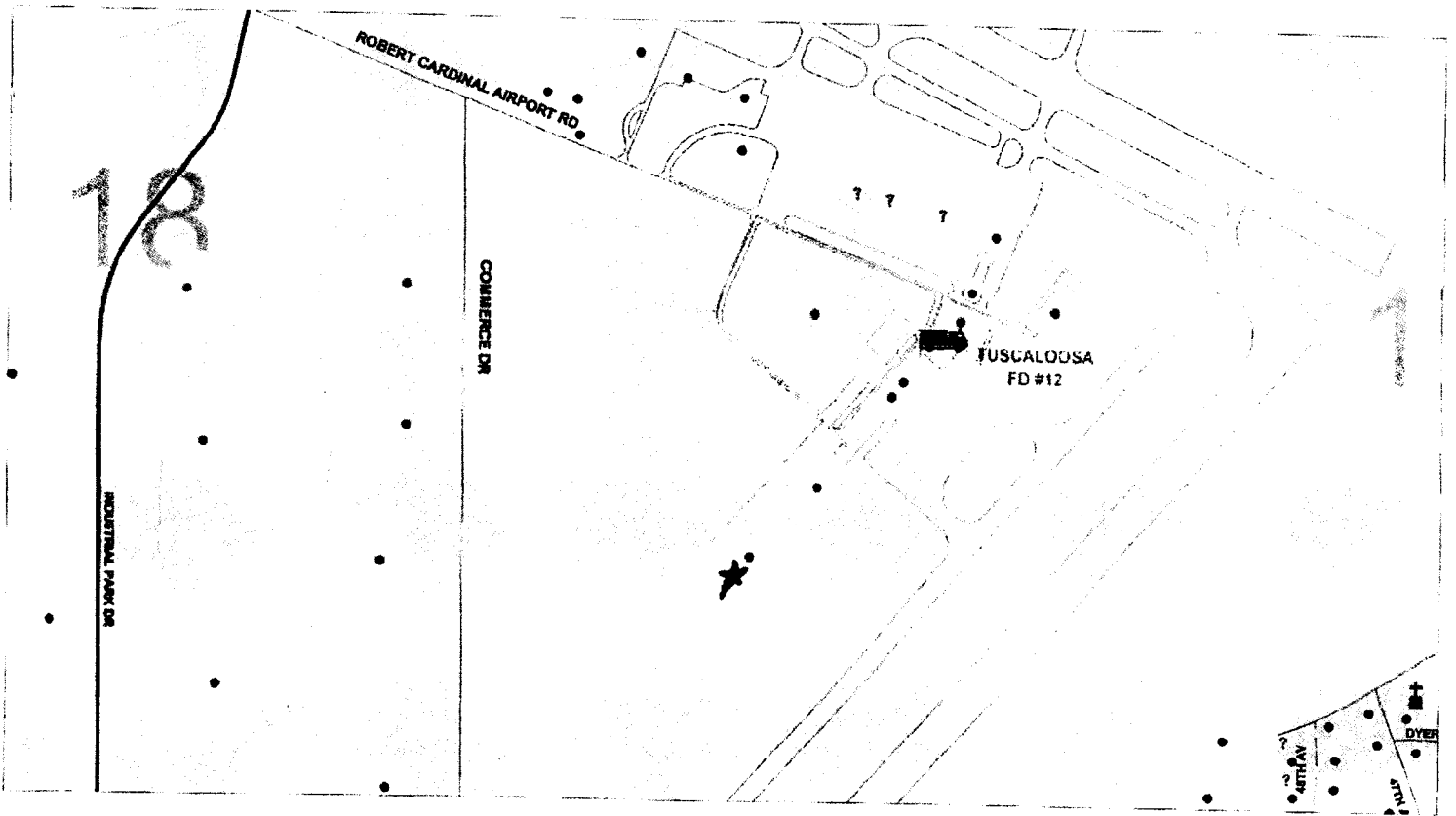

RADIO TOWER SITE
GAINESVILLE ROAD

PERIMETER FENCE

N 33 05.682

W 087 41.477

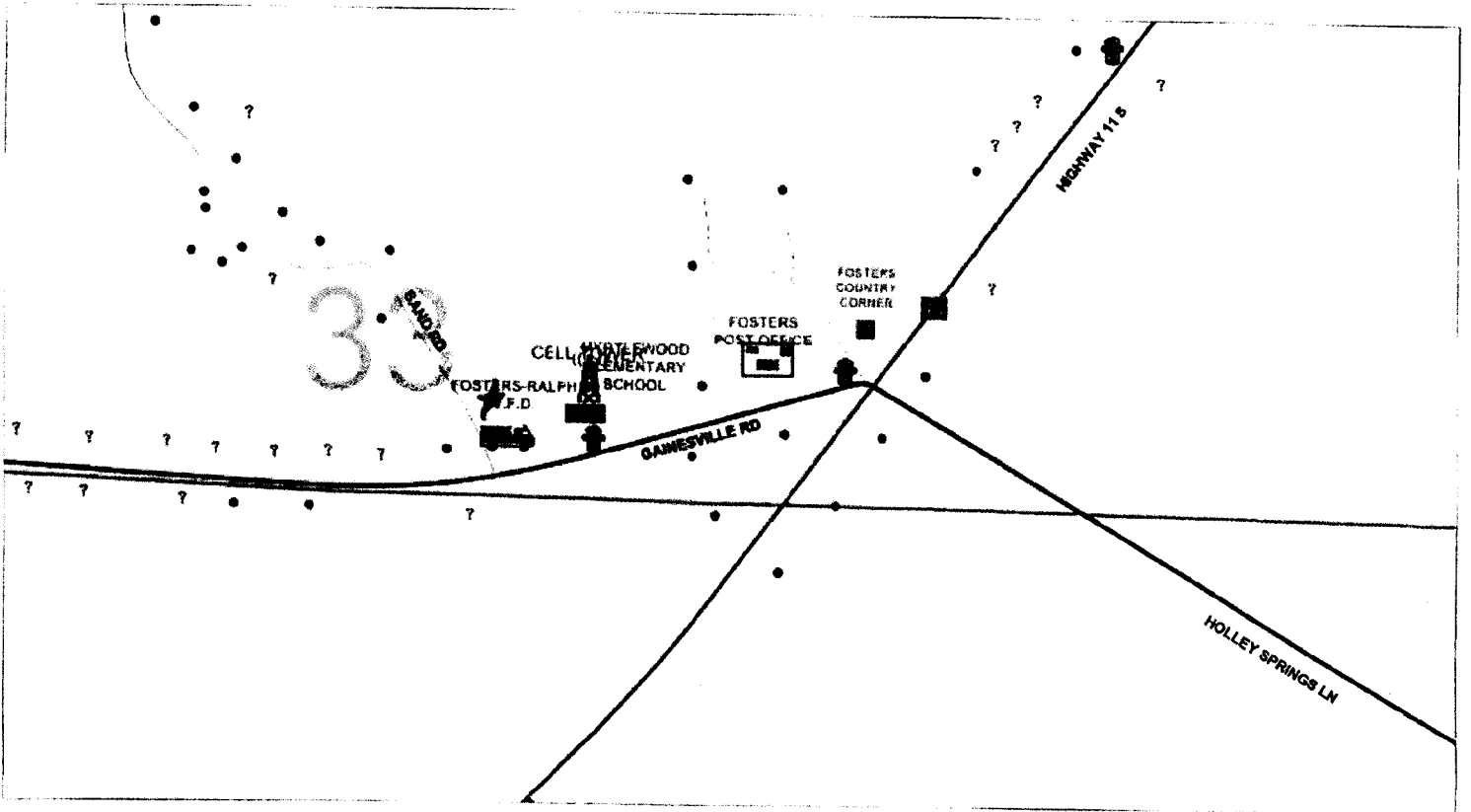

HANNA CREEK ROAD
TOWER SITE
PERIMETER FENCE
33 18.389
87 17.461

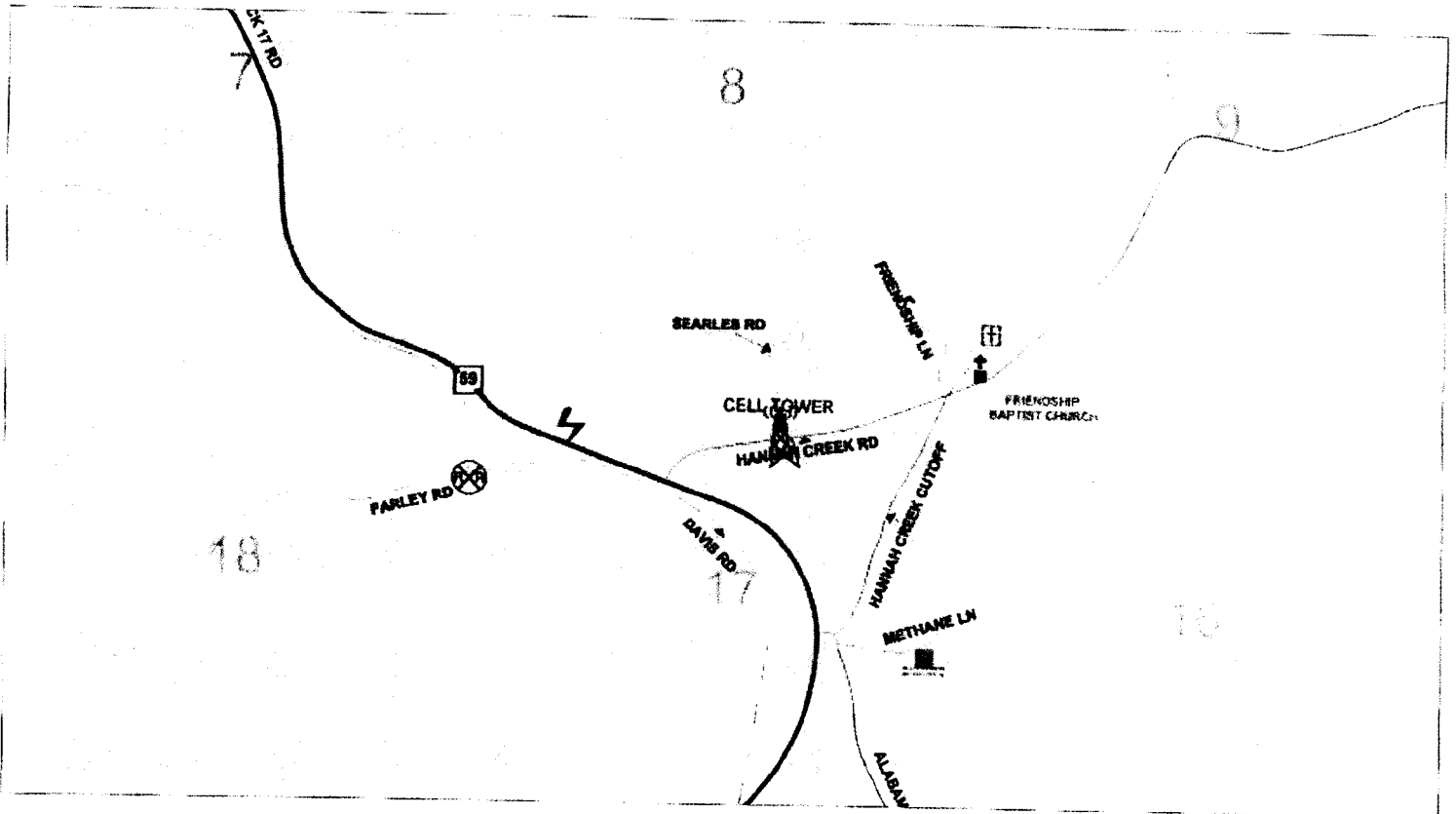

RADIO TOWER SITE
PHILLIPS MOUNTAIN
PERIMETER FENCE

N 33 29.083
W 087 45.702

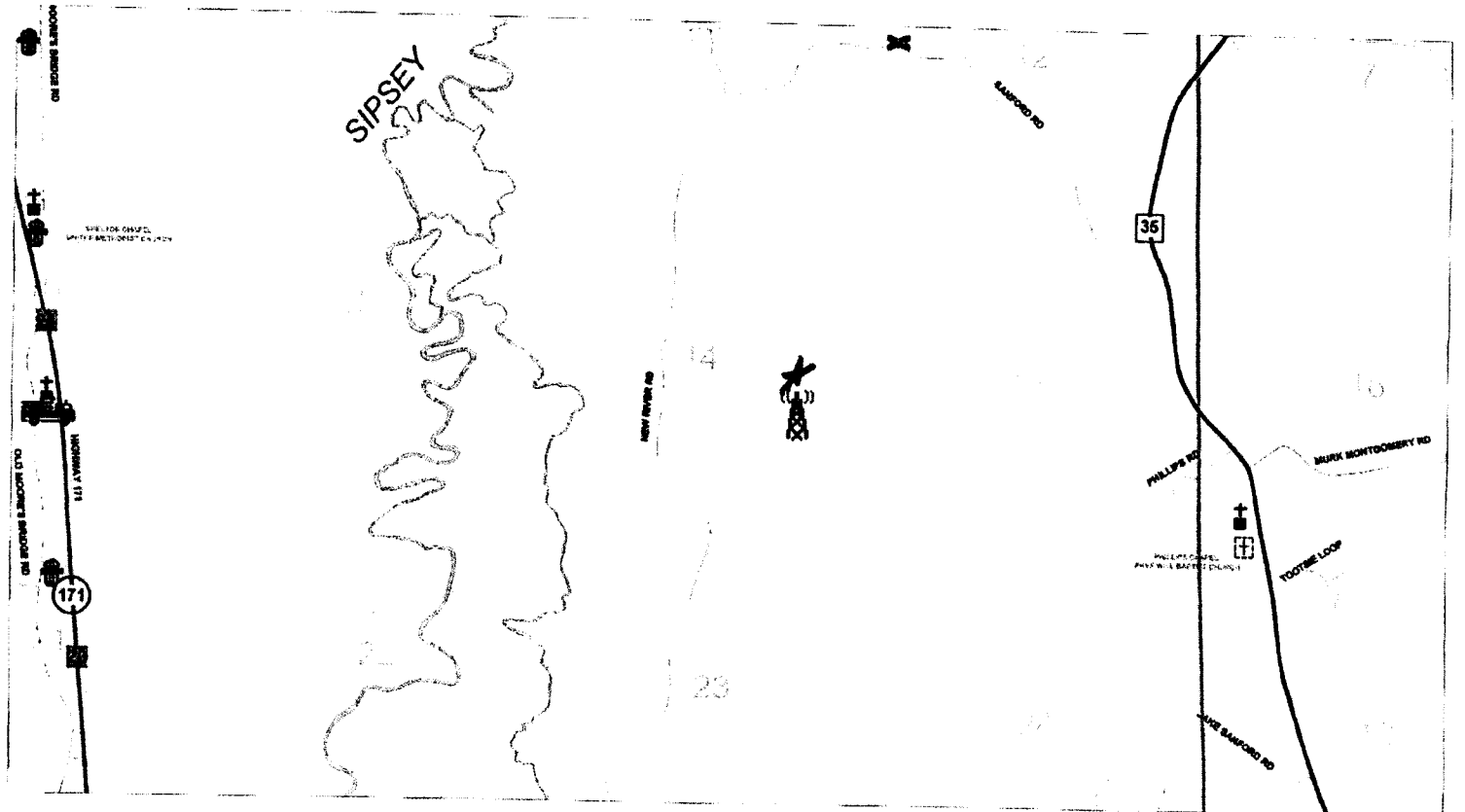

JUG FACTORY ROAD

TOWER SITE

33 09.512

87 30.909

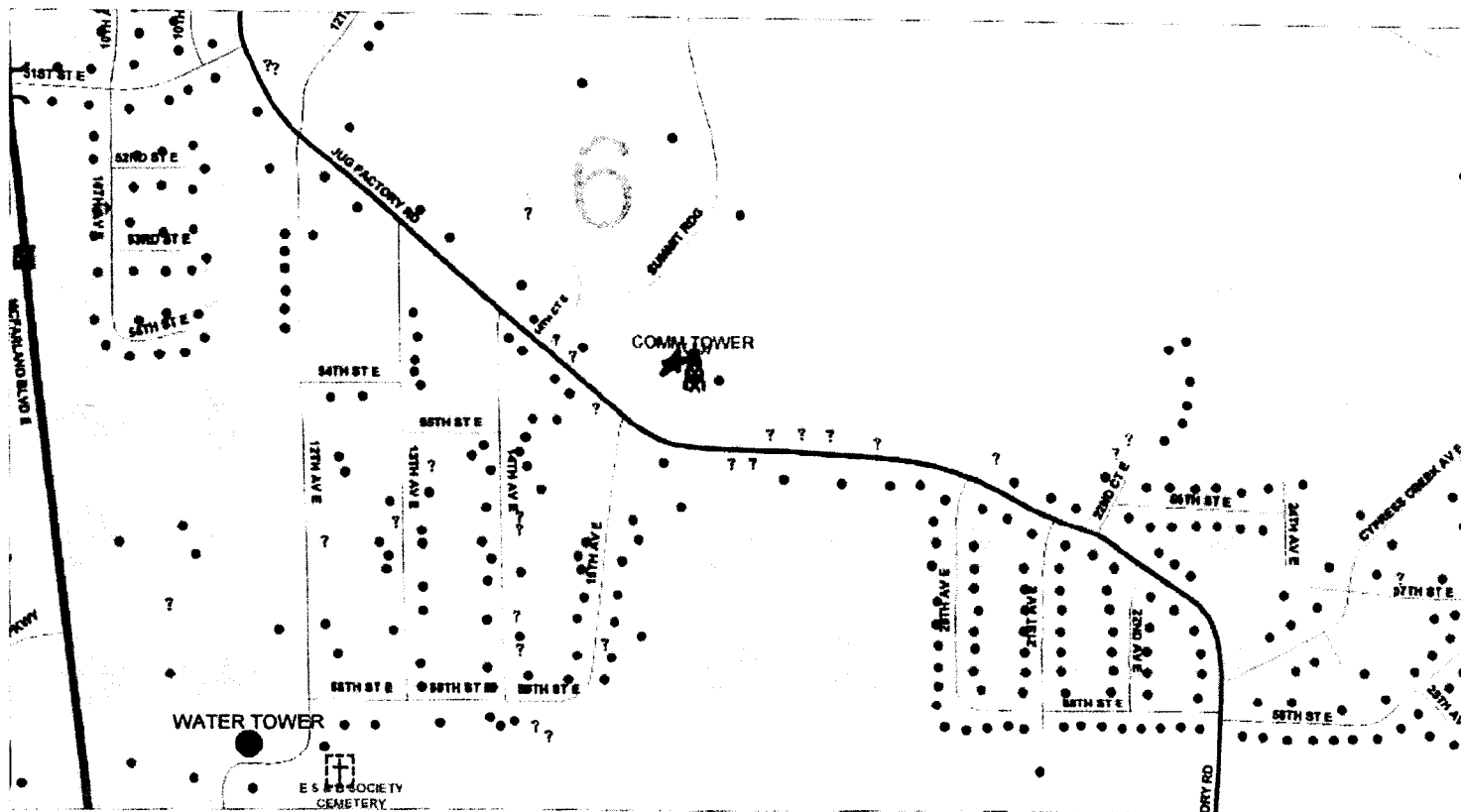

GOODWATER ROAD
TOWER SITE
PERIMETER FENCE

33 30.427

87 26.038

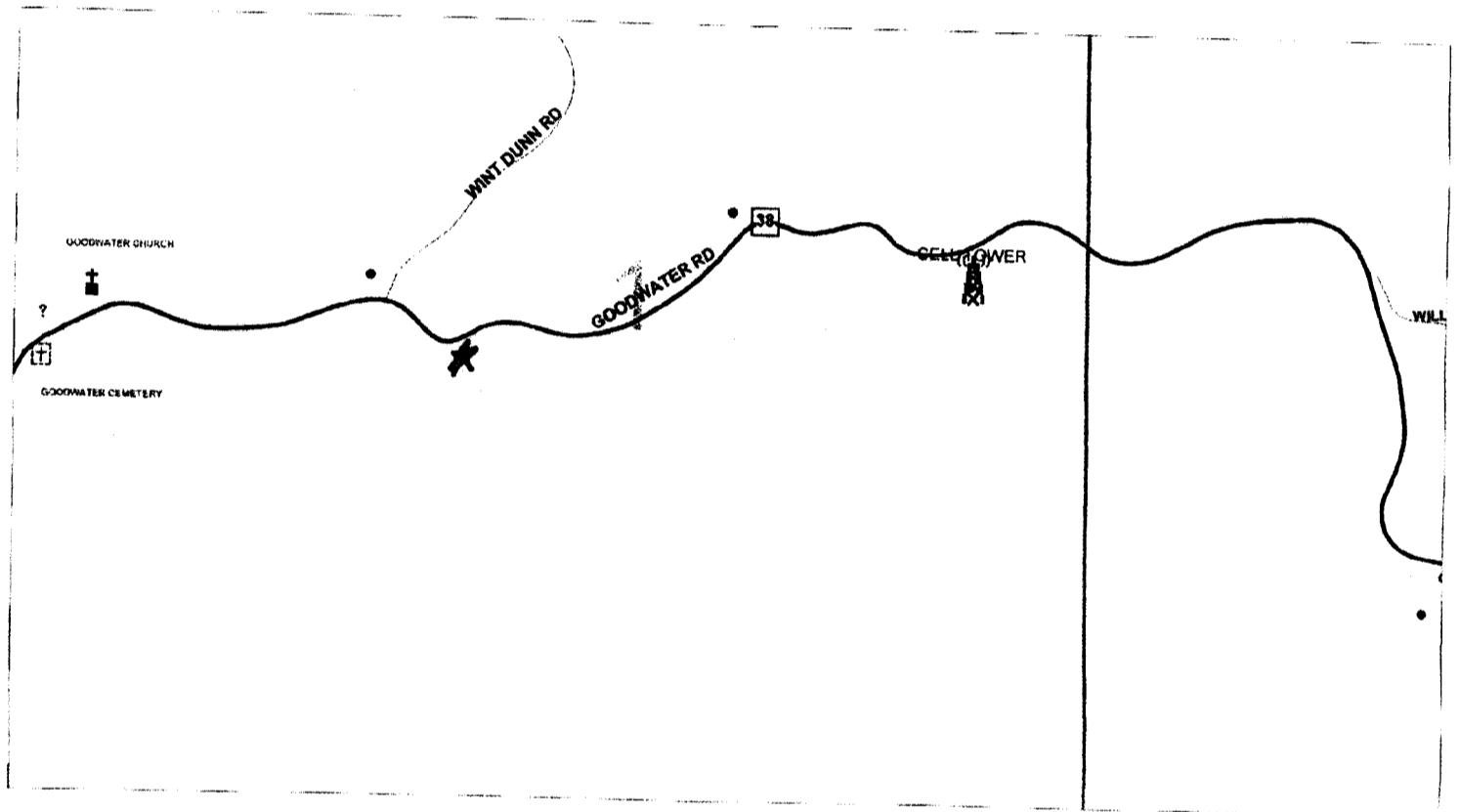

HARGROVE ROAD PIPE YARD
PERIMETER FENCE
33 10.676 87 30.259

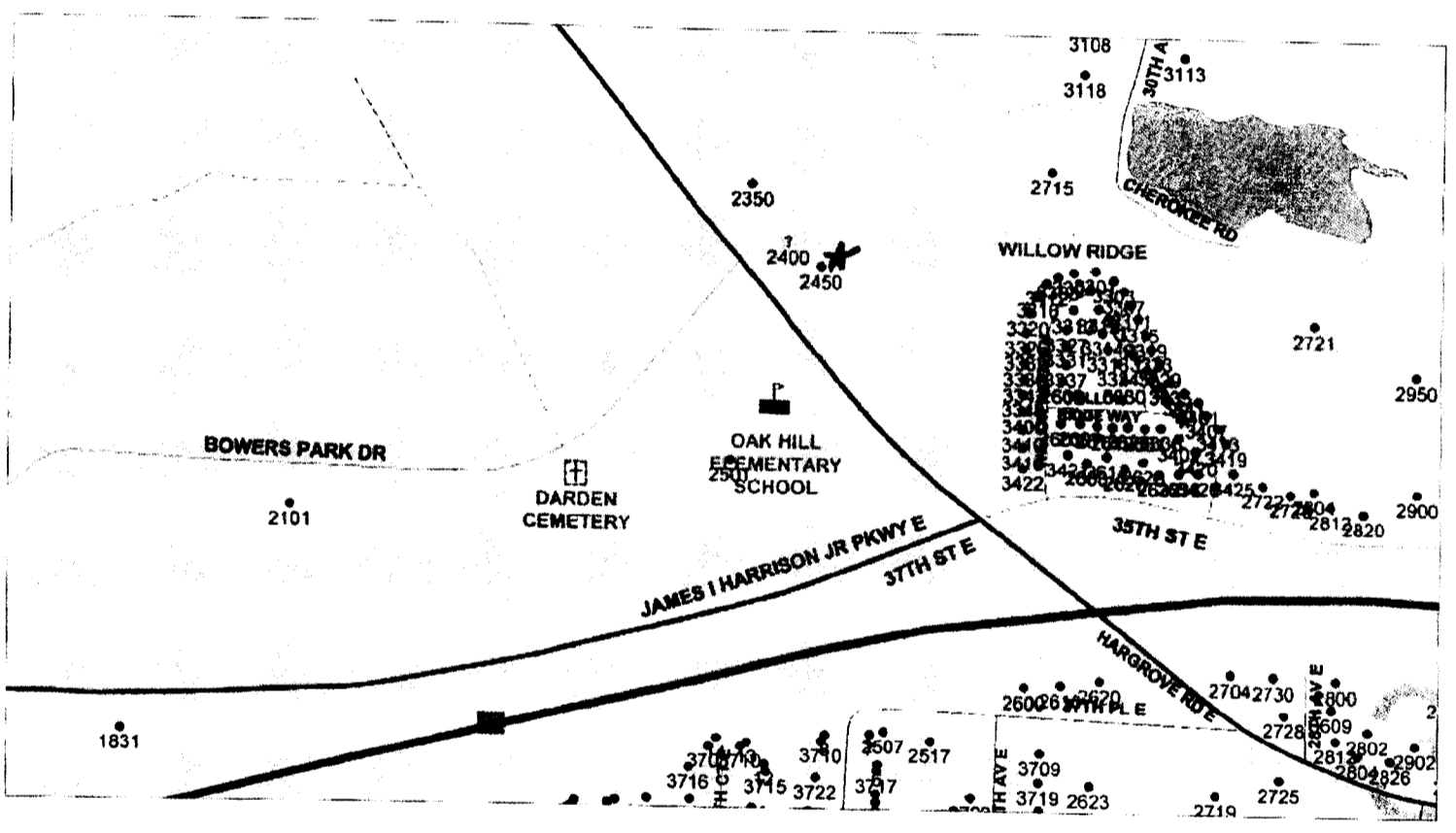

37th STREET STORAGE AREA
PERIMETER FENCE/PARKING LOT
3310.540 B7 31.288

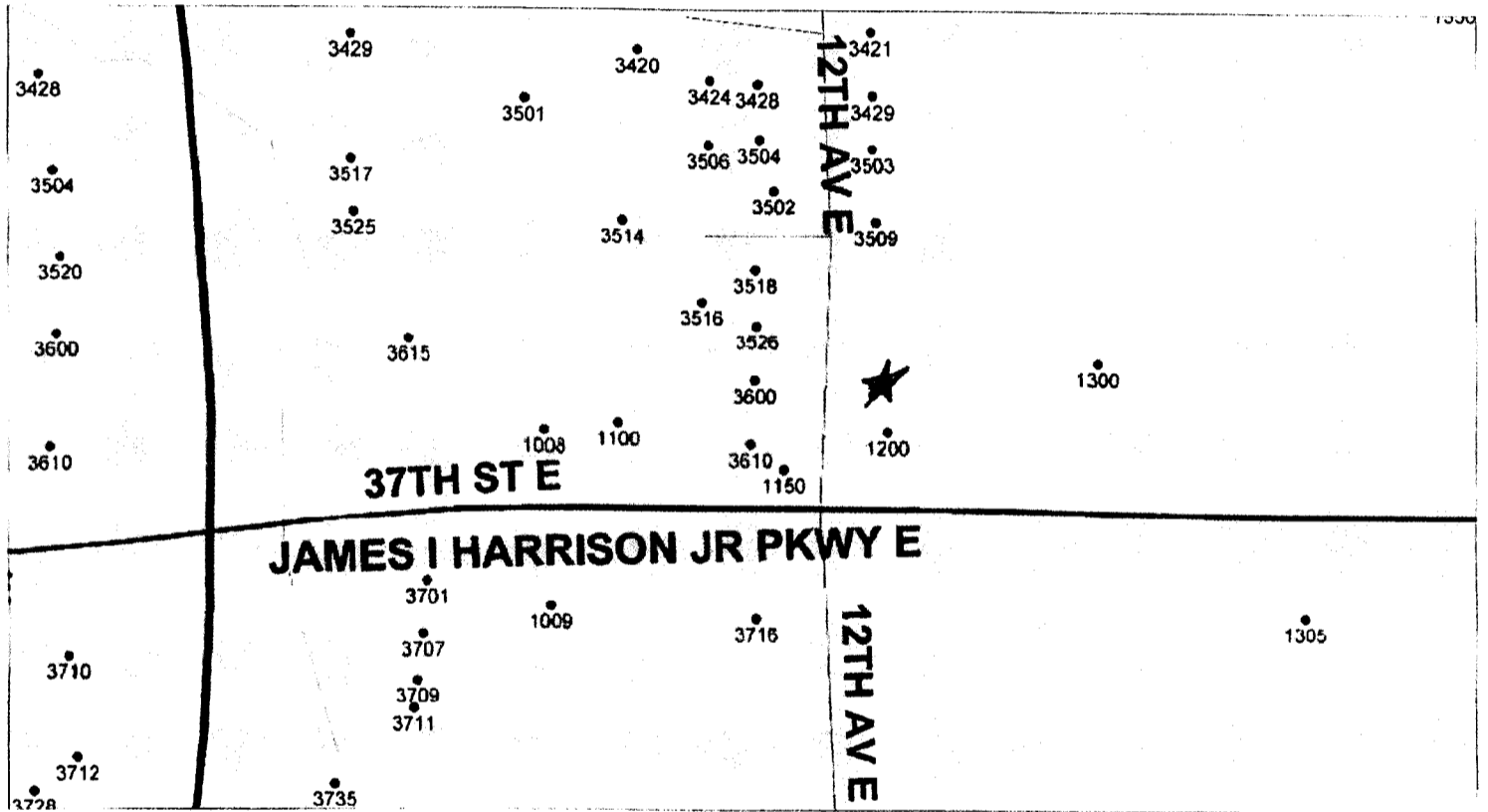

SHERIFF'S DEPARTMENT ANNEX

AT TANNEHILL

PERIMETER AREA

33 16.791

87 05.919

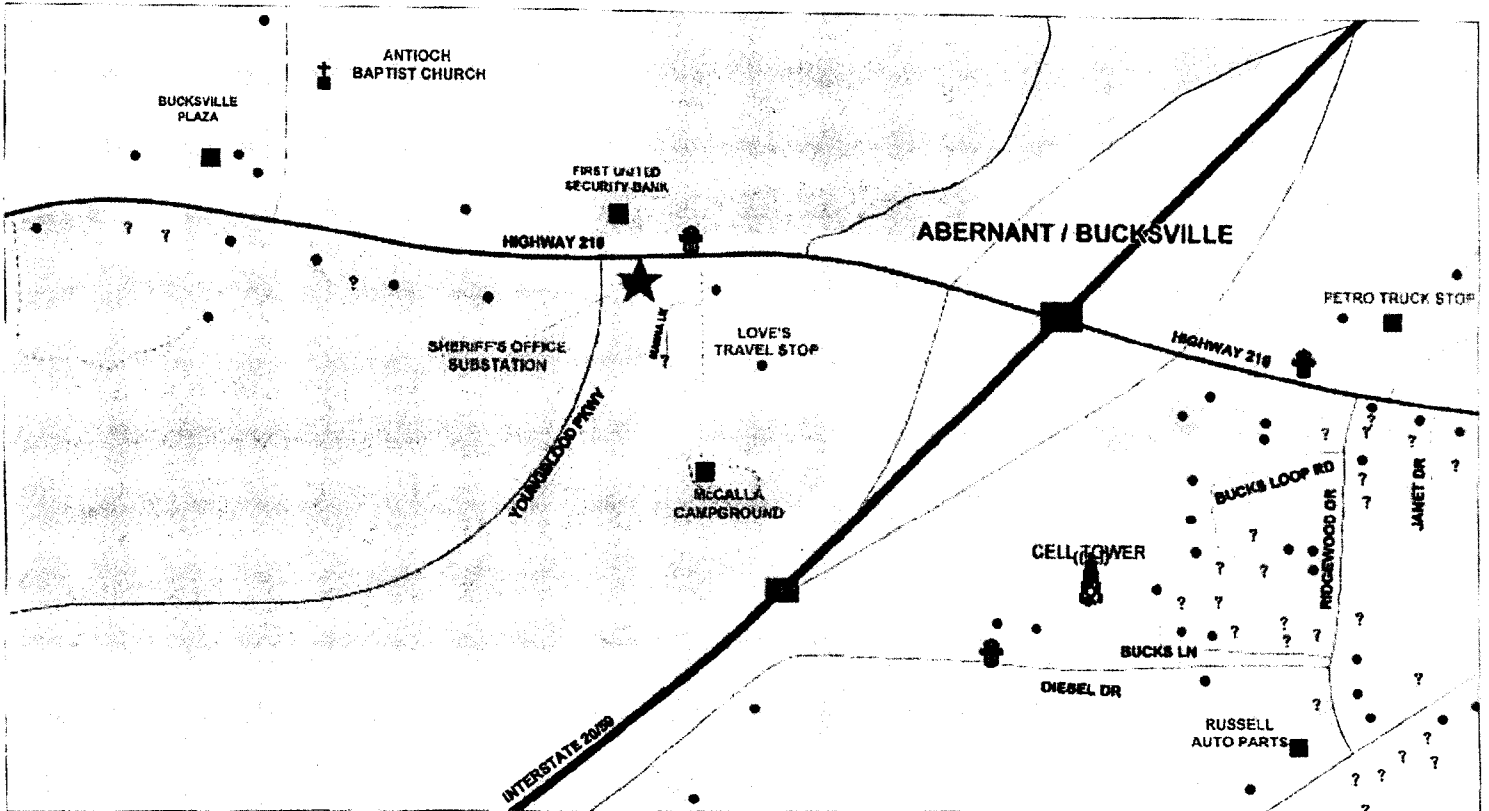

HARGROVE ROAD
KUDZU CONTROL
SLOPES BEHIND GUARDRAIL
33 09.888 87 28.678

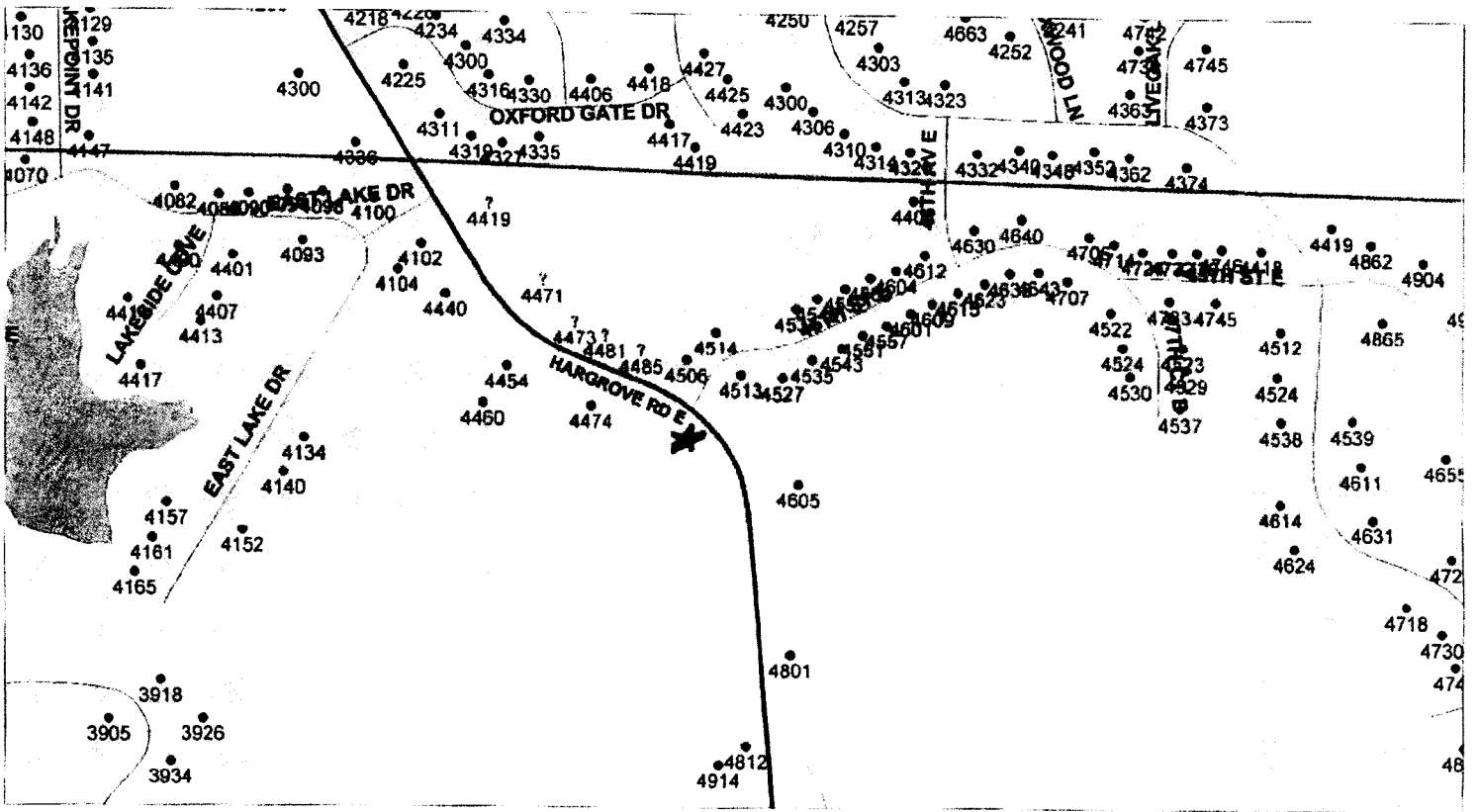

March 19, 2014

Tuscaloosa County Commission
714 Greensboro Avenue, Suite G78
Tuscaloosa, AL 35401

Edko, LLC
Ted Kapera
P. O. Box 1577
Tuscaloosa, AL 35403

Bid Number: 20140224001

Project: Herbicide Application Services on County Roads, Bridges, and Other Specified Locations.

Bid Bond: Attached

Insurance Certificate: Attached

Equipment List: Attached

Company Officers: Attached

Personnel List and Licenses: Attached

Experience:

We have 42 years experience in similar projects.

- | | |
|----------------------------|-----------------------------|
| 1. Caddo Parish Commission | Roadside, Mowing & Drainage |
| P. O. Box 1127 | Robert Glass |
| Shreveport, LA 71163 | 318-226-6930 |
| \$318,000.00 | Completed: 12/13 |

- | | |
|---|---|
| <p>2. Tuscaloosa County Commission
 2810 35th Street
 Tuscaloosa, AL 35401
 \$204,889.69</p> | <p>County Roads, Gravel Roads,
 Curb & Gutter, Bridge & Special
 County Sites
 Mike Henderson
 205-345-6600
 Completed: 12/13</p> |
| <p>3. Warren County
 200 County Lane
 Vicksburg, MS 39180
 \$112,000.00</p> | <p>Selective Weed Control
 Richard Winans
 601-636-1431
 Completed: 12/13</p> |

* There were NO claims, disputes or litigations by or against the contractor for any of the projects.

Percent of Work:

We will perform 100% of the work with forces and equipment under our direct supervision and control.

Project Supervisor:

Ted Kapera

Ted has a Bachelors of Science degree in Business from Northeast Louisiana University and has been applying herbicides for 35 years.

Projects: 2009 - Tuscaloosa County Commission
 2010 - Tuscaloosa County Commission
 2011 - Tuscaloosa County Commission
 2012 - Tuscaloosa County Commission
 2013 - Tuscaloosa County Commission

Additional Requirements:

Edko, LLC
10500 Technology Drive
Cottondale, AL 35453
(205) 507-0724

E-Verify Affidavit:

Attached

Labels and MSDS:

Attached

STATE OF ALABAMA)

TUSCALOOSA COUNTY)

BID BOND TO THE COUNTY OF TUSCALOOSA, ALABAMA

KNOW ALL MEN BY THESE PRESENTS, that we, the undersigned, Edko, LLC

_____ , as Principal;

and Aspen American Insurance Company , as Surety (NOTE: If cashier's check drawn on an Alabama bank utilized in lieu of corporate surety, attach check as required by bid documents) are hereby held and firmly bound unto the County of Tuscaloosa, Alabama, as obligee, hereinafter called the County, in the sum of Five Percent of Amount Bid Dollars

(\$ 5%) for payment of which sum, well and truly to be made, the said Principal and Surety hereby jointly and severally bind ourselves, our heirs, executors, administrators, successors, and assigns.

The condition of the above obligation is such that whereas the Principal has submitted to the County a certain Bid (Proposal), attached hereto and made a part hereof, to enter into a contract in writing with the County, for the following project/bid item or portion thereof:

Project/Bid Item: Bid Number: 20140224001 - Herbicide Application Services on County Roads, Bridges and Other Specified Locations

NOW, THEREFORE,

(a) If said Bid shall be rejected, or in the alternate,

(b) If said Bid shall be awarded and the Principal shall execute and deliver Performance Bond in the Forms as attached to the Bid Documents executed by a surety company authorized and qualified to make such bonds in the State of Alabama and in the amounts required by the Instructions to Bidders shall in all perform the agreement created by the acceptance of said bid within ten (10) days after the prescribed forms have been presented to Bidder for execution; Then, this obligation shall be void, otherwise, the same shall remain in full force and effect; it being expressly understood and agreed that liability for the Surety for any and all default of the Principal hereunder shall be the amount of this obligation as herein stated.

The Surety, for value received, hereby stipulates and agrees that the obligations of said Surety and its bond shall in no way be impaired or affected by any extensions of the time within which the County may accept such bid; and said Surety does hereby waive notice of any such extension.

IN WITNESS WHEREOF, the above-bonded parties have executed this instrument under their several seals, this the 13th day of March, 2014, the name and corporate representative, pursuant to authority of its governing body.

WITNESS:PRINCIPAL: Edko, LLC

Bonnie Taylor

(SEAL)

By: Ted Kapera

Title: Regional Sales Manager

Address: 10500 Technology Drive
Cottondale, AL 35453

SURETY:

Aspen American Insurance Company (SEAL)

175 Capital Boulevard, Suite 300
Rocky Hill, CT 06067

(Business Address)

ATTEST:By: Anna Childress

Evondia H. Woessner

Title: Evondia H. Woessner, Attorney-in-Fact

Attorney in fact



Aspen American Insurance Company
175 Capital Boulevard, Rocky Hill, CT 06067

POWER OF ATTORNEY

KNOW ALL PERSONS BY THESE PRESENTS, THAT Aspen American Insurance Company, a corporation duly organized under the laws of the State of Texas, and having its principal offices in Rocky Hill, Connecticut, (hereinafter the "Company") does hereby make, constitute and appoint: Ronald B. Gladrich; Mark W. Edwards II, Jeffrey M. Wilson, Evondia H. Woessner, William Milton Smith, Alisa B. Ferris, Robert R. Free of McGriff Seibels & Williams, Inc. its true and lawful Attorney(s)-in-Fact, with full power and authority hereby conferred to sign, execute and acknowledge on behalf of the Company, at any place within the United States, the following instrument(s) by his/her sole signature and act: any and all bonds, recognizances, and other writings obligatory in the nature of a bond, recognizance, or conditional undertaking and any and all consents incident thereto, and to bind the Company thereby as fully and to the same extent as if the same were signed by the duly authorized officers of the Company. All acts of said Attorney(s)-in-Fact done pursuant to the authority herein given are hereby ratified and confirmed.

This appointment is made under and by authority of the following Resolutions of the Board of Directors of said Company effective on April 7, 2011, which Resolutions are now in full force and effect;

VOTED: All Executive Officers of the Company (including the President, any Executive, Senior or Assistant Vice President, any Vice President, any Treasurer, Assistant Treasurer, or Secretary or Assistant Secretary) may appoint Attorneys-in-Fact to act for and on behalf of the Company to sign with the Company's name and seal with the Company's seal, bonds, recognizances, and other writings obligatory in the nature of a bond, recognizance, or conditional undertaking, and any of said Executive Officers at any time may remove any such appointee and revoke the power given him or her.

VOTED: The foregoing authority for certain classes of officers of the Company to appoint Attorneys-in-Fact by virtue of a Power of Attorney to sign and seal bonds, recognizances, and other writings obligatory in the nature of a bond, recognizance, or conditional undertaking, as well as to revoke any such Power of Attorney, is hereby granted specifically to the following individual officers of Aspen Specialty Insurance Management, Inc.:

Michael Toppi, Executive Vice President, Scott Sadowsky, Senior Vice President, Kevin W. Gillem, Senior Vice President, Mathew Raino, Vice President, and Ryan Field, Assistant Vice President.

This Power of Attorney may be signed and sealed by facsimile (mechanical or printed) under and by authority of the following Resolution voted by the Boards of Directors of Aspen American Insurance Company, which Resolution is now in full force and effect:

VOTED: That the signature of any of the Officers identified by title or specifically named above may be affixed by facsimile to any Power of Attorney for purposes only of executing and attesting bonds and undertakings and other writings obligatory in the nature thereof, and any and all consents incident thereto, and any such Power of Attorney or certificate bearing such facsimile signature or facsimile seal shall be valid and binding upon the Company. Any such power so executed and certified by such facsimile signature and/or facsimile seal shall be valid and binding upon the Company with respect to any bond or undertaking so executed.

IN WITNESS WHEREOF, Aspen American Insurance Company has caused this instrument to be signed and its corporate seal to be hereto affixed this 2nd day of January, 2014.

STATE OF CONNECTICUT

SS. ROCKY HILL

COUNTY OF HARTFORD

Aspen American Insurance Company

Ryan Field, Assistant Vice President

On this 2nd day of January, 2014 before me personally came Ryan Field to me known, who being by me duly sworn, did depose and say; that he/she is Assistant Vice President, of Aspen American Insurance Company, the Company described in and which executed the above instrument; that he/she knows the seal of said corporation; that the seal affixed to the said instrument is such corporate seal; and that he/she executed the said instrument on behalf of the Company by authority of his/her office under the above Resolutions thereof.

Patricia C. Taber
Notary Public

My commission expires: May 31, 2016

CERTIFICATE

I, the undersigned, Ryan Field of Aspen American Insurance Company, a stock corporation of the State of Texas, do hereby certify that the foregoing Power of Attorney remains in full force and has not been revoked; and furthermore, that the Resolutions of the Boards of Directors, as set forth above, are now and remain in full force and effect.

Given under my hand and seal of said Company, in Rocky Hill, Connecticut, this 13 day of March, 2014

By:

Name: Ryan Field, Assistant Vice President



* For verification of the authenticity of the Power of Attorney you may call (860) 760-7728 or email: Patricia.Taber@aspen-insurance.com

Attached is a current certificate of insurance. If Edko, LLC is the successful bidder, we will submit a revised certificate to include required endorsements and additional insured language.

Edko, LLC
P.O. Box 1577
Tuscaloosa, AL 35403
205-507-0724



CERTIFICATE OF LIABILITY INSURANCE

DATE (MM/DD/YYYY)
10/16/2013

THIS CERTIFICATE IS ISSUED AS A MATTER OF INFORMATION ONLY AND CONFERS NO RIGHTS UPON THE CERTIFICATE HOLDER. THIS CERTIFICATE DOES NOT AFFIRMATIVELY OR NEGATIVELY AMEND, EXTEND OR ALTER THE COVERAGE AFFORDED BY THE POLICIES BELOW. THIS CERTIFICATE OF INSURANCE DOES NOT CONSTITUTE A CONTRACT BETWEEN THE ISSUING INSURER(S), AUTHORIZED REPRESENTATIVE OR PRODUCER, AND THE CERTIFICATE HOLDER.

IMPORTANT: If the certificate holder is an ADDITIONAL INSURED, the policy(ies) must be endorsed. If SUBROGATION IS WAIVED, subject to the terms and conditions of the policy, certain policies may require an endorsement. A statement on this certificate does not confer rights to the certificate holder in lieu of such endorsement(s).

PRODUCER MCGRIFF, SEIBELS & WILLIAMS, INC. P.O. Box 10265 Birmingham, AL 35202	CONTACT NAME:	
	PHONE (A/C, No, Ext): 800-476-2211	FAX (A/C, No):
INSURED Edko, LLC P.O. Box 7241 Shreveport, LA 71137	E-MAIL ADDRESS:	
	INSURER(S) AFFORDING COVERAGE	
	INSURER A: Valley Forge Insurance Company	NAIC # 20508
	INSURER B: National Fire Insurance Company of Hartford	20478
	INSURER C: Continental Casualty Company	20443
	INSURER D:	
INSURER E:		
INSURER F:		

COVERAGES CERTIFICATE NUMBER: 8HAU8LCK REVISION NUMBER:

THIS IS TO CERTIFY THAT THE POLICIES OF INSURANCE LISTED BELOW HAVE BEEN ISSUED TO THE INSURED NAMED ABOVE FOR THE POLICY PERIOD INDICATED. NOTWITHSTANDING ANY REQUIREMENT, TERM OR CONDITION OF ANY CONTRACT OR OTHER DOCUMENT WITH RESPECT TO WHICH THIS CERTIFICATE MAY BE ISSUED OR MAY PERTAIN, THE INSURANCE AFFORDED BY THE POLICIES DESCRIBED HEREIN IS SUBJECT TO ALL THE TERMS, EXCLUSIONS AND CONDITIONS OF SUCH POLICIES. LIMITS SHOWN MAY HAVE BEEN REDUCED BY PAID CLAIMS.

INSR LTR	TYPE OF INSURANCE	ADDL INSR	SUBR WVD	POLICY NUMBER	POLICY EFF (MM/DD/YYYY)	POLICY EXP (MM/DD/YYYY)	LIMITS
A	GENERAL LIABILITY <input checked="" type="checkbox"/> COMMERCIAL GENERAL LIABILITY <input type="checkbox"/> CLAIMS-MADE <input checked="" type="checkbox"/> OCCUR <input checked="" type="checkbox"/> CG 2264 GEN'L AGGREGATE LIMIT APPLIES PER: <input type="checkbox"/> POLICY <input checked="" type="checkbox"/> PROJECT <input type="checkbox"/> LOC			U2025791535 Pesticide or Herbicide Applicator	11/01/2013	11/01/2014	EACH OCCURRENCE \$ 1,000,000 DAMAGE TO RENTED PREMISES (Ea occurrence) \$ 100,000 MED EXP (Any one person) \$ 5,000 PERSONAL & ADV INJURY \$ 1,000,000 GENERAL AGGREGATE \$ 2,000,000 PRODUCTS - COM/POP AGG \$ 2,000,000
A	AUTOMOBILE LIABILITY <input checked="" type="checkbox"/> ANY AUTO <input type="checkbox"/> ALL OWNED AUTOS <input checked="" type="checkbox"/> HIRED AUTOS <input type="checkbox"/> SCHEDULED AUTOS <input checked="" type="checkbox"/> NON-OWNED AUTOS			C4022271791	11/01/2013	11/01/2014	COMBINED SINGLE LIMIT (Ea accident) \$ 1,000,000 BODILY INJURY (Per person) \$ BODILY INJURY (Per accident) \$ PROPERTY DAMAGE (Per accident) \$
C	UMBRELLA LIAB <input checked="" type="checkbox"/> EXCESS LIAB DED RETENTION \$			C4019470551	11/01/2013	11/01/2014	EACH OCCURRENCE \$ 5,000,000 AGGREGATE \$ 5,000,000
B	WORKERS COMPENSATION AND EMPLOYERS' LIABILITY ANY PROPRIETOR/PARTNER/EXECUTIVE OFFICER/MEMBER EXCLUDED? (Mandatory in NH) If yes, describe under DESCRIPTION OF OPERATIONS below			WC1055492377	11/01/2013	11/01/2014	<input checked="" type="checkbox"/> WC STATUTORY LIMITS <input type="checkbox"/> OTHER E.L. EACH ACCIDENT \$ 1,000,000 E.L. DISEASE - EA EMPLOYEE \$ 1,000,000 E.L. DISEASE - POLICY LIMIT \$ 1,000,000

DESCRIPTION OF OPERATIONS / LOCATIONS / VEHICLES (Attach ACORD 101, Additional Remarks Schedule, if more space is required)

CERTIFICATE HOLDER Tuscaloosa County Commission P.O. Box 20113 Tuscaloosa, AL 35402	CANCELLATION SHOULD ANY OF THE ABOVE DESCRIBED POLICIES BE CANCELLED BEFORE THE EXPIRATION DATE THEREOF, NOTICE WILL BE DELIVERED IN ACCORDANCE WITH THE POLICY PROVISIONS.
	AUTHORIZED REPRESENTATIVE

VEHICLE AND EQUIPMENT LISTING

<u>MAKE & MODEL</u>	<u>VEHICLE & EQUIPMENT #</u>	<u>PUMP & TANKS</u>
2000 INTERNATIONAL 4700	001	ROADSIDE SPRAYER 1,850 GAL. CAPACITY COMPUTER CONTROLLED INJECTION RIG 2,000 FT. OF SPRAY HOSE
2001 FORD SUPER-DUTY F-650	016	ROADSIDE & HANDSPRAY 1,470 GAL. CAPACITY 140 GPM CENTRIFUGAL PUMP – INJECTION COMPUTER CONTROLLED 1,000 FT. OF SPRAY HOSE
2001 FORD SUPER-DUTY F-750	019	ROADSIDE SPRAYER 1,850 GAL. CAPACITY COMPUTER CONTROLLED 2,000 FT. OF SPRAY HOSE
2008 FORD SUPER-DUTY F-550	802	ROADSIDE & HANDSPRAY DICKY-JOHN SYSTEM WITH RADAR SPEED SENSOR & 20 GPM PISTON PUMP 700 GAL. CAPACITY & 1,000 FT. OF SPRAY HOSE
1998 INTERNATIONAL 4700 LP	984	ROADSIDE SPRAYER 800 GAL. CAPACITY COMPUTER CONTROLLED 2,000 FT. OF SPRAY HOSE
1999 INTERNATIONAL 4700	991	ROADSIDE & HANDSPRAY 1,500 GAL. CAPACITY MID-TECH & RADAR- CONTROL INJECTION SYSTEM
1999 INTERNATIONAL 4700	994	ROADSIDE SPRAYER 1,850 GAL. CAPACITY COMPUTER CONTROLLED INJECTION RIG 2,000 FT. OF SPRAY HOSE

2014 INTERNATIONAL	1401	ROADSIDE SRAYER 700 GAL. CAPACITY MID-TECH & COMPUTER CONTROL & 20 GPM PISTON PUMP 1000 FT. SPRAY HOSE
2000 KUBTOA TRACTOR M5400	420	200 GAL. CAPACITY STANDRAD – 500 FT. OF SPRAY HOSE
2005 KUBOTA MULE 4X4 DIESEL RTV 900 VEHICLE	505	100 GAL. CAPACITY CENTRIFUGAL HYDRAULIC PUMP – 100 FT. OF SPRAY HOSE
2006 KUBOTA TRACTOR L2800	603	110 GAL. CAPACITY STANDARD – 250 FT. OF SPRAY HOSE

Edko, LLC

State of Alabama Licenses, Permits and Employee List

State of Alabama Contractor's License Number 46682

State of Alabama Professional Services Permit Number 2013058592

Alabama Custom Pesticide Applicator's License Number 2013058505

Alabama Department of Environmental Management – National Pollutant Discharge Elimination System Permit – General Permit Number ALG870004

City of Northport Business License Number 201400592

City of Tuscaloosa Business License Number 236200

<u>Supervisor:</u>	<u>Certification #</u>	<u>Years Experience</u>
Thaddeus (Ted) Kapera 10731 Cobblestone Dr. Cottondale, AL 35453 (205) 792-8800	10317	35
Alex J. Smalling 223 Winter Park Drive West Monroe, LA 71292 (318) 396-3539	14393	18
<u>Applicators:</u>		
David W. Green 8772 Millhaven Rd. Monroe, LA 71203 (318) 343-2365	14467	17
Levi T. Haynes 211 County Rd. 607 Hanceville, AL 35077 (256) 708-1217	16359	6

Troy Hughey 214 Second Avenue North Centreville, AL 35042 (205) 826-3693	16128	3
Page 1 of 2 Zakary K. Ivey 81 County Rd. 407 Cullman, AL 35057 (256) 339-4750	16358	3
Clinton G. Morgan 1100 County Rd. 401 Cullman, AL 35057 (256) 339-5483	15650	3
Donald J. Plowman 3240 Zion Road Gordo, AL 35466 (205) 364-7896	04291	15
Allen J. Schiehl 1324 5 th Street SE Cullman, AL 35055 (256) 531-3557	16368	2
Vincent Ray Sylvestri P. O. Box 13131 Mornoe, LA 71213-3131 (318) 614-8226	14328	14
Daniel Brian Tekulve 252 County Rd. 1296 Cullman, AL 35058 (256) 708-7011	11477	6

STATE OF ALABAMA

BID LIMIT: **U**
AMOUNT: **UNLIMITED**

LICENSE NO.: **46682**
TYPE: **RENEWAL**



State Licensing Board for General Contractors

THIS IS TO CERTIFY THAT

EDKO, LLC

SHREVEPORT, LA 71137

is hereby licensed a General Contractor in the State of Alabama and is authorized to perform the following type(s) of work:

MU-S: ROW MAINTENANCE

until **September 30, 2014** when this Certificate expires.

Witness our hands and seal of the Board, dated Montgomery, Ala.,

96129

[Signature]

1st day of **September, 2013**
SECRETARY-TREASURER

[Signature]
CHAIRMAN

DEPARTMENT OF AGRICULTURE AND INDUSTRIES

STATE OF

ALABAMA

2013058592



ALABAMA PERMIT FOR PROFESSIONAL SERVICES

Amount: \$175.00

Penalty:

PSH-16811

THIS IS TO CERTIFY THAT

EDKO LLC
10500 Technology Drive
COTTONDALE AL 35453

IS IN FULL COMPLIANCE WITH ALL APPLICABLE ALABAMA STATUTES AND IS AUTHORIZED TO ENGAGE IN THE ACTIVITIES AND PRACTICES PROVIDED FOR THEREIN.

ISSUED AT MONTGOMERY ALABAMA ON 8 /13/2013

THIS CERTIFICATE EXPIRES SEPTEMBER 30, 2014 UNLESS PREVIOUSLY REVOKED.

THADDEUS KAPERA - OTPS

A handwritten signature in black ink, appearing to read "Joe DeBrow".

JOE DEBROW JR
PROGRAM DIRECTOR

John McMillan
Commissioner Of Agriculture And Industries

DEPARTMENT OF AGRICULTURE AND INDUSTRIES

STATE OF



ALABAMA

2013058505

CUSTOM PESTICIDE APPLICATOR'S LICENSE

P/M-18961

Amount: \$100.00

Penalty:

THIS IS TO CERTIFY THAT

EDKO LLC
10500 Technology Drive
COTTONDALE AL 35453

IS IN FULL COMPLIANCE WITH ALL APPLICABLE ALABAMA STATUTES AND IS AUTHORIZED TO ENGAGE IN THE ACTIVITIES AND PRACTICES PROVIDED FOR THEREIN.

ISSUED AT MONTGOMERY ALABAMA ON 12/6 /2013

THIS CERTIFICATE EXPIRES DECEMBER 31, 2014 UNLESS PREVIOUSLY REVOKED.

THADDEUS J KAPERA

Handwritten signature of Tony L. Cofer in black ink.

TONY L COFER
DIVISION DIRECTOR

John McMillan
Commissioner Of Agriculture And Industries

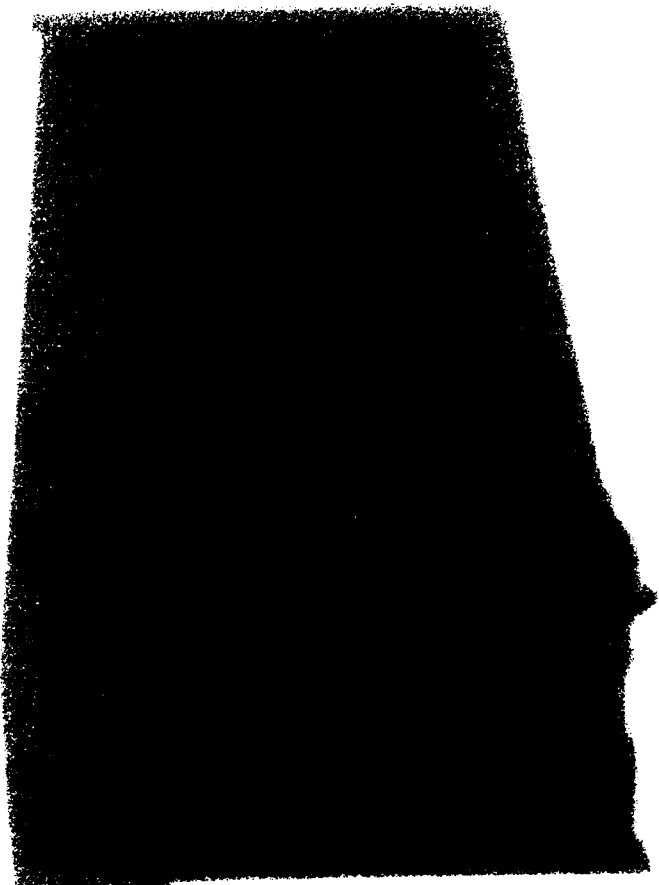

0923

VEHICLES

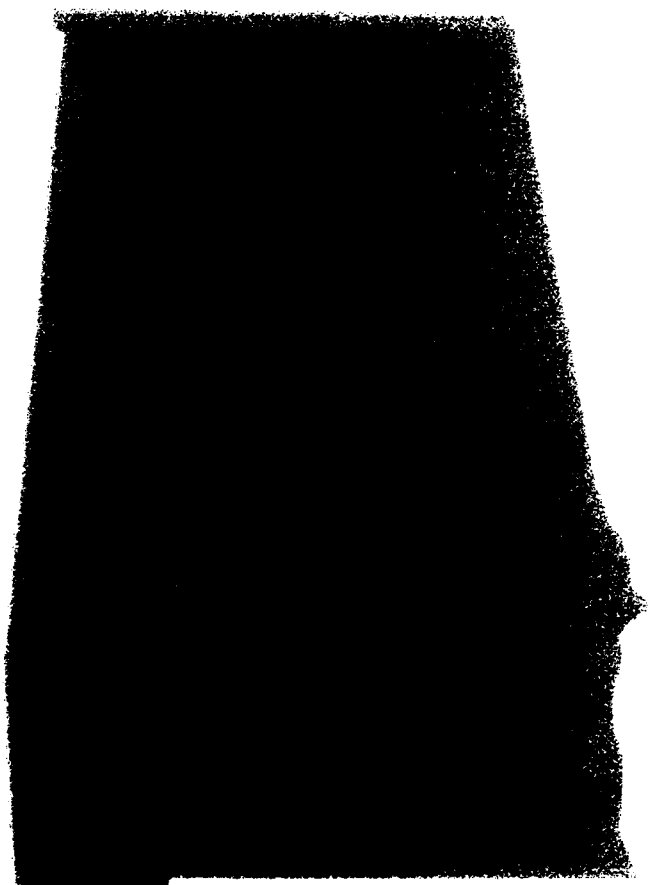

0924

EQUIPMENT

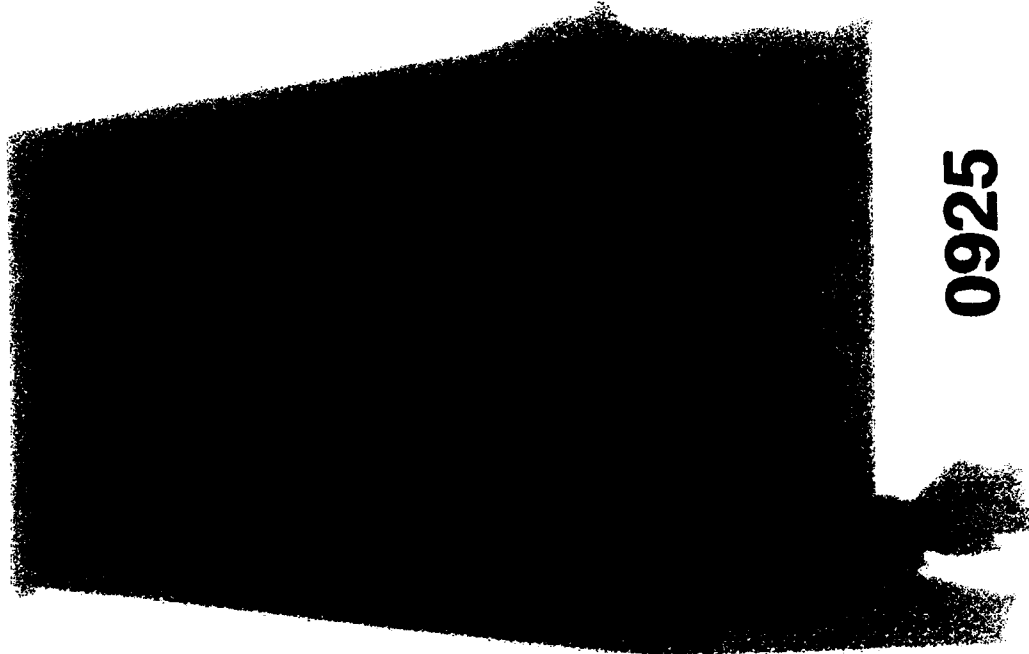

0925

TRAILERS



NATIONAL POLLUTANT DISCHARGE ELIMINATION SYSTEM PERMIT GENERAL PERMIT

DISCHARGE AUTHORIZED: DISCHARGES FROM THE APPLICATION OF PESTICIDES

AREA OF COVERAGE: THE STATE OF ALABAMA

PERMIT NUMBER: ALG870004

RECEIVING WATERS: ALL WATERS OF THE STATE OF ALABAMA

In accordance with and subject to the provisions of the Federal Water Pollution Control Act, as amended, 33 U.S.C. §§1251-1378 (the "FWPCA"), the Alabama Water Pollution Control Act, as amended, Code of Alabama 1975, §§ 22-22-1 to 22-22-14 (the "AWPCA"), the Alabama Environmental Management Act, as amended, Code of Alabama 1975, §§22-22A-1 to 22-22A-15, and rules and regulations adopted thereunder, and subject further to the terms and conditions set forth in this permit, the Permittee is hereby authorized to discharge into the above-named receiving waters.

ISSUANCE DATE: October 31, 2011

EFFECTIVE DATE: October 31, 2011

EXPIRATION DATE: October 30, 2016

Glenda L. Dean

Alabama Department of Environmental Management

LANCE R. LEFLEUR
DIRECTOR



ROBERT J. BENTLEY
GOVERNOR

Alabama Department of Environmental Management
adem.alabama.gov

1400 Coliseum Blvd. 36110-2400 ■ Post Office Box 301463
Montgomery, Alabama 36130-1463
(334) 271-7700 ■ FAX (334) 271-7950

FEB 15 2012

TED KAPERA
EDKO, LLC
P.O. BOX 1577
TUSCALOOSA, AL 35403

RE: Edko, LLC
Statewide (999)

Dear Mr. Kapera:

Based on your request, coverage under **General NPDES Permit Number ALG870004** is granted. The effective date of coverage is March 1, 2012.

Coverage under this permit does not authorize the discharge of any pollutant or wastewater that is not specifically identified in the permit and by the Notice of Intent.

You are responsible for compliance with all provisions of the permit including, but not limited to, the performance of required monitoring, and the development and implementation of a Pesticide Discharge Management Plan (PDMP) required by the permit.

The Alabama Department of Environmental Management encourages you to exercise pollution prevention practices and alternatives at your facility. Pollution prevention will assist you in complying with permit requirements.

A copy of the General NPDES Permit under which coverage of your discharges has been granted is enclosed. If you have any questions concerning this permit, please contact Rachael Saucer by email at rlsaucer@adem.state.al.us or by phone at (334) 274-4238.

Sincerely,

A handwritten signature in black ink that reads "Glenda L. Dean".

Glenda L. Dean, Chief
Water Division

GLD/rls

Enclosure: Permit

File: NOI/

Birmingham Branch
110 Vulcan Road
Birmingham, AL 35203-4700

Decatur Branch
2715 Sandlin Road, S.W.
Decatur, AL 35603-1233

Mobile Branch
2204 Perimeter Road
Mobile, AL 36615-1131

Mobile-Coastal
4171 Commanders Drive
Mobile, AL 36615-1412

PESTICIDE APPLICATOR PERMIT



Alabama

Department of
**AGRICULTURE &
INDUSTRIES**

Richard Beard Building
1445 Federal Drive
Montgomery, AL 36107

Food Safety & Consumer Division - Pesticide Management
Phone (334) 240-7240 or 240-7241 Fax (334) 240-7168
www.agi.alabama.gov/pesticide_management

This is to attest that
KAPERA, THADDEUS J
is certified as a
Commercial Applicator

Categories: AQ; GRD;
OTPS; ROW;
Expires: 4/28/2015
Permit Number: 10317



PESTICIDE APPLICATOR PERMIT



Alabama

Department of
**AGRICULTURE &
INDUSTRIES**

Richard Beard Building
1445 Federal Drive
Montgomery, AL 36107

Food Safety & Consumer Division - Pesticide Management
Phone (334) 240-7240 or 240-7241 Fax (334) 240-7168
www.agl.alabama.gov/pesticide_management

This is to attest that
SMALLING, ALEX J
is certified as a
Commercial Applicator

Categories: AQ; GRD;
ROW;
Expires: 1/28/2016
Permit Number: 14393



Sep. 17. 2012 3:50PM

No. 177

PESTICIDE APPLICATOR PERMIT



Department of
AGRICULTURE &
INDUSTRIES

Alabama

Richard Beard Building
1445 Federal Drive
Montgomery, AL 36107

Food Safety & Consumer Division - Pesticide Management
Phone (334) 240-7240 or 240-7241 Fax (334) 240-7166
www.agl.alabama.gov/pesticide_management

This is to attest that
GREEN, DAVID W
is certified as a
Commercial Applicator

Categories: AQ; GRD;

ROW;

Expires: 7/28/2015

Permit Number: 14467



PESTICIDE APPLICATOR PERMIT



ALABAMA

Department of
AGRICULTURE &
INDUSTRIES

Richard Beard Building
1445 Federal Drive
Montgomery, AL 36107

Food Safety & Consumer Division - Pesticide Management
Phone (334) 240-7240 or 240-7241 Fax (334) 240-7168
www.agi.alabama.gov/pesticide_management

This is to attest that
HAYNES, LEVI TODD
is certified as a Commercial Applicator
Categories: GRD; ROW;
Expires: 9/28/2016

Permit Number: **16359**



PESTICIDE APPLICATOR PERMIT



Department of
**AGRICULTURE &
INDUSTRIES**

Alabama

Richard Beard Building
1445 Federal Drive
Montgomery, AL 36107

Food Safety & Consumer Division - Pesticide Management
Phone (334) 240-7240 or 240-7241 Fax (334) 240-7168
www.agi.alabama.gov/pesticide_management

This is to attest that
HUGHEY, TROY
is certified as a
Commercial Applicator

Categories: GRD; ROW;
Expires: 3/28/2016
Permit Number: 16128



PESTICIDE APPLICATOR PERMIT



ALABAMA

Department of
AGRICULTURE &
INDUSTRIES

Richard Beard Building
1445 Federal Drive
Montgomery, AL 36107

Food Safety & Consumer Division - Pesticide Management
Phone (334) 240-7240 or 240-7241 Fax (334) 240-7168
www.agi.alabama.gov/pesticide_management

This is to attest that
IVEY, ZAKARY KERMIT
is certified as a Commercial Applicator
Categories: GRD; ROW;
Expires: 9/28/2016

Permit Number: 16358



PESTICIDE APPLICATOR PERMIT



Alabama

Department of
AGRICULTURE &
INDUSTRIES

Richard Beard Building
1445 Federal Drive
Montgomery, AL 36107

Food Safety & Consumer Division - Pesticide Management
Phone (334) 240-7240 or 240-7241 Fax (334) 240-7168
www.agi.alabama.gov/pesticide_management

This is to attest that
JACKSON III, ANDREW
W
is certified as a
Commercial Applicator

Categories: AQ; GRD;
ROW;

Expires: 3/28/2015

Permit Number: 15704



PESTICIDE APPLICATOR PERMIT



ALABAMA

Department of
AGRICULTURE &
INDUSTRIES

Richard Beard Building
1445 Federal Drive
Montgomery, AL 36107

Food Safety & Consumer Division - Pesticide Management
Phone (334) 240-7240 or 240-7241 Fax (334) 240-7168
www.agi.alabama.gov/pesticide_management

This is to attest that
MORGAN, CLINTON G
is certified as a
Commercial Applicator

Categories: GRD; ROW;
Expires: 2/28/2015

Permit Number: 15650



PESTICIDE APPLICATOR PERMIT

APPLIED FOR



Department of
AGRICULTURE &
INDUSTRIES

Richard Beard Building
1445 Federal Drive
Montgomery, AL 36107

Food Safety & Consumer Division - Pesticide Management
Phone (334) 240-7240 or 240-7241 Fax (334) 240-7168
www.agi.alabama.gov/pesticide_management

This is to attest that
**PLOWMAN, DONALD
JIMMY**
is certified as a
Commercial Applicator

Categories: GRD; ROW;
Expires: 3/26/2014

Permit Number: 10469



PESTICIDE APPLICATOR PERMIT

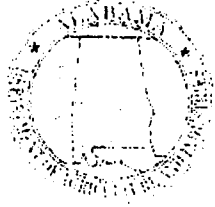

ALABAMA

Department of
AGRICULTURE &
INDUSTRIES

Richard Beard Building
1445 Federal Drive
Montgomery, AL 36107

Food Safety & Consumer Division - Pesticide Management
Phone (334) 240-7240 or 240-7241 Fax (334) 240-7168
www.agi.alabama.gov/pesticide_management

This is to attest that
**SCHIEHL, JAMES
ALLEN**
is certified as a
Commercial Applicator

Categories: GRD: ROW;
Expires: 10/28/2016

Permit Number: 16368



PESTICIDE APPLICATOR PERMIT



Alabama

Department of
AGRICULTURE &
INDUSTRIES

Richard Beard Building
1445 Federal Drive
Montgomery, AL 36107

Food Safety & Consumer Division - Pesticide Management
Phone (334) 240-7240 or 240-7241 Fax (334) 240-7188
www.egi.alabama.gov/pesticide_management

This is to attest that
**SYLVESTRI, VINCENT
RAY**
is certified as a
Commercial Applicator

Categories: AQ; GRD;
ROW;
Expires: 4/28/2015
Permit Number: 14328



PESTICIDE APPLICATOR PERMIT



ALABAMA

Department of
AGRICULTURE &
INDUSTRIES

Richard Beard Building
1445 Federal Drive
Montgomery, AL 36107

Food Safety & Consumer Division - Pesticide Management
Phone (334) 240-7240 or 240-7241 Fax (334) 240-7168
www.agi.alabama.gov/pesticide_management

This is to attest that
**TEKULVE, DANIEL
BRIAN**
is certified as a
Commercial Applicator

Categories: GRD; ROW;
Expires: 4/28/2015

Permit Number: 11477





CITY OF NORTHPORT

2014 LICENSE

THIS LICENSE IS FOR THE SPECIFIED LOCATION - NOT TRANSFERABLE

Mailing Name and Address:

EDKO, LLC
P O BOX 1577

TUSCALOOSA AL 35403

THIS LICENSE EXPIRES :

12/31/2014

Taxpayer ID Number :

12036

Location Number :

1

Date License Issued :

01/16/2014

License Number :

201400592

EDKO, LLC
10500 TECHNOLOGY DRIVE

COTTONDALE AL 35453-

The firm, corporation, organization, business or person whose name appears above has paid the required license fees and is authorized to engage in business in City Of Northport, Alabama as indicated below.

Code	Description
561731	LAWN SERVICE (MOWING)

If business activity is discontinued in City Of Northport, Alabama, notify the Finance Department within 30 days.

Cyndi Herren-Sims

AUTHORIZED SIGNATURE

DATE

LICENSE MUST BE POSTED at specified location.
YOU WILL BE CHARGED PEN. & INT.
IF LICENSE IS NOT RENEWED BY FEB. 15.
Cyndi Herren-Sims, Business License Officer

Scott Callaway

CITY ADMINISTRATOR

LICENSES PAID BY CHECK VOID IF CHECK IS NOT HONORED UPON FIRST PRESENTATION TO BANK

Business License Receipt
EDKO, LLC

FOR CITY OF CITY OF NORTHPORT, ALABAMA

SID: 11252

Code	Description	Amount
561731	LAWN SERVICE (MOWING)	\$146.65

Scott Callaway

Total Discount	\$0.00	Total License(s)	\$146.65
Total Fee 1-5	\$0.00	Total Penalty	\$0.00
Total Issue Fee	\$10.00	Total Interest	\$0.00
		Total Amount Remitted	\$156.65

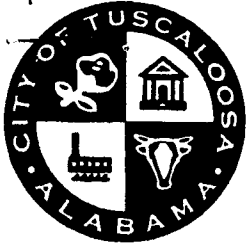

CITY OF TUSCALOOSA

BUSINESS LICENSE

EXPIRES DECEMBER 31, 2014



THIS LICENSE IS NOT TRANSFERABLE
OWNERSHIP CHANGE REQUIRES NEW LICENSE
LOCATION CHANGE REQUIRES APPROVAL

ACCOUNT ID: 126510
ISSUE NO: 560
ISSUE DATE: 01/14/2014

2014

NAICS: 236200
CATEGORY: CONTRACTOR
TYPE: GENERAL

EDKO, LLC
P. O. BOX 1577
TUSCALOOSA, AL 35403

LINDA S. MCKINNEY
DIRECTOR OF REVENUE

WALTER MADDOX
MAYOR

****RENEW BEFORE FEBRUARY 17TH TO AVOID PENALTIES****

BUSINESS COPY / BUSINESS LICENSE RECEIPT

<p>PLEASE POST TOP PORTION IN A VISIBLE LOCATION</p>	<p>CITY OF TUSCALOOSA REVENUE DEPARTMENT P O BOX 2089 TUSCALOOSA, AL 35403 PHONE: (205) 248-5200 FAX: 205-349-0180 www.tuscaloosa.com</p>
<p>BUSINESS: EDKO, LLC 10500 TECHNOLOGY DR COTTONDALE, AL 35453</p>	
<p>NAICS: 236200 CATEGORY: CONTRACTOR TYPE: GENERAL ACCOUNT ID: 126510 ISSUE NO: 560 ISSUED BY: VLB ISSUE DATE: 01/14/2014</p>	<p>AMOUNT: 946.46 SUB TOTAL: 946.46 ISSUE FEE: 5.00 AMOUNT PAID: 951.46</p>

STATE OF Alabama

COUNTY OF Tuscaloosa

AFFIDAVIT

Before me, the undersigned authority, personally appeared Ted Kapera (affiant) who, being by me first duly sworn, doth depose and say as follows:

I Ted Kapera (name), on behalf of Edko, LLC (business entity), and with lawful authority to act in its behalf, attest to the following from personal knowledge:

1. Edko, LLC (business entity) does not knowingly employ, hire for employment, or continue to employ any unauthorized aliens in the State of Alabama; and
2. Edko, LLC (business entity) is enrolled in the E-Verify Program as shown by the attached documentation.
3. Edko, LLC (business entity) does and will utilize the E-Verify Program to verify the employment status of employees and potential employees according to federal rules and regulations.
4. Edko, LLC (business entity) shall acquire from its subcontractors notarized affidavits that they will not knowingly employ, hire for employment or continue to employ unauthorized aliens, that they will enroll in the E-Verify Program before performing any contract work or providing any product, and that they shall attach to the affidavits, documentation establishing their enrollment in E-Verify as required by Act No. 2011-535.

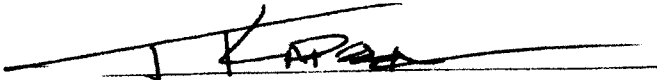

Signature of Affiant **Ted Kapera - Regional Sales Manager**

I, the undersigned Notary Public, in and for said County and State, hereby certify that Ted Kapera whose name is signed to the foregoing Affidavit, and who is known to me, acknowledged before me on this date that, being informed of the contents of the above and foregoing affidavit, he/she as an officer of Edko, LLC (business entity) and with full authority, executed the same voluntarily for and as the act of said company on the day the same bears date.

Given under my hand and official seal of office this 19th day of March, 2014.

Notary Public **Bonnie Taylor**

MY COMMISSION EXPIRES 1/3/2018

Commissioner Bobby Miller moved, seconded by Commissioner Jerry Tingle, the County Commission voted unanimously to approve a grant for the Duncanville Little League Ball Field project in the amount of \$5,132.00 and for PARA to oversee the project. The funds will be handled through the Tombigbee Resource Conservation and Development Council.

Commissioner Bobby Miller moved, seconded by Commissioner Stan Acker, the County Commission voted unanimously to approve the warrants issued to cover Tuscaloosa County's expenditures for February, 2014.

Exhibit 3-9, Page

Commission Chairman W. Hardy McCollum, on behalf of the Commission, signed the resolution attached authenticating the procedure for State reimbursement for the feeding of state prisoners.

Exhibit 3-10, Page

Upon request by County Attorney, Robert Spence, and upon motion by Commissioner Reginald Murray, seconded by Commissioner Jerry Tingle, the County Commission voted unanimously to go into executive session at the conclusion of the regular meeting to discuss pending litigation and a board appointment request.

Commissioner Bobby Miller moved, seconded by Commissioner Reginald Murray, the County Commission voted unanimously to declare five (5) units of the Sheriff's Office fleet as surplus property:

U156 2005 Dodge Durango VIN#1D4HD38N65F563246 132,000 miles
 U164 2005 Dodge Durango VIN#1D4HD38N75F561120 65,000 miles
 U165 2005 Dodge Durango VIN#1D4HD38N95F561121 137,500 miles
 U168 2005 Dodge Durango VIN#1D4HD38N45F563245 184,700 miles
 U170 2004 Dodge Durango VIN#1D4HD38N54F161832 114,100 miles

Exhibit 3-11, Page

Upon request by EMA Director, David Hartin, and upon motion by Commissioner Jerry Tingle, seconded by Commissioner Bobby Miller, the County Commission voted unanimously to enter into a

Company ID Number: 514003

**E-VERIFY
CORPORATE COMPANY**

**If you have any questions, contact E-Verify at
888-464-4218.**

INFORMATION REQUIRED FOR E-VERIFY	
Information relating to your Company:	
Company Name:	<u>Edko LLC</u>
Company Facility Address:	<u>7545 Haygood Road</u> <u>Shreveport, LA 71107</u>
County or Parish:	<u>CADDO</u>

Information relating to the Corporate Administrator(s) for your Company on policy questions or operational problems:

Name:	Michael Vasko	Fax Number:	(318) 424 - 6562
Telephone Number:	(318) 425 - 8671		
E-mail Address:	mike.vasko@edkollc.com		
Name:	Sonia Havens	Fax Number:	(318) 226 - 6128
Telephone Number:	(318) 425 - 8671		
E-mail Address:	sonia.havens@edkollc.com		

W. HARDY McCOLLUM
CHAIRMAN

MELVIN L. VINES
COUNTY ADMINISTRATOR

WILLIAM M. LAMB
CHIEF FINANCIAL OFFICER



MEMBERS
STAN ACKER
JERRY TINGLE
BOBBY MILLER
REGINALD MURRAY

COUNTY COMMISSION
TUSCALOOSA COUNTY ALABAMA
P.O. Box 20113 • 714 GREENSBORO AVENUE
TUSCALOOSA, ALABAMA 35402-0113
205-349-3870

February 24, 2014

Helena Chemical Co.
3200 Old Montgomery Road
Selma, AL 36703

Bid Number: 20140224001

Dear Helena Chemical Co.:

Tuscaloosa County will accept bids for the herbicide application services on county roads, bridges, and other specified locations until 9:00 a.m., Wednesday, March 19, 2014. The enclosed specifications and bid form were compiled by the County Engineer. Direct all inquiries in regard to this bid to Bobby Hagler at telephone number (205) 345-6600.

Bids can be mailed to:

Tuscaloosa County Commission
714 Greensboro Avenue, Room G78
Tuscaloosa, AL 35401

or brought to the County Commission Office, Room G78 in the Tuscaloosa County Courthouse prior to 9:00 a.m., Wednesday, 19 March, 2014.

Please return your bid in the "BID" envelope provided or use the "BID" envelope to address your bid package to assure that your bid is delivered to the correct office.

A word to the wise - MAIL EARLY - overnight mail, including Airborne Express, Federal Express, etc. does not always arrive by 9:00 a.m. the next day.

Sincerely,

W. M. Lamb
Chief Financial Officer

WML: pam

Enclosures

Copy: Bobby Hagler
File



Greg Wall
Industrial Specialist
PO Box 626
Selma, AL 36702
Office- 334-875-2737
Mobile- 662-312-0510

NO Bid

Greg J Wall



March 4, 2014

Mr. Bobby Hagler
Tuscaloosa County Commission
714 Greensboro Avenue, Room G78
Tuscaloosa, AL 35401

RE: RFP #20140224001, Herbicide Application

Dear Mr. Hagler:

Thank you for the opportunity to bid on the above-referenced project. At this time, we are unable to provide you with a proposal for this service. However, we would like to remain on the bid list for all future projects.

Please do not hesitate to contact me at (585) 295-2402 should you have any questions. Thank you.

Regards,
LEWIS TREE SERVICE, INC.

Jillian M. Stapleton
Bid & Contract Coordinator

Dozer Bid Evaluation

17-Mar-12

	New Machine	Buyback	Trade In
Deanco			\$ 38,200.00
Joe Money			No Bid
Iron Planet			\$ 27,505.00
Tractor Equipment Company			
	\$ 240,543.00	\$ 110,000.00	\$ 31,500.00
Thompson Tractor	\$ 249,100.00	\$ 101,325.00	\$ 24,300.00



Tuscaloosa County Bid Data Sheet

BID NUMBER: 20140303001

CATEGORY: DOZER

BID DATE: 3/3/2014

DATE SPECIFICATIONS RECEIVED: 3/3/2014

BID ITEM(S): individual bids and guaranteed auction consignment proposals for one (1) bulldozer

Bid authorized by County Commission: YES NO

Date Authorized: 3/3/2014

Commission Book

Page:

Vendors Allowed 14 days

From 3/3/2014 to 3/17/2014

Specifications compiled by: County Engineer Bobby Hagler (205) 345-6600

Problems with specifications YES NO

If yes, explain:

Number of bidders notified: 17

Number that responded: 6

Bid opened in public meeting: YES NO

If no, explain: Opened in the County Commission Conference Room. Those present were Bill Lamb, Melvin Vines, Amanda Marlow, Luther Richardson (Warrior), Kirk Kelley (Thompson), David (Deanco), Bob Winnette (Iron Planet), and Jody Thomason (Tractor and Equipment Company)

Bid awarded to:

Bid Amount: 0.00

Date awarded: 1/1/2000

To low bidder: YES NO

Commission Book:

Page:

If not awarded to low bidder, was 3% applied? YES NO

if no, explain:

Bid rejected: YES NO

If yes, explain:

Comments, problems and/or recommendations:

Bidders responding to bid invitation:

Deanco Auction Company of Mississippi, Inc.
Iron Planet
Joe Money Machinery Co., Inc.
Thompson Tractor Co., Inc.
Tractor and Equipment Company
Warrior Tractor & Equipment Company

CRAWLER DOZER BID SHEET

BID ITEM	QUANTITY	TOTAL BID PRICE
One (1) new John Deere 750K crawler dozer *meets or exceeds all specifications requested Crawler Dozer	1	<u>\$225,725.00</u>

Trade-In, Individual Bid, or Guaranteed Auctioneer Consignment Price

*Trade-in only
2004 John Deere 750C VIN#T0750CX941819 \$40,000.00

Buyback Bid
5 Yr. Option Each \$115,100.00

*see attached Executed Buyback Agreement

Delivery date: 30 to 60 days from receipt of order

Name of company: Warrior Tractor & Equipment Co., Inc.

Mailing Address: P.O. Box 412 Northport, AL 35476

Telephone: (205) 339-0300

Email: wte004@warriortractor.com

Name: Luther W. Richardson III Title: Sales Representative

Date: March 17, 2014

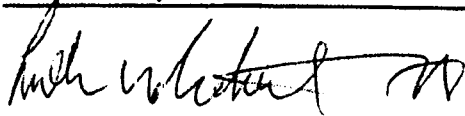

CRAWLER DOZER BID SHEET

BID ITEM	QUANTITY	BASE BID (EACH)	TOTAL PRICE
Base Bid Crawler Dozer Komatsu D61PX-23	1	<u>\$240,543.00</u>	<u>\$240,543.00</u>
Buyback Option (5 YEARS OR 5,000 HOURS) **See attached return provisions for buyback			<u>\$110,000.00</u> (Each)

BID ITEM	BASE BID
Trade-In, individual bid, or guaranteed Auction Consignment 2004 John Deere 750C VIN #T0750CX941819	<u>\$31,500.00</u> (trade allowance)

DELIVERY

Specify delivery date: Within 30 days of purchase order.
Subject to prior sales

Tractor & Equipment Company
3820 Greensboro Avenue
Tuscaloosa Alabama, 35405
205-752-0621
Jody Thomason
Branch Manager
March 17, 2014

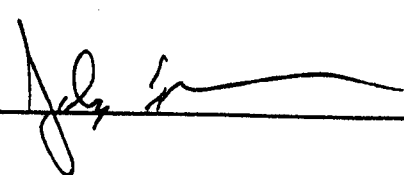

PLEASE SEE ATTACHED COPY OF KOMATSU CARE PROGRAM. THIS PROGRAM IS AT NO CHARGE TO THE COUNTY. IT DOES HAVE A DOLLAR VALUE AND MONEY SAVINGS TO THE COUNTY !

CRAWLER DOZER BID SHEET

BID ITEM	QUANTITY	TOTAL BID PRICE
Crawler Dozer	1	<u>249,100⁰⁰</u>
Trade-In, Individual Bid, or Guaranteed Auctioneer Consignment Price		
2004 John Deere 750C VIN#T0750CX941819		<u>24,300⁰⁰</u>
Buyback Bid 5 Yr. Option	Each	<u>101,375⁰⁰</u>

Delivery date: WITHIN 90 DAYS OF ORDER

Name of company: THOMPSON TRACTOR COMPANY, INC.

Mailing Address: 3550 SEE MANLYMAN PARKWAY TUSCALOOSA, AL 35401

Telephone: 247-2800

Email: KIRK KELLY @ THOMPSONTRACTOR.COM

Name: KIRK KELLY Title: SALES REP.

Date: 3/14/14

CRAWLER DOZER BID SHEET

No Bid

BID ITEM	QUANTITY	TOTAL BID PRICE
Crawler Dozer	1	_____
Trade-In, Individual Bid, or Guaranteed Auctioneer Consignment Price		
2004 John Deere 750C VIN#T0750CX941819		_____
Buyback Bid 5 Yr. Option	Each	_____

Delivery date: _____

Name of company: _____

Mailing Address: _____

Telephone: _____

Email: _____

Name: _____ Title: _____

Date: _____

CRAWLER DOZER BID SHEET

BID ITEM	QUANTITY	TOTAL BID PRICE
Crawler Dozer	1	<u>None</u>
Trade-In <u>Individual Bid</u> , or Guaranteed Auctioneer Consignment Price 2004 John Deere 750C VIN#T0750CX941819		<u>38,200</u> <i>Individual Bid To Purchase</i>
Buyback Bid 5 Yr. Option	Each	<u>None</u>

Delivery date: _____ **Deanco Auction Company of MS, Inc.**
 Name of company: _____ **P.O. Box 1248**
 Mailing Address: _____ **Philadelphia, MS 39350**
 Telephone: _____ **phone (601) 656-9768**
 _____ **fax (601) 656-0192**
 Email: _____
 Name: D.W. Dean Title: Owner
 Date: 3-14-14
601-656-9768 office phone for Jack

CRAWLER DOZER BID SHEET

BID ITEM	QUANTITY	TOTAL BID PRICE
Crawler Dozer	1	_____
Trade-In, Individual Bid, or Guaranteed Auctioneer Consignment Price		
2004 John Deere 750C VIN#T0750CX941819		<u>\$27,505.00</u>
Buyback Bid 5 Yr. Option	Each	_____

Delivery date: _____

Name of company: IRONPLANET

Mailing Address: 420 SHARPS COVE RD. Gurley, AL 35748

Telephone: 256-683-0795

Email: bwinnette@IRONPLANET.com

Name: Bob Winnette Title: TERRITORY MGR.

Date: 3/17/14

Tuscaloosa County Bid Data Sheet

BID NUMBER: 20140205001

CATEGORY: MOTOR GRADERS

BID DATE: 2/5/2014

DATE SPECIFICATIONS RECEIVED: 2/5/2014

BID ITEM(S): purchase and guaranteed auction cosignment of ten (10) motor graders

Bid authorized by County Commission: YES X NO **Date Authorized:** 2/5/2014

Commission Book **Page:** **Vendors Allowed** 21 days

From 2/5/2014 to 2/26/2014

Specifications compiled by: County Engineer Bobby Hagler (205) 345-6600

Problems with specifications YES NO X

If yes, explain:

Number of bidders notified: 19

Number that responded: 8

Bid opened in public meeting: YES NO X

If no, explain: Bids opened in the County Commission Chambers. Those present from the County were: Melvin Vines, Bill Lamb, Amanda Marlow, Allan Springer, and Kris Connell. Representatives from Deanco, Ritchie Bro, Thompson Tractor, Iron Planet, and Warrior Tractor were also present.

Bid awarded to:

Bid Amount: 0.00

Date awarded: 1/1/2000 **To low bidder:** YES NO

Commission Book: 046 **Page:**

If not awarded to low bidder, was 3% applied? YES NO

if no, explain:

Bid rejected: YES X NO

If yes, explain: The County Commission voted to reject all bids and rebid due to specs not being fully met.

Comments, problems and/or recommendations: Addendum No. 1 mailed on 2/11/14.

Bidders responding to bid invitation:

Deanco Auction Company of Mississippi, Inc.
Iron Planet
Ironman Equipment Brokerage Service, LLC
J.M. Wood Auction Company
Ritchie Brothers Auctioneers
Thompson Tractor Co., Inc.
Tractor and Equipment Company
Warrior Tractor & Equipment Company

Tuscaloosa County Bid Data Sheet

BID NUMBER: 20140205001

CATEGORY: MOTOR GRADERS

BID DATE: 2/5/2014

DATE SPECIFICATIONS RECEIVED: 2/5/2014

BID ITEM(S): purchase and guaranteed auction cosignment of ten (10) motor graders

Bid authorized by County Commission: YES NO

Date Authorized: 2/5/2014

Commission Book

Page:

Vendors Allowed 21 days

From 2/5/2014 to 2/26/2014

Specifications compiled by: County Engineer Bobby Hagler (205) 345-6600

Problems with specifications YES NO

If yes, explain:

Number of bidders notified: 19

Number that responded: 8

Bid opened in public meeting: YES NO

If no, explain: Bids opened in the County Commission Chambers. Those present from the County were: Melvin Vines, Bill Lamb, Amanda Marlow, Allan Springer, and Kris Connell. Representatives from Deanco, Ritchie Bro, Thompson Tractor, Iron Planet, and Warrior Tractor were also present.

Bid awarded to:

Bid Amount: 0.00

Date awarded: 1/1/2000

To low bidder: YES NO

Commission Book: **Page:**

If not awarded to low bidder, was 3% applied? YES NO

if no, explain:

Bid rejected: YES NO

If yes, explain:

Comments, problems and/or recommendations: Addendum No. 1 mailed on 2/11/14

Bidders responding to bid invitation:

- Deanco Auction Company of Mississippi, Inc.
- Iron Planet
- Ironman Equipment Brokerage Service, LLC
- J.M. Wood Auction Company
- Ritchie Brothers Auctioneers
- Thompson Tractor Co., Inc.
- Tractor and Equipment Company
- Warrior Tractor & Equipment Company

BID FOR NEW MOTOR GRADERS

<u>Bid Item</u>	<u>Unit</u>	<u>Base Bid</u>
Base Bid Motor grader	Each	_____
Buyback Bid 3 Yr. Option	Each	_____

Bid For Used 2011 John Deere 772GP Motor Graders

<u>Bid Item</u>	<u>Unit</u>	<u>Base Bid</u>
Trade-In, Individual Bid, or Guaranteed Auction Consignment Price 2011 John Deere 772GP Motor Grader		Lump Sum \$ 1,559,000
S.N. 1DW772GPVBE636461	Each	<u>135,000</u>
S.N. 1DW772GPLBE636317	Each	<u>135,000</u>
S.N. 1DW772GPLBE636463	Each	<u>140,000</u>
S.N. 1DW772GPTBE636467	Each	<u>135,000</u>
S.N. 1DW772GPABE636493	Each	<u>148,000</u>
S.N. 1DW772GPHBE636495	Each	<u>144,000</u>
S.N. 1DW772GPCBE636555	Each	<u>140,000</u>
S.N. 1DW772GPABE636526	Each	<u>138,000</u>
S.N. 1DW772GPHBE636528	Each	<u>148,000</u>
S.N. 1DW772GPKBE636567	Each	<u>148,000</u>
S.N. 1DW772GPEBE636577	Each	<u>148,000</u>

Name Of Company: Deanco Auction Co.

Mailing Address: PO Box 1248 Philadelphia Ms 39350

Telephone Number: 601-656-9768

Name: D. W. Dean

Title: Owner

Date: 2-26-14

BID FOR NEW MOTOR GRADERS

<u>Bid Item</u>	<u>Unit</u>	<u>Base Bid</u>
Base Bid Motor grader	Each	_____
Buyback Bid 3 Yr. Option	Each	_____

Bid For Used 2011 John Deere 772GP Motor Graders

<u>Bid Item</u>	<u>Unit</u>	<u>Base Bid</u>
Trade-In, Individual Bid, or Guaranteed Auction Consignment Price 2011 John Deere 772GP Motor Grader	*	
S.N. 1DW772GPVBE636461	Each	\$163,000
S.N. 1DW772GPLBE636317	Each	\$163,000
S.N. 1DW772GPLBE636463	Each	\$163,000
S.N. 1DW772GPTBE636467	Each	\$163,000
S.N. 1DW772GPABE636493	Each	\$163,000
S.N. 1DW772GPHBE636495	Each	\$163,000
S.N. 1DW772GPCBE636555	Each	\$163,000
S.N. 1DW772GPABE636526	Each	\$163,000
S.N. 1DW772GPHBE636528	Each	\$163,000
S.N. 1DW772GPKBE636567	Each	\$163,000
S.N. 1DW772GPEBE636577	Each	\$163,000

Name Of Company: IronPlanet, Inc.

Mailing Address: 3825 Hopyard Rd, Ste 250, Pleasanton, CA 94588

Telephone Number: 925-225-8800

Name: Bonnie Waldron

Title: Director, Contracts

Date: 2/25/2014

* IronPlanet is providing this bid for all 11 machines. The bid is only good on award of all machines. IronPlanet does not agree to bid individually on the items; only the entire package.



IRONMAN

Equipment Brokerage Services, LLC

11837 Grandview Drive Northport, AL 35475 (205) 333-5503

February 19, 2014

Tuscaloosa County Commission
P.O. Box 20113
Tuscaloosa, AL 35402-0113

Gentlemen:

Thank you for the invitation to bid on your used 2011 John Deere 772GP motor graders. Current market conditions do not justify our bidding on these machines.

Therefore we respectfully choose to submit a "NO BID".

Please keep us on your bid request list for your future equipment bids.

Sincerely,

Ironman Equipment Brokerage Services LLC

A handwritten signature in black ink, appearing to read "Joe Butts", with a horizontal line extending to the right.

J. Joe Butts

President/Managing Member

BID FOR NEW MOTOR GRADERS

<u>Bid Item</u>	<u>Unit</u>	<u>Base Bid</u>
Base Bid Motor grader	Each	_____
Buyback Bid 3 Yr. Option	Each	_____

Bid For Used 2011 John Deere 772GP Motor Graders

<u>Bid Item</u>	<u>Unit</u>	<u>Base Bid</u>
Trade-In, Individual Bid, or Guaranteed Auction Consignment Price 2011 John Deere 772GP Motor Grader		
S.N. 1DW772GPVBE636461	Each	\$160,150 Auction Net Guarantee
S.N. 1DW772GPLBE636317	Each	\$160,150 Auction Net Guarantee
S.N. 1DW772GPLBE636463	Each	\$160,150 Auction Net Guarantee
S.N. 1DW772GPTBE636467	Each	\$160,150 Auction Net Guarantee
S.N. 1DW772GPABE636493	Each	\$160,150 Auction Net Guarantee
S.N. 1DW772GPHBE636495	Each	\$160,150 Auction Net Gaurantee
S.N. 1DW772GPCBE636555	Each	\$160,150 Auction Net Guarantee
S.N. 1DW772GPABE636526	Each	\$160,150 Auction Net Guarantee
S.N. 1DW772GPHBE636528	Each	\$160,150 Auction Net Guarantee
S.N. 1DW772GPKBE636567	Each	\$160,150 Auction Net Guarantee
S.N. 1DW772GPEBE636577	Each	\$160,150 Auction Net Guarantee

Name Of Company: J. M. Wood Auction Co., Inc.

Mailing Address: 3475 Ashley Road, Montgomery, Al 36108

Telephone Number: 334-264-3265

Name: Bryant S. Wood 

Title: Vice President

Date: 02/25/14

*Auction Date: June 4-5, 2014 in Montgomery, AL
 *Tires must be 50% or better, Good cutting edge, No glass breakage

BID FOR NEW MOTOR GRADERS

<u>Bid Item</u>	<u>Unit</u>	<u>Base Bid</u>
Base Bid Motor grader	Each	_____
Buyback Bid 3 Yr. Option	Each	_____

Bid For Used 2011 John Deere 772GP Motor Graders

<u>Bid Item</u>	<u>Unit</u>	<u>Base Bid</u>
Trade-In, Individual Bid, or Guaranteed Auction Consignment Price 2011 John Deere 772GP Motor Grader		
S.N. 1DW772GPVBE636461	Each	<u>171,954.55</u>
S.N. 1DW772GPLBE636317	Each	<u>171,954.55</u>
S.N. 1DW772GPLBE636463	Each	<u>171,954.55</u>
S.N. 1DW772GPTBE636467	Each	<u>171,954.55</u>
S.N. 1DW772GPABE636493	Each	<u>171,954.55</u>
S.N. 1DW772GPHBE636495	Each	<u>171,954.55</u>
S.N. 1DW772GPCBE636555	Each	<u>171,954.54</u>
S.N. 1DW772GPABE636526	Each	<u>171,954.54</u>
S.N. 1DW772GPHBE636528	Each	<u>171,954.54</u>
S.N. 1DW772GPKBE636567	Each	<u>171,954.54</u>
S.N. 1DW772GPEBE636577	Each	<u>171,954.54</u>

Name Of Company: RITCHIE Bros. Auctioneers

Mailing Address: 4170 Hwy 154 NEWNAN GA 30265

Telephone Number: 205 837-9033

Name: Jody Lenderman

Title: Territory Mgr.

Date: FEB 24, 2014

BID FOR NEW MOTOR GRADERS

<u>Bid Item</u>	<u>Unit</u>	<u>Base Bid</u>
Base Bid Motor grader	Each	<u>\$ 243,500⁰⁰</u>
Buyback Bid 3 Yr. Option	Each	<u>\$ 205,000⁰⁰</u>

Bid For Used 2011 John Deere 772GP Motor Graders

<u>Bid Item</u>	<u>Unit</u>	<u>Base Bid</u>
<u>Trade-In</u> Individual Bid, or Contract Price, or 2011 John Deere 772GP Motor Grader		
S.N. 1DW772GPVBE636461	Each	<u>\$ 180,000⁰⁰</u>
S.N. 1DW772GPLBE636317	Each	<u>\$ 180,000⁰⁰</u>
S.N. 1DW772GPLBE636463	Each	<u>\$ 180,000⁰⁰</u>
S.N. 1DW772GPTBE636467	Each	<u>\$ 180,000⁰⁰</u>
S.N. 1DW772GPABE636493	Each	<u>\$ 180,000⁰⁰</u>
S.N. 1DW772GPHBE636495	Each	<u>\$ 180,000⁰⁰</u>
S.N. 1DW772GPCBE636555	Each	<u>\$ 180,000⁰⁰</u>
S.N. 1DW772GPABE636526	Each	<u>\$ 180,000⁰⁰</u>
S.N. 1DW772GPHBE636528	Each	<u>\$ 180,000⁰⁰</u>
S.N. 1DW772GPKBE636567	Each	<u>\$ 180,000⁰⁰</u>
S.N. 1DW772GPEBE636577	Each	<u>\$ 180,000⁰⁰</u>

Name Of Company: THOMPSON TRACTOR COMPANY, INC.

Mailing Address: 3550 JOE MANNING PARKWAY, TUSCALOOSA, AL 35401

Telephone Number: 205-247-2800

Name: KIRK KELLY ; [Signature]

Title: SALES REPRESENTATIVE

Date: 2/26/14

BID FOR NEW MOTOR GRADERS

<u>Bid Item</u>	<u>Unit</u>	<u>Base Bid</u>
Base Bid Motor grader	Each	<u>No Bid</u>
Buyback Bid 3 Yr. Option	Each	<u>No Bid</u>

Bid For Used 2011 John Deere 772GP Motor Graders

<u>Bid Item</u>	<u>Unit</u>	<u>Base Bid</u>
Trade-In, Individual Bid, or Guaranteed Auction Consignment Price 2011 John Deere 772GP Motor Grader		
S.N. 1DW772GPVBE636461	Each	
S.N. 1DW772GPLBE636317	Each	
S.N. 1DW772GPLBE636463	Each	
S.N. 1DW772GPTBE636467	Each	
S.N. 1DW772GPABE636493	Each	
S.N. 1DW772GPHBE636495	Each	
S.N. 1DW772GPCBE636555	Each	
S.N. 1DW772GPABE636526	Each	
S.N. 1DW772GPHBE636528	Each	
S.N. 1DW772GPKBE636567	Each	
S.N. 1DW772GPEBE636577	Each	

Name Of Company: TRACTOR AND EQUIPMENT CO.

Mailing Address: 3820 GREENSBORO AVE TUSCALOOSA, AL 35405

Telephone Number: 752-0621

Name: JODY THOMASON

Title: BRANCH MANAGER

Date: 2-7-14

BID FOR NEW MOTOR GRADERS

<u>Bid Item</u>	<u>Unit</u>	<u>Base Bid</u>
Ten (10) new 2014 John Deere 772GP motor graders		
Motor grader	Each	\$266,998.00
Delivery: 30 to 60 days from receipt of order		
Buyback Bid		
3 Yr. Option	Each	\$204,520.00

*The units quoted include all items requested and meet or exceed all specifications requested, including addendum.

Bid For Used 2011 John Deere 772GP Motor Graders

<u>Bid Item</u>	<u>Unit</u>	<u>Base Bid</u>
Trade-In, Individual Bid, or Guaranteed Auction Consignment Price		Package Price.....\$1,948,617.00
2011 John Deere 772GP Motor Grader		*Trade-in only; Based on trade of all 11 units against purchase of 10 new Deere 772GPs; average price per unit is \$177,147.00
S.N. 1DW772GPVBE636461	Each	
S.N. 1DW772GPLBE636317	Each	
S.N. 1DW772GPLBE636463	Each	
S.N. 1DW772GPTBE636467	Each	
S.N. 1DW772GPABE636493	Each	
S.N. 1DW772GPHBE636495	Each	
S.N. 1DW772GPCBE636555	Each	
S.N. 1DW772GPABE636526	Each	
S.N. 1DW772GPHBE636528	Each	
S.N. 1DW772GPKBE636567	Each	
S.N. 1DW772GPEBE636577	Each	

Name Of Company: Warrior Tractor & Equipment Co., Inc.

Mailing Address: P.O. Box 412 Northport, AL 35476

Telephone Number: (205) 339-0300

Name: Luther W. Richardson III *Luther Richardson III*

Title: Sales Representative

Date: February 25, 2014

STATE OF ALABAMA §

TUSCALOOSA COUNTY §

**RESOLUTION ACCEPTING PRELIMINARY PLAT
RIVERBEND WOODS SUBDIVISION**

WHEREAS, the County Engineer has reported to the Tuscaloosa County Commission that the developer has complied with all Tuscaloosa County Subdivision related to the preparation and presentation of a preliminary plat for a new development or the extension of an existing development; and

WHEREAS, the Tuscaloosa County Commission has been presented with the preliminary plat and accompanying information, and determines that there is no just reason to withhold approval of the preliminary plat.

NOW, THEREFORE, IT BE RESOLVED BY THE TUSCALOOSA COUNTY COMMISSION that the preliminary plat recommended for approval by the Tuscaloosa County Engineer is approved and accepted

Approved and accepted at our regularly scheduled meeting on this the 19th day of March, 2014

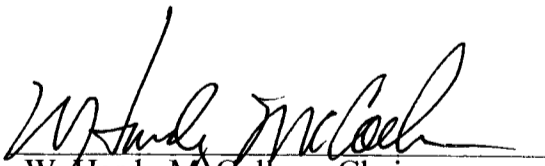

W. Hardy McCollum, Chairman
Tuscaloosa County Commission

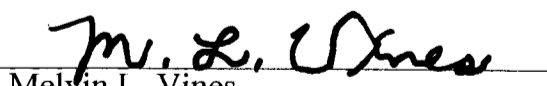

Melvin L. Vines
County Administrator

STATE OF ALABAMA §

TUSCALOOSA COUNTY §

RESOLUTION ACCEPTING PRELIMINARY PLAT

**RESURVEY OF LOTS 9-11
GSI PROPERTIES SUBDIVISION**

WHEREAS, the County Engineer has reported to the Tuscaloosa County Commission that the developer has complied with all Tuscaloosa County Subdivision related to the preparation and presentation of a preliminary plat for a new development or the extension of an existing development; and

WHEREAS, the Tuscaloosa County Commission has been presented with the preliminary plat and accompanying information, and determines that there is no just reason to withhold approval of the preliminary plat.

NOW, THEREFORE, IT BE RESOLVED BY THE TUSCALOOSA COUNTY COMMISSION that the preliminary plat recommended for approval by the Tuscaloosa County Engineer is approved and accepted

Approved and accepted at our regularly scheduled meeting on this the 19th day of March, 2014

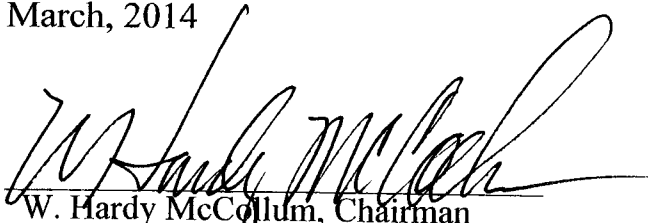
W. Hardy McCollum, Chairman
Tuscaloosa County Commission

Melvin L. Vines
County Administrator

STATE OF ALABAMA §

TUSCALOOSA COUNTY §

RESOLUTION ACCEPTING PRELIMINARY PLAT

PINION ESTATES

PHASE 2

WHEREAS, the County Engineer has reported to the Tuscaloosa County Commission that the developer has complied with all Tuscaloosa County Subdivision related to the preparation and presentation of a preliminary plat for a new development or the extension of an existing development; and

WHEREAS, the Tuscaloosa County Commission has been presented with the preliminary plat and accompanying information, and determines that there is no just reason to withhold approval of the preliminary plat.

NOW, THEREFORE, IT BE RESOLVED BY THE TUSCALOOSA COUNTY COMMISSION that the preliminary plat recommended for approval by the Tuscaloosa County Engineer is approved and accepted

Approved and accepted at our regularly scheduled meeting on this the 19th day of March, 2014

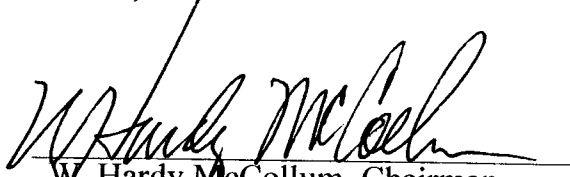
W. Hardy McCollum, Chairman
Tuscaloosa County Commission

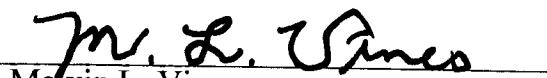
Melvin L. Vines
County Administrator

MONTH OF: FEBRUARY, 2014

FUND	CHECK NUMBERS	AMOUNT
001 GENERAL FUND SPECIAL SALES TAX	19699-20011	\$3,909,419.57
112 ROAD & BRIDGE	5924-6111	\$1,212,882.17
116 CAPITAL IMPROVEMENT		
117 RRR GAS TAX		
120 REAPPRAISAL	2315-2342	\$162,463.16
160 COMMUNITY DEVELOP	1589-1592	\$300,317.50
710 PAYROLL-CHECKS	93659-93708	\$1,504,263.65
	57348-57460	\$111,787.20
	10911-11822	\$1,125,896.62
720 PAYROLL-DIR DEP EXCESS LAND SALES		
730 FIDUCIARY		
750 PISTOL PERMIT	8153-8193	\$72,096.19
780 E911	4956-4969	\$42,393.71
781 GAS TAX BONDING		
783 GENERAL LIABILITY		
783 WORKMEN'S COMP	127	\$9,828.66
783 HEALTH INSURANCE		
784 TAX COLL SPECIAL		
785 TAX ASSR SPECIAL		
786 MFG HOMES		
787 MOTOR VEH TRAINING		

\$8,451,348.43

CHECKED BY:



WILLIAM M. LAMB, CHIEF FINANCIAL OFFICER

APPROVED BY TUSCALOOSA COUNTY COMMISSION

CHAIRMAN, W. HARDY MCCOLLUM

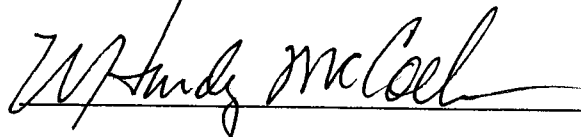

COMMISSIONER, STAN ACKER



COMMISSIONER, JERRY TINGLE

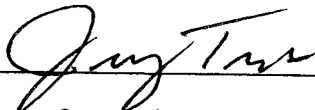

COMMISSIONER, BOBBY MILLER

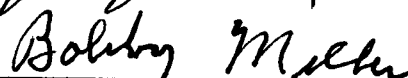

COMMISSIONER, REGINALD MURRAY



STATE OF ALABAMA §

TUSCALOOSA COUNTY §

RESOLUTION REGARDING FEEDING OF INMATES

WHEREAS, the Tuscaloosa County Commission is the governing body of Tuscaloosa County, Alabama; and

WHEREAS, Alabama statutes allow for Sheriffs of their respective counties to personally provide for the feeding of inmates housed at the county jails, and to receive allowances for the feeding of inmates; and

WHEREAS, the Tuscaloosa County Commission has provided for the feeding of inmates at the Tuscaloosa County Jail for the past twenty (20) years, with the cooperation of the Sheriff of Tuscaloosa County; and

WHEREAS, Section 36-22-17 authorizes the County Commission to direct the allowances and amounts received for feeding prisoners be deposited into the county general fund.

NOW, THEREFORE, BE IT RESOLVED, that the Tuscaloosa County Commission shall pay the reasonable costs associated with feeding the inmates at the Tuscaloosa County Jail, and the Commission further directs that such allowances and amounts allowed by statute for the feeding of inmates be paid into the general fund of Tuscaloosa County.

IN WITNESS WHEREOF, the Tuscaloosa County Commission has caused this Resolution to be executed in its name and on its behalf by its Chairman on this the 19th day of March, 2014.

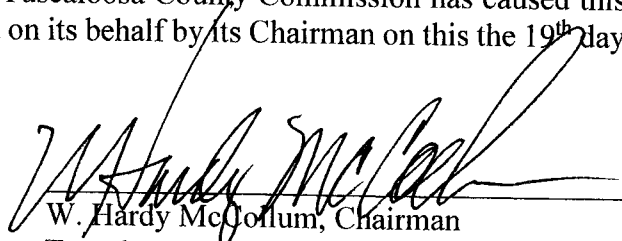
W. Hardy McCollum, Chairman
Tuscaloosa County Commission

ATTEST:

Melvin Vines, County Administrator

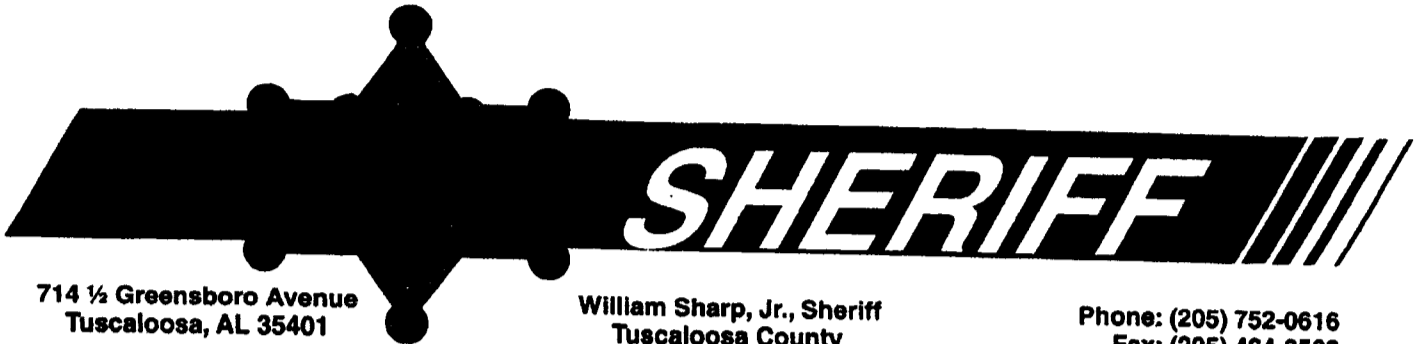

714 ½ Greensboro Avenue
Tuscaloosa, AL 35401

William Sharp, Jr., Sheriff
Tuscaloosa County

Phone: (205) 752-0616
Fax: (205) 464-8562

March 17, 2014

W. Hardy McCollum, Chairman
Honorable Tuscaloosa County Commission Members
714 Greensboro Avenue
Tuscaloosa, Alabama 35401

Gentlemen,

Currently we have several vehicles in our fleet that have reached their usefulness. All have been used as patrol units, or jail transport units. Due to age, mileage, paint, and general condition these vehicles are not sufficient to be in our fleet any longer. We respectfully recommend the following for auction:

U156 Dodge Durango	1D4HD38N65F563246 Age, Constant repairs	2005 132,000
U164 Dodge Durango	1D4HD38N75F561120 Age, Constant repairs	2005 65,000
U165 Dodge Durango	1D4HD38N95F561121 Age, Constant repairs	2005 137,500
U168 Dodge Durango	1D4HD38N45F563245 Age, Constant repairs	2005 184,700
U170 Dodge Durango	1D4HD38N54F161832 Age, Constant repairs	2004 114,100

Thanks in advance for your help in this matter.

Sincerely,

William Sharp Jr.
William Sharp, Jr., Sheriff

STATE OF ALABAMA §

TUSCALOOSA COUNTY §

**A RESOLUTION APPOINTING MEMBER TO THE BOARD OF THE
TUSCALOOSA COUNTY COMMUNITY PUNISHMENT AND CORRECTIONS
AUTHORITY**

WHEREAS, the Commission has previously authorized the creation of the Tuscaloosa County Community Punishment and Corrections Authority; and

WHEREAS, the Commission has agreed to appoint one member nominated by the University of Alabama; and

WHEREAS, the University of Alabama has nominated Mr. Tim Davis to replace Dr. Tim Hebson as the representative of the University community on the Board.

NOW, THEREFORE, BE IT RESOLVED by the Tuscaloosa County Commission as follows:

That Mr. Tim Davis is hereby appointed to fill the unexpired term of Dr. Tim Hebson on the Board of Directors of the Tuscaloosa County Community Punishment and Corrections Authority.

ADOPTED this the 19th day of March, 2014.

W. Hardy McCollum, Chairman
Tuscaloosa County Commission

ATTEST:

Melvin Vines, County Administrator