

TUSCALOOSA COUNTY COMMISSION

MEETING

May 1, 2013

TUSCALOOSA COUNTY §
STATE OF ALABAMA §

This being the date and hour to which the Tuscaloosa County Commission adjourned, the County Commission met pursuant to such adjournment with Probate Judge W. Hardy McCollum presiding as Chairman. The following members were present:

Stan Acker
Jerry Tingle
Bobby Miller
Reginald Murray

Commissioner Stan Acker moved, seconded by Commissioner Jerry Tingle, the County Commission voted unanimously to approve a request from Sentell Engineering Inc. regarding a preliminary plat for Stearman Subdivision.

Exhibit 5-1, Page

Commissioner Reginald Murray moved, seconded by Commissioner Bobby Miller, the County Commission voted unanimously to approve a request for bond extension by the developer for Benton Sod Farm Phase II.

Commissioner Jerry Tingle moved, seconded by Commissioner Bobby Miller, the County Commission voted unanimously to authorize submission of grant applications to the Alabama Department of Economic and Community Affairs for the projects listed below. Marcum and Associates authorized to prepare the necessary paperwork for grant submission for the "Old Foundry Project" and the relocation of the Senior Activity Center. McGiffert and Associates authorized to prepare the necessary paperwork for grant submission for Friday Circle Sewer and Holt Sewer Projects. County Attorney Robert Spence authorized to continue working on securing the "old" Holt Elementary School

site from the Tuscaloosa County Board of Education for the Foundry Project and the relocation site for the Senior Activity Center.

Community Development Block Grant (HUD) Disaster Funds - Round 2
(Total State Allocation \$48,000,000.00)

Holt Community Clearance and Demolition Project
\$150,000.00

New Foundry Project (Old Holt Elementary School)
\$1,100,000.00 + Community Senior Center CDBG Enhancement Grant Project (Previously Approved)

Holt Sanitary Sewer/Street Reconstruction Project
\$8,770,000.00

Area B \$ 690,000.00
Area E-2 1,600,000.00
Area E-3 1,620,000.00
Area F 2,040,000.00
Area G 2,820,000.00

Friday Circle Sanitary Sewer/Water/Street Reconstruction Project
\$1,773,000.00

Multi/Single Family Housing Project (Project feasibility and funding amount to be determined)

Economic Development Project (Scope of Project and funding amount to be determined)

Exhibit 5-2, Page

Commissioner Jerry Tingle moved, seconded by Commissioner Reginald Murray, the County Commission voted unanimously to authorize the rewrite and resubmission of grant application to Alabama Transportation Rehabilitation and Improvement Program (ATRIP), for the Will Walker Road Reconstruction Project.

Commissioner Jerry Tingle moved, seconded by Commissioner Bobby Miller, the County Commission voted unanimously to authorize submission of necessary paperwork to Alabama Transportation Rehabilitation and Improvement Program (ATRIP), for the M-Class Boulevard Extension Project, listing the County Commission as the sponsor along with the Town of Vance. The match funds of \$2,272,000.00 will be provided through the County Commission.

Exhibit 5-3, Page

Commissioner Bobby Miller moved, seconded by Commissioner Jerry Tingle, the County Commission voted unanimously to adopt a resolution authorizing the vacation of right-of-way of a portion of Southview Lane. It was noted by County Attorney Robert Spence that the petitioners are Virginia Underwood and Tabitha Hinton Brown. No persons were in attendance to object.

Exhibit 5-4, Page

The Commission was addressed by County Attorney Robert Spence regarding approval of a Community Corrections Authority. Mr. Spence advised that, in order for the present employees to remain in the Retirement Systems of Alabama, it will be necessary for Tuscaloosa County Community Corrections to be reconstituted as an authority. The Retirement System has further asked that Community Corrections be incorporated specifically under the Community Corrections and Punishment Act, which provides for a public corporation which is the Authority. After discussion the item was tabled, additional information will be forwarded to the Commission and the request will be addressed at the next Commission meeting.

Commissioner Stan Acker moved, seconded by Commissioner Jerry Tingle, the County Commission voted unanimously to go into Executive Session prior to the end of this meeting to discuss litigation with the County Attorney.

Commissioner Stan Acker moved, seconded by Commissioner Jerry Tingle, the County Commission voted unanimously to approve a funding request from Tuscaloosa County Schools to pave and stripe two parking lots at the new Central Office. An estimate of \$14,500.00 has been received from the Engineering Office for an external contractor. Funds to pay for the paving and striping will come out of the County's general fund budget.

Exhibit 5-5, Page

Commissioner Jerry Tingle made a motion, seconded by Commissioner Stan Acker, to pass the Speed Table Policy. After discussion, Commissioner Jerry Tingle moved to table this request. The motion to table passed unanimously.

Commissioner Reginald Murray made a motion to approve the City-County Facility Upgrades Three Year Plan for PARA. Chairman McCollum objected on the basis that the item was not included on the agenda as of Monday evening. Commissioner Stan Acker made a motion, seconded by Commissioner Reginald Murray, to depart from the order of business set forth in the official agenda to amend the agenda and add this item. Motion to suspend the rules failed on a three-to-one vote with Commissioner Bobby Miller casting the NAY vote.

There being no further business to come before the Tuscaloosa County Commission, the meeting adjourned to Wednesday, May 15, 2013.

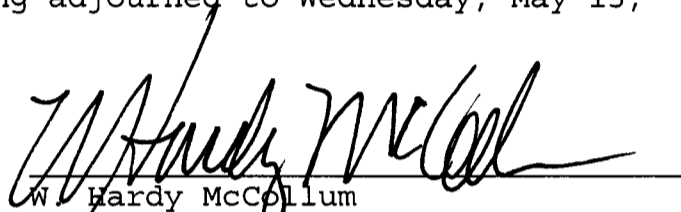
W. Hardy McCollum
Judge of Probate and Chairman
Tuscaloosa County Commission

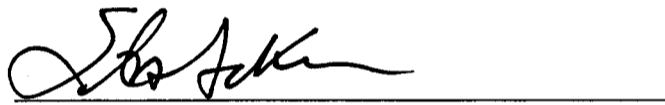

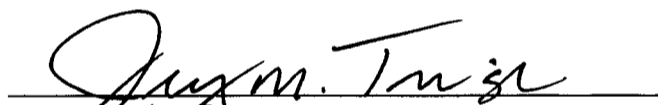
Stan Acker
Commissioner - District I

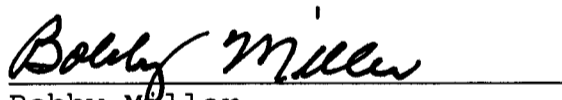
Jerry Tingle
Commissioner - District II

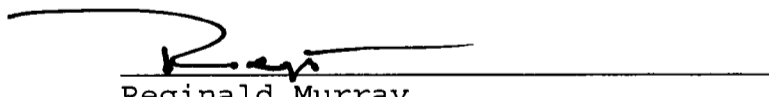
Bobby Miller
Commissioner - District III

Reginald Murray
Commissioner - District IV

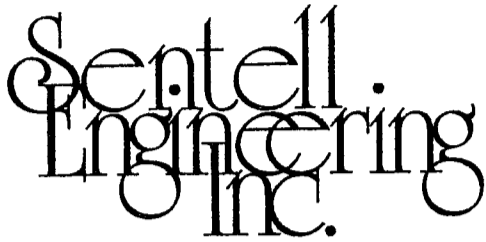
District 1



Engineers
Planners
Surveyors
Environmental Specialists

"Turning Ideas into Reality Since 1981"

April 23, 2013

Tuscaloosa County Public Works Department
2810 35th Street
Tuscaloosa, Alabama 35401

To Whom It May Concern:

Re: Stearman Subdivision

We are submitting the preliminary plat for the above referenced subdivision to you for review. The two existing properties are being serviced by septic tank and there are no additional lots being created that would require another septic tank.

If you have any questions, please feel free to call us.

Sincerely,

SENTELL ENGINEERING, INC.

A handwritten signature in cursive script that reads 'Aubrey Martin'.

Aubrey Martin, P.L.S.

JAM/dss

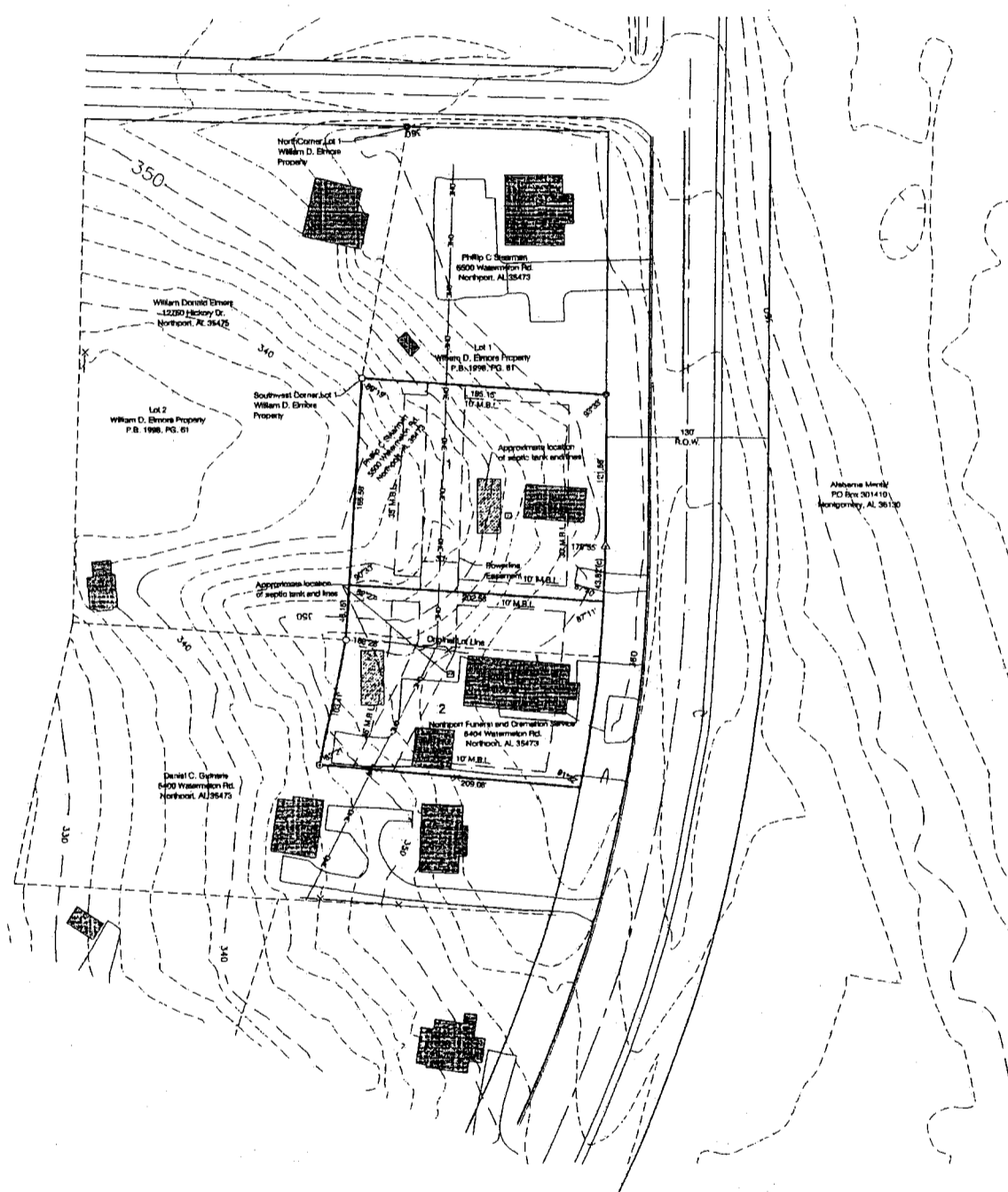

- Note:
1. OWNER/DEVELOPER
 Philip C. Swerman
 6600 Watermelon Rd.
 Northport, AL 35473
 Northport Forest & Cemetery Service Inc.
 6404 Watermelon Rd.
 Northport, AL 35473
 2. TOTAL ACRES OWNED: 1.5 acres ±
 3. TOTAL ACRES DEVELOPED: 1.5 acres ±
 4. PROPERTY IS SERVED BY THE CARROLLS CREEK WATER AUTHORITY
 5. CURRENT ZONING: Property is in Tuscaloosa County
 6. SOURCE OF TITLE: D.B. 2011, PG. 18032 and D.B. 2004, PG. 17043

The drawing is provided under Federal and State Copyright laws and is the property of Sentell Engineering, Inc. Any unauthorized reproduction or modification of the drawing without written permission of Sentell Engineering, Inc. is strictly prohibited. This drawing is not to be used without original seal and signature.

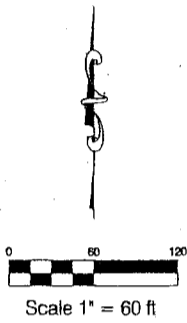

LEGEND:

IRON PIPE/PIN FOUND	○	OVER HEAD ELECTRIC	—O—E
CAPPED PIPE/PIN SET	●	PLAT BOOK	—P.B.
CAPPED PIPE/PIN FOUND	⊙	DEED BOOK	—D.B.
CONC. MONUMENT FOUND	⊕	PAGE	—Pg.
NORTH	N	SECTION LINES	—S—
SOUTH	S	LIGHT POLE	—L—
EAST	E	UTILITY POLE	—U—
WEST	W	GUY WIRE	—G—
RECORD BOOK	()	TRANSFORMER PAD	—T—
MINIMUM BUILDING LINE	M.B.L.	AIR CONDITION UNIT	—A.C.—
RIGHT OF WAY	R.O.W.	GAS VALVE	—G.V.—
CHAINLINK FENCE	—C—	GAS METER	—G.M.—
WOOD FENCE	—W—	GAS REGULATOR	—G.R.—
BARBED WIRE FENCE	—B—	HOSE BIBB	—H.B.—
GAS LINE	—G—	WATER VALVE	—W.V.—
WATER LINE	—W—	WATER METER	—W.M.—
UNDERGROUND COMM.	—U.C.—	FIRE HYDRANT	—F.H.—
OVER HEAD COMM.	—O.C.—	SANITARY SEWER MANHOLE	—S.S.—
UNDER GROUND CABLE	—U.C.—	CLEANOUT	—C.O.—
SANITARY SEWER	—S—	STORM SEWER MANHOLE	—S.S.—
STORM SEWER	—S—	YARD INLET W/ MANHOLE	—Y.I.—
UNDER GROUND ELECTRIC	—U.E.—	COMMUNICATIONS MANHOLE	—C.M.—

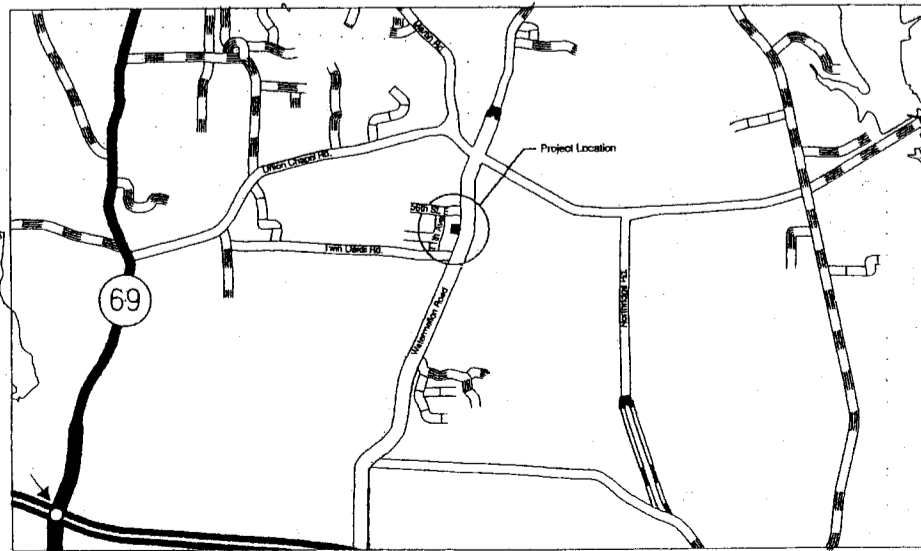
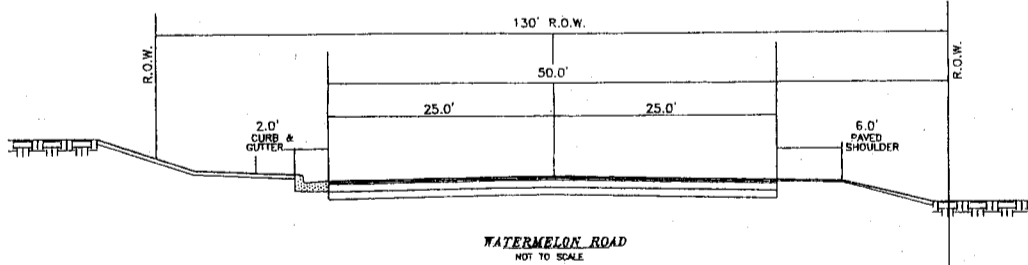

Preliminary Plat
Stearman Survey
 Part of the Southeast Quarter of the Southeast Quarter
 Section 36, T-20S, R-10-W
 Tuscaloosa County, Alabama

File:	13027-preplat.dwg	Revisions: No. 1	4-19-13	KSP
Project:	13-027			
Drawn:	03-11-13			
Surveyed:	02-25-13			
Drawn By:	J.A.M.			
Field Book:	Chilton			

Sentell Engineering, Inc.
 ENGINEERS | PLANNERS | SURVEYORS
 628 Black Bears Way | Tuscaloosa, Alabama 35401
 Phone: (205) 752-5564 | Fax: (205) 752-5566
 Visit our website at: www.sentell.net

RECEIVED
 APR 17 2013

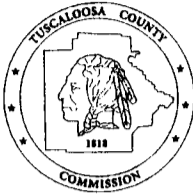

Tuscaloosa County

Department of Planning and Community Development

Farrington B. Snipes, Jr.
Director

PROPOSED PROJECTS (COMMUNITY DEVELOPMENT BLOCK GRANT (HUD) DISASTER FUNDS) – ROUND 2

HOLT COMMUNITY CLEARANCE & DEMOLITION PROJECT:

\$ 150,000.00

NEW FOUNDRY PROJECT (OLD HOLT ELEMENTARY SCHOOL):

\$1,100,000.00 + Community Senior Center CDBG Enhancement Grant Project (Previously Approved)

HOLT SANITARY SEWER/STREET RECONSTRUCTION PROJECT:

\$8,770,000.00

- AREA "B" \$ 690,000.00
- AREA "E-2" \$1,600,000.00
- AREA "E-3" \$1,620,000.00
- AREA "F" \$2,040,000.00
- AREA "G" \$2,820,000.00

FRIDAY CIRCLE SANITARY SEWER/WATER/STREET RECONSTRUCTION PROJECT:

\$1,773,000.00

MULTI/SINGLE FAMILY HOUSING PROJECT:

Project Feasibility and Funding Amount to Be Determined

ECONOMIC DEVELOPMENT PROJECT

Scope of Project and Funding Amount to Be Determined

OTHER:

RESOLUTION

WHEREAS, the Tuscaloosa County Commission supports new construction and improvements to existing roads and bridges to enhance safety and transportation requirements for residents of the County and to support the expansion of existing industries and the location of new industries in Tuscaloosa County which provide new job opportunities for residents; and

WHEREAS, the area in the vicinity of M-Class Boulevard is in a major area of existing and future economic development and growth; and

WHEREAS, there exists a need for the extension of M-Class Boulevard to cross over U. S. Highway 11 and Norfolk Southern Railroad to intersect with the Tingle Tangle Road as an integral segment in transportation improvements which are needed to accommodate the large number of trucks and other vehicles utilizing the existing roadway and to provide for future economic development in the area; and

WHEREAS, funding assistance is available through the State of Alabama Department of Transportation and the Alabama Transportation Rehabilitation and Improvement Program (ATRIP) for the subject project;

NOW, THEREFORE, BE IT RESOLVED that the Tuscaloosa County Commission hereby approves the preparation and submission of a grant application in the amount of \$6,826,547.20 to provide a portion of the required funding total of \$9,099,184.00 for the subject project;

BE IT FURTHER RESOLVED that, through the Tuscaloosa County Commission, \$2,272,636.80 will be provided in the form of local cash match for the proposed project and that the Commission Chairman, W. Hardy McCollum, is hereby authorized to execute any and all documents and related material, as required therein, to provide for the successful submission, approval and completion of the subject project.

Approved and adopted this the 1st day of May, 2013.

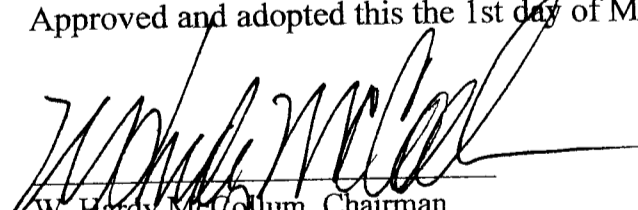
W. Hardy McCollum, Chairman
Tuscaloosa County Commission

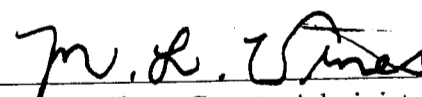
Attest: 
Melvin L. Vines, County Administrator
Tuscaloosa County Commission

SEAL

THIS INSTRUMENT PREPARED BY:
ELIZABETH S. GORDON
ROSEN HARWOOD P.A.
ATTORNEYS AT LAW
2200 Jack Warner Parkway,
Suite 200 (35401)
Post Office Box 2727
Tuscaloosa, Alabama 35403
(205) 344-5000

Sources of Title: Deed Book 1137 at Page 397

RESOLUTION AUTHORIZING THE VACATION OF A RIGHT-OF-WAY IN TUSCALOOSA COUNTY, ALABAMA

WHEREAS, the owner of the land abutting that certain right-of-way more particularly described in Exhibit "A," and depicted on Exhibit "B", said Exhibits being attached hereto and incorporated herein by reference, **Hinton-Puryear Partnership #2, LLP** (hereinafter referred to as the "Owner"), alleges it owns all of the land abutting said right-of-way, street, alley, or portion thereof requested to be vacated in Tuscaloosa County, Alabama; and,

WHEREAS, said right-of-way does not lie within the corporate limits of any municipality in Tuscaloosa County, but within the jurisdiction of Tuscaloosa County, Alabama, and the assent of the Tuscaloosa County Commission to the vacation of said right-of-way has been requested and is desired by the Owner; and,

WHEREAS, it appears to the Tuscaloosa County Commission, that the vacation of said right-of-way, as hereinafter described, will not deprive other property owners of their right to convenient and reasonable means of ingress and egress to and from their property, nor will it adversely affect the interest of the public in any way.

NOW, THEREFORE, be it resolved by the Tuscaloosa County Commission, Alabama, as follows:

1. That it is in the interest of the public that the right-of-way located in Tuscaloosa County, Alabama, as described in Exhibit "A" and depicted on Exhibit "B" hereto, be vacated.
2. That the assent of the Tuscaloosa County Commission is hereby given to the vacation of said right-of-way located in Tuscaloosa County, Alabama, as described in Exhibit "A" and

depicted on Exhibit "B" hereto. Pursuant to Alabama Code (1975) §23-4-2 and §23-4-20, upon the filing of this Resolution, title to said right-of-way as described in Exhibit "A" and depicted on Exhibit "B" shall vest in **Hinton-Puryear Partnership #2, LLP**.

3. That the Judge of Probate of Tuscaloosa County, Alabama, be, and is hereby, authorized to present a copy of this resolution, duly certified as correct by County Clerk, to the Owner in order that the same may be recorded in the Office of the Judge of Probate.

RESOLVED AND DONE this 1st day of May, 2013.

TUSCALOOSA COUNTY COMMISSION

By: 

W/ Hardy McCollum, Judge of Probate

ATTEST:

Melvin Vines, County Administrator

APPROVED THIS THE 1st DAY OF May, 2013.

NOTICE

A public hearing on the proposed vacations of the rights-of-way more particularly described below will be held on May 1, 2013 at 9:00 a.m. in the County Commission Chambers at the Tuscaloosa County Courthouse, 714 Greensboro Avenue, Tuscaloosa, Alabama 35401. Any citizen alleging to be affected by the proposed vacation may submit a written objection to the Tuscaloosa County Commission or may request an opportunity to be heard at the public hearing. The legal description of the right-of-way is as follows:

VACATION OF RIGHT-OF-WAY

A 50 foot right-of-way being 25 feet each side of the following described centerline:

To locate the point of beginning, commence at the southeast corner of Lot 1 of WH Capital's Addition to Tuscaloosa a map or plat which is recorded in plat book 2011 at page 56 in the office of the Judge of Probate of Tuscaloosa County, Alabama; thence in a northwesterly direction on the south boundary of said lot, a distance of 288.90 feet to the east right-of-way of Alabama Highway 69 and the SW corner of said lot; thence turn an angle right of $86^{\circ}10'00''$ and run in a southwesterly direction on said east right-of-way, on a curve to the left with a delta angle of $03^{\circ}48'05''$ and a radius of 10821.08 feet a chord distance of 717.83 feet to a point; thence turn an angle right of $132^{\circ}51'27''$ and run in a southeasterly direction a distance of 83.49 feet to a point on the north right-of-way of Bobby Miller Parkway; thence turn an angle right of $129^{\circ}23'10''$ and run in an easterly direction on said north right-of-way, a distance of 101.03 feet to the point of beginning of the herein described centerline; thence turn an angle right of $150^{\circ}23'59''$ and run in a northeasterly direction a distance of 53.75 feet to a point; thence run in a northeasterly direction on a curve to the right with a delta angle of $25^{\circ}50'14''$ and a radius of 100.00 feet a chord distance of 44.71 feet to a point; thence run in an easterly direction tangent to said curve, a distance of 63.87 feet to a point; thence run in an easterly direction on a curve to the right with a delta angle of $08^{\circ}29'43''$ and a radius of 200.00 feet a chord distance of 29.63 feet to a point; thence run in an easterly direction tangent to said curve, a distance of 317.44 feet to a point; thence run in a northeasterly direction on a curve to the left with a delta angle of $46^{\circ}33'06''$ and a radius of 100.00 feet a chord distance of 79.03 feet to a point; thence run in a northeasterly direction tangent to said curve, a distance of 96.10 feet to a point; thence run in an easterly direction on a curve to the right with a delta angle of $64^{\circ}52'13''$ and a radius of 150.00 feet a chord distance of 160.90 feet to a point; thence run in a southeasterly direction tangent to said curve, a distance of 146.05 feet to the point of ending of said centerline.

Said Right-of-way containing 1.15 acres.

STATE OF ALABAMA §

COUNTY OF TUSCALOOSA §

**PETITION FOR APPROVAL OF A
DECLARATION OF VACATION**

TO THE HONORABLE, W. HARDY McCOLLUM, Probate Judge of Tuscaloosa County and Chairman of the Tuscaloosa County Commission, and THE HONORABLE STAN ACKER, COMMISSIONER, THE HONORABLE JERRY TINGLE, COMMISSIONER, THE HONORABLE BOBBY MILLER, COMMISSIONER, AND THE HONORABLE REGINALD MURRAY, COMMISSIONER;

COMES NOW, Virginia P. Underwood and Tabitha Hinton Brown who presents unto your Honors:

THAT, Hinton-Percy Partnership #2 LP and no other, (hereinafter "the parties") are the owners of all the land abutting a portion of a road right-of-way located in Tuscaloosa County, Alabama which is described as:

SEE EXHIBIT "A" ATTACHED HERETO

THAT the parties desire to vacate a portion of the _____ Road, a public road, as provided in §23-4-20 of the Code of Alabama, 1975; and

THAT, the vacation of the portion of the said road as hereinafter described will not deprive other property owners of reasonable means of ingress and egress to and from their property nor will it adversely affect the interest of the public in any way; and

THAT, the portion of the road right-of-way to be vacated is within the County of Tuscaloosa and assent to the vacation of the right-of-way must be obtained from the Tuscaloosa County Commission pursuant to the provisions of §23-4-20 of the Code of Alabama, 1975;

NOW THEREFORE, in consideration of the premises, the parties do hereby request that your Honors assent to the vacation of the portion of the road right-of-way described on the Exhibit A which is attached hereto and made a part hereof by reference.

The parties further requests that your Honors authorize and direct the Chairman of the Tuscaloosa County Commission to present a resolution consenting to the vacation of the road right-of-way as above said, duly certified as correct by the Clerk of Tuscaloosa County, the officer in charge of the records of Tuscaloosa County, to the parties in order that said resolution may be attached to and filed and recorded with its legal Declaration of Vacation.

IN WITNESS WHEREOF, the parties have hereunto set their hand and seal on this the 28 day of February, 2013.

Virginia P. Underwood

John H. Underwood

EXHIBIT "A"

Right-of-Way Vacation

A 50 foot right-of-way being 25 feet each side of the following described centerline:

To locate the point of beginning, commence at the southeast corner of Lot 1 of WH Capital's Addition to Tuscaloosa a map or plat which is recorded in plat book 2011 at page 56 in the office of the Judge of Probate of Tuscaloosa County, Alabama; thence in a northwesterly direction on the south boundary of said lot, a distance of 288.90 feet to the east right-of-way of Alabama Highway 69 and the SW corner of said lot; thence turn an angle right of $86^{\circ}10'00''$ and run in a southwesterly direction on said east right-of-way, on a curve to the left with a delta angle of $03^{\circ}48'05''$ and a radius of 10821.08 feet a chord distance of 717.83 feet to a point; thence turn an angle right of $132^{\circ}51'27''$ and run in a southeasterly direction a distance of 83.49 feet to a point on the north right-of-way of Bobby Miller Parkway; thence turn an angle right of $129^{\circ}23'10''$ and run in an easterly direction on said north right-of-way, a distance of 101.03 feet to the point of beginning of the herein described centerline; thence turn an angle right of $150^{\circ}23'59''$ and run in a northeasterly direction a distance of 53.75 feet to a point; thence run in a northeasterly direction on a curve to the right with a delta angle of $25^{\circ}50'14''$ and a radius of 100.00 feet a chord distance of 44.71 feet to a point; thence run in an easterly direction tangent to said curve, a distance of 63.87 feet to a point; thence run in an easterly direction on a curve to the right with a delta angle of $08^{\circ}29'43''$ and a radius of 200.00 feet a chord distance of 29.63 feet to a point; thence run in an easterly direction tangent to said curve, a distance of 317.44 feet to a point; thence run in a northeasterly direction on a curve to the left with a delta angle of $46^{\circ}33'06''$ and a radius of 100.00 feet a chord distance of 79.03 feet to a point; thence run in a northeasterly direction tangent to said curve, a distance of 96.10 feet to a point; thence run in an easterly direction on a curve to the right with a delta angle of $64^{\circ}52'13''$ and a radius of 150.00 feet a chord distance of 160.90 feet to a point; thence run in a southeasterly direction tangent to said curve, a distance of 146.05 feet to the point of ending of said centerline.

Said Right-of-way containing 1.15 acres.

LEGEND

- ▲ Capped rebar Set (Almon Associates)
- Iron Pipe / Pin Found
- P.O.C. Point of Commencement
- P.O.B. Point of Beginning
- P.O.E. Point of Ending

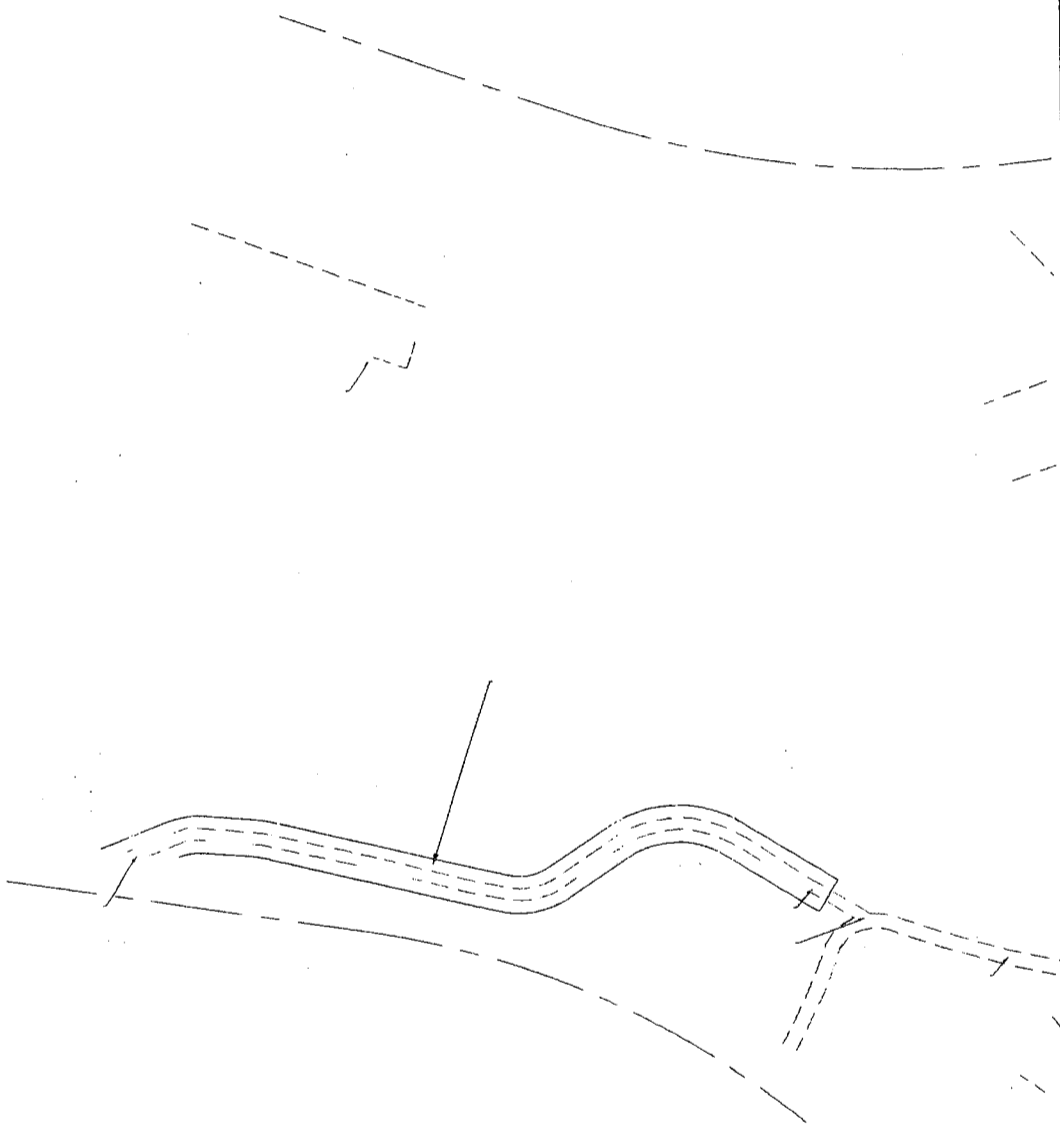
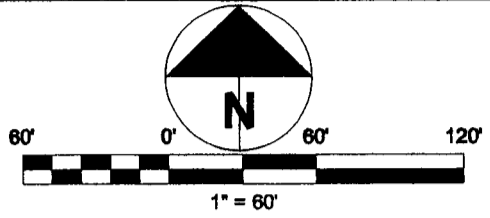

General Notes:

1. This survey and drawing was completed without benefit of a title search or opinion. Therefore there may be easements and rights-of-ways which are not shown on this drawing.
2. There was no request for or attempt made to locate or show any sub-surface features or utilities of the time of this survey.
3. The survey shown on this drawing is intended to be used in the situation of this existing level road. NO OTHER USE IS INTENDED OR GUARANTEED.

I HEREBY CERTIFY THAT ALL PARTS OF THIS SURVEY AND DRAWING HAVE BEEN COMPLETED IN ACCORDANCE WITH THE CURRENT REQUIREMENTS OF THE BOARD OF PRACTICE FOR SURVEYORS OF THE STATE OF ALABAMA TO THE BEST OF MY KNOWLEDGE, SKILL AND BELIEF.

SURVEYOR'S SIGNATURE

ALMON ASSOCIATES, INC. LICENSE NO. 34283

Right of Way Vacation

NO OTHER USE IS INTENDED OR GUARANTEED

DATE	REVISION
FIELD BOOK	NO
DATE FILE	NOV 20 2008
DRAWN BY	K.J.J. DATE 08 28 12
CHECKED BY	LOG NO. 2012-007





OFFICE OF THE SUPERINTENDENT

April 29, 2013

Commissioner Stan Acker
Tuscaloosa County Commission
714 Greensboro Avenue
Tuscaloosa, AL 35401

Re: Paving and Striping of two Parking Lots at the New Central Office

Dear Commissioner Acker:

For your information and consideration, Mr. Dan Butler, Interim Superintendent, and Mr. Gary Bonner, Board President, are requesting assistance from the Tuscaloosa County Commission with paving and striping of two parking lots at the new Central Office.

We greatly appreciate your consideration of this project. Thank you for all you do for the students in the Tuscaloosa County School System.

Sincerely,

Dan B. Butler
Interim Superintendent of Education

Gary Bonner
Board President

Cc: Commission Chair and Judge of Probate W. Hardy McCollum
Commissioner Bobby Miller
Commissioner Reginald Murray
Commissioner Jerry Tingle

STATE OF ALABAMA §

TUSCALOOSA COUNTY §

**RESOLUTION ACCEPTING PRELIMINARY PLAT
STEARMAN SURVEY**

WHEREAS, the County Engineer has reported to the Tuscaloosa County Commission that the developer has complied with all Tuscaloosa County Subdivision related to the preparation and presentation of a preliminary plat for a new development or the extension of an existing development; and

WHEREAS, the Tuscaloosa County Commission has been presented with the preliminary plat and accompanying information, and determines that there is no just reason to withhold approval of the preliminary plat.

NOW, THEREFORE, IT BE RESOLVED BY THE TUSCALOOSA COUNTY COMMISSION that the preliminary plat recommended for approval by the Tuscaloosa County Engineer is approved and accepted

Approved and accepted at our regularly scheduled meeting on this the 1st day of May, 2013

W. Hardy McCollum, Chairman
Tuscaloosa County Commission

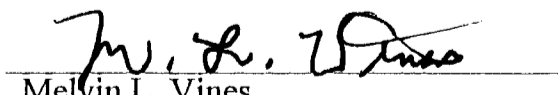
Melvin L. Vines
County Administrator